

Housing For All by 2022 – DPR – 2017-2018

Under Pradhan Mantri Awas Yojana (PMAY): Urban



Prepared By

**Municipal Engineering Directorate
Department of Municipal Affairs
Government of West Bengal
Beneficiary Led Construction**

Rishra Municipality

DISTRICT HOOGHLY

WEST BENGAL

**DPR SCRUTINY REPORT FOR THE PROJECT UNDER AFFORDABLE HOUSING IN PARTNERSHIP
(AHP) COMPONENT OF PRADHANMANTRI AWAS YOJANA (PMAY)**

NAME OF SCRUTINY AGENCY :

**SCRUTINY REPORT (BASED ON FORMAT NO 7C) FOR THE PROJECTS UNDER
BENEFICIARIES LED INDIVIDUAL HOUSE CONSTRUCTION/ENHANCEMENT COMPONENT OF
PRADHANMANTRI AWAS YOJANA (PMAY)**

REFERENCE NO. :

DATE:

BASIC INFORMATION:			
1	NAME OF THE STATE	:	WEST BENGAL
2	NAME OF THE CITY	:	RISHRA MUNICIPALITY
3	PROJECT NAME	:	HOUSING FOR ALL
4	PROJECT CODE	:	
5	IMPLEMENTING AGENCY	:	ULB
6	i) APPROVED PROJECT COST (Rs. IN LAKHS)	:	7453.51
	ii) GOI GRANT REQUESTED (Rs. IN LAKHS)	:	2763
	iii) STATE GRANT (Rs. IN LAKHS)	:	3891.23
	iv) ULB/IMPLEMENTING AGENCY SHARE (Rs. IN LAKHS)	:	338.79
	v) BENEFICIARY SHARE (Rs. IN LAKHS)	:	460.5
	vi) OTHERS, IF ANY (Rs. IN LAKHS)	:	
7	PROJECT DURATION (IN MONTHS)	:	06 Months
8	NO OF ELIGIBLE BENEFICIARIES FOR GOI GRANT	:	1842
	i) NO OF BENEFICIARIES (NEW CONSTRUCTION)	:	1842
	ii) NO OF BENEFICIARIES (ENHANCEMENT)	:	0
9	ELIGIBLE GOI GRANT (Rs. 1.5 LAKHS PER ELIGIBLE BENEFICIARY) (Rs. IN LAKHS)	:	2763
10	DISCREPANCY IF ANY (w.r.t. ITEM NO 6(ii) AND 9)	:	NIL
ADMINISTRATIVE DETAILS			
11	WHETHER THE PROJECT IS PART OF ANNUAL IMPLEMENTATION PLAN(AIP)	:	YES
12	DATE OF SLSMC APPROVAL FOR THE PROJECT	:	
13	WHETHER THE FORMAT AS PER ANNEXURE 7C OF PMAY SCHEME GUIDELINES HAS BEEN SIGNED BY THE COMPETENT AUTHORITIES?	:	yes
TECHNICAL DETAILS			
14	WHETHER BUILDING PLANS FOR ALL HOUSES HAVE BEEN APPROVED?	:	yes
15	WHETHER TECHNICAL SPECIFICATION / DESIGN OF HOUSING HAVE BEEN ENSURED AS PER INDIAN STANDARDS /NBC/STATE NORMS	:	yes
16	WHETHER DISASTER (EARTHQUAKE, FLOOD, CYCLONE, LANDSLIDE ETC.) RESISTANT FEATURES HAVE BEEN ADOPTED IN CONCEPT DESIGN AND IMPLEMENTATION OF THE PROJECT? PLEASE SPECIFY.	:	yes
17	WHETHER THE DETAILED PROJECT REPORT (DPR) HAS BEEN SCRUTINISED CENTRAL AGENCY? IF YES, ATTACH THE DPR SCRUTINY REPORT(ANNEXURE C)	:	NO
18	ANY OTHER INFORMATION (PLEASE SPECIFY)	:	

OBSERVATIONS OF THE SCRUTINY AGENCY:

1

2

3

Abbreviations

A&OE	Administrative and Other Expenses	LIG	Low Income Group
AHP	Affordable Housing in Partnership	MD	Mission Directorate
AIP	Annual Implementation Plan	MoA	Memorandum of Agreement
BMTPC	Building Materials & Technology Promotion Council	MoHUPA	Ministry of Housing and Urban Poverty Alleviation
CDP	City Development Plan	MoU	Memorandum of Understanding
CLS	Credit linked subsidy	NA	Non Agricultural
CNA	Central Nodal Agencies	NBC	National Building Code
CPHEEO	Central Public Health and Environmental Engineering Organisation	NHB	National Housing Bank
CSMC	Central Sanctioning and Monitoring Committee	NOC	No Objection Certificate
DIPP	Department of Industrial Policy and Promotion	NPV	Net Present Value
DPR	Detailed Project Report	PLI	Primary Lending Institution
EMI	Equated Monthly Installment	RWA	Residents' Welfare Association
EWS	Economically Weaker Section	SECC	Socio Economic and Caste Census
FAR	Floor Area Ratio	HFAPoA	Slum Free City Plan of Action

FSI	Floor Space Index	SLAC	State Level Appraisal Committee
HFA	Housing for All	SLNA	State Level Nodal Agency
HFAPoA	Housing for All Plan of Action	SLSMC	State Level Sanction and Monitoring Committee
IEC	Information Education & Communication	TDR	Transfer of Development Rights
IFD	Integrated Finance Division	TPQMA	Third Party Quality Monitoring Agency
IIT	Indian Institute of Technology	ULB	Urban Local Boday
IS	Indian Standard	UT	Union Territory

Introductory Note By The Chairman



When the Municipality has designed to take up one and only agendum, that is, augmenting the basic amenities of urban life to economically backward segments of the urban population and to give a kinetic direction and momentum thrust to the same, in the second phase of work (2017-18) 1842 nos dwelling units in different slums situated in different wards have been selected as the slums are inhabited with the people of down trodden classes of the society who are in need of shelters and infrastructural development to make connectivity in between the wards and gradually overall development of the town and alleviation of the urban poverty by way of creating employment to the urban poor and deprived for their financial upliftment let us tie hand with us to usher in a new era of development of the Urban area.

Chairman
Rishra Municipality
Chairman
Rishra Municipality.

PREFACE

Pradhan Mantri Awas Yojana (PMAY) aims at Providing Housing for All (HFA) by 2022 when the Nation Complete 75 years of its independence.

The urban homeless persons contribute to the economy of the cities and thus the Nation as cheap labour in the informal sector; yet they live with no shelter or social security . The urban homeless service with many challenges like no access to elementary Public Services such as health, education, food, water and sanitation. Pradhan Mantri Awas Yojana (PMAY) also aims at providing a pucca house to every family with water connection, toilet facilities, 24 X 7 electricity supply and access.

The Mission seeks to address the housing requirement of urban poor including slum dwellers through “In Situ” Slum Redevelopment, Affordable Housing through credit linked subsidy, Affordable Housing in partnership and subsidy for beneficiary led individual house. Under the mission, beneficiaries can take advantage under one component only.

Total beneficiaries of the scheme are 1842 nos from 40 nos slum projected for the year 2017-18 .

Total cost of the project is **Rs. 7453.51 lakhs** as per relevant department & P.W.D. schedule of rates.

HFAPoA and Pradhan Mantri Awas Yojana (Housing for All)

To give pucca house for every family is currently on the global agenda. One of the Millennium Development Goals (MDGs) is to 'achieve significant improvement in the lives of slum dwellers, by 2022'. Similar goals are set forth by Pradhan Mantri Awas Yojana within year 2022, to create pucca house for every family.

ULB undertake a demand survey through suitable means for assessing the actual demand of housing. While validating demand survey, Cities consider possible temporary migration from rural areas to the city just to take advantage of housing scheme and exclude such migrants from list of beneficiaries. On the basis of demand survey and other available data, cities prepare Housing for All Plan of Action (HFAPoA). HFAPoA contain the demand of housing by eligible beneficiaries in the city along with the interventions selected out of four verticals. The information regarding beneficiaries is collected by ULB in suitable. While preparing HFAPoA, ULB and Implementing Agencies also consider the affordable housing stock already available in the city as Census data suggests that large numbers of houses are vacant.

Bank account number and Aadhaar number/Voter ID card/any other unique identification details of intended beneficiaries or a certificate of house ownership from Revenue Authority of beneficiary's native district integrate in the data base of HFAPoA for avoiding duplication of benefit to one individual family. Beneficiaries are validated by ULBs thereby ensuring their eligibility at the time of preparation of the projects and approval of projects.

On the basis of HFAPoA, States/Cities subsequently prepare the Annual Implementation Plans (AIPs) dividing the task upto 2022 in view of the availability of resources and priority. For larger cities, HFAPoA and AIPs is prepared at sub-city (ward/zone etc.) level with the approval of concerned State/UT Government. The result of demand survey, draft HFAPoA and draft AIP is discussed with the local representatives including MLAs and MPs of that area so that their views are adequately factored in while finalizing the plans and beneficiary list.

Cities which have already prepared Slum Free City Plan of Action (SFCPoA) or any other housing plan with data on housing, utilize the existing plan and data for preparing "Housing for All Plan of Action" (HFAPoA). Houses constructed under various schemes should be accounted for while preparing HFAPoA

Urban Population Living in Slums and the Indian Scenario (source: UN-HABITAT)

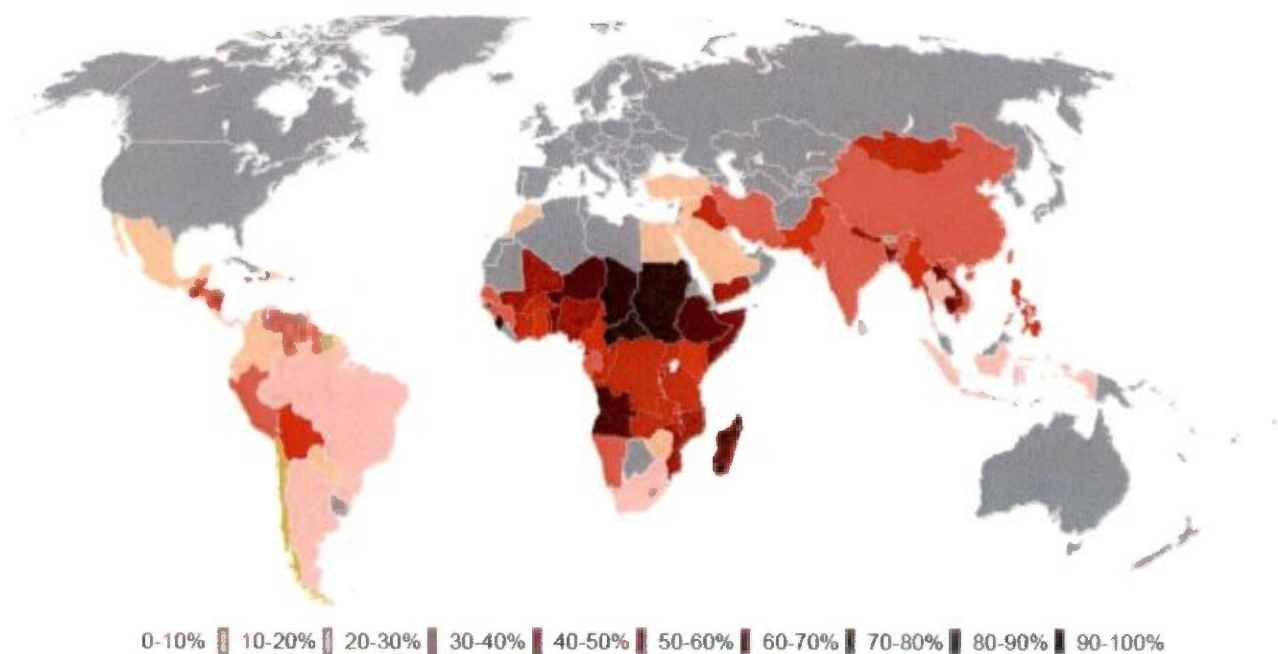

The preparation of HFAPoA broadly involve Slum Development/Rehabilitation Plans based on

- a. Survey of all slums – notified and non-notified;
 - b. Mapping of slums using the state-of-art technology;
 - c. Integration of geo-spatial and socio-economic data; and
 - d. Identification of development model proposed for each slum.
-
1. Base maps to an appropriate scale would be a pre-requisite for the preparation of Slum Development Plan/Slum-free City Plan. States/UTs may need to proceed in the following steps for the preparation of Slum-free City Plans.
 2. Securing CARTOSAT II/latest satellite images from NRSC/ISRO and preparation of base maps for the whole city and its fringes using the images;
 3. Identification and inventory of all slum clusters of all descriptions in the urban agglomeration with the help of satellite image and other available data;
 4. Inventory of all possible vacant lands in each zone of the urban agglomeration that could be
used for slum development/ rehabilitation development purposes;
 5. Development of Slum Map of every slum within the city and its fringes using GIS with CARTOSAT II images, ground level spatial data collected through total station survey, collating spatial information with respect to plot boundaries, network of basic infrastructure like roads, sewerage, storm drainage and water lines, etc and superimposing this on the satellite image and importing them into GIS platform as the first step towards the preparation of Slum Development Plans and Slum Free City Plan.
 6. This may be undertaken with the help of technical partners of NRSC/ ISRO/other technical institutions.
 7. Identification and engagement of Lead NGO/CBO to guide and anchor community mobilization for the purpose of slum survey, (May be more than one NGO/CBO in different slum zones) of the city. These Lead NGOs/CBOs should also be associated in slum survey operations and dialogues for preparation of slum level development plans;
 8. Conduct of Slum Survey based on the detailed formats (with or without changes)

prepared by the Ministry of Housing & Urban Poverty Alleviation with the help of National Buildings Organization (NBO) - after due training of trainers, training of survey personnel /canners and canvassing. It would be helpful for community mobilization to pick as many canners from the sourced slum or nearby slum pockets;

9. Collection of bio-metric identification data of slum dwellers based on the above survey (subject to guidelines issued by Unique Identity Authority of India (UIDAI));

10. Entry of data from Slum Surveys in the web-enabled MIS application (to be provided by Ministry of HUPA), compilation and collation of data, preparation of Slum-wise, City and State Slum Survey Database and Baseline Reports. The MIS will assist in developing a robust Slum and Slum Households Information System. (Guidelines and software for development of the MIS will be issued by the Ministry of HUPA);

11. Integration of Slum MIS with GIS Maps to enable the preparation of GIS-enabled

Slum Information System that is to be used for the preparation of meaningful Slum Development Plans and Slum-free City Plan using a city-wide/zone-based approach.(Guidelines and software for development of GIS platform and its integration with the MIS will be issued by the Ministry of HUPA);

Introduction to Pradhan Mantri Awas Yojana (PMAY)

Pradhan Mantri Awas Yojana (PMAY), a path breaking scheme for the slum dwellers and urban poor envisages a 'Pucca house to every family' through encouraging States to tackle the problem of slums in a holistic manner. It calls for a multi-pronged approach focusing on:

- ☐ Bringing existing slums within the formal system and enabling them to avail of the same level of basic amenities as the rest of the town.
- ☐ Redressing the failures of the formal system that lie behind the creation of slums.

- ☐ Tackling the shortages of urban land and housing that keep shelter out of reach of the urban poor and force them to resort to extra-legal solutions in a bid to retain their sources of livelihood and employment.

- Enactment of a set of reforms at the state and city level related to inclusive planning, regulation and financing, which would ensure that adequate fresh housing stock and services get created on an ongoing basis to address both current and future needs of cities.
- An integrated approach covering shelter, services and livelihoods for poor slum communities.

The duration of Pradhan Mantri Awas Yojana [PMAY]

2015 TO 2022

Eligible Components of the PMAY:

Allotment of Houses

Allotment of dwelling units will be in the name of the female member of the . Alternatively, it can be allotted in the name of husband and wife jointly. Ownership of land required for every Beneficiary.

A EWS beneficiary family will comprise husband, wife and unmarried children.

The beneficiary family should not own a pucca house (an all weather dwelling unit) either in his/her name or in the name of any member of his/her family in any part of India to be eligible to receive central assistance under the mission.

EWS households are defined as households having an annual income up to Rs.3,00,000 (Rupees Three Lakhs). States/UTs shall have the flexibility to redefine the annual income criteria as per local conditions in consultation with the Centre.

Following infrastructure will be considered for support under PMAY:

1. Water connection
2. Toilet facilities
3. 24 x 7 Electric facilities
4. Roads

Need for Projects

This development project models will give benefits in the city . One of the key objectives of developing the Projects is to incentivize innovation and encourage new approaches and solutions that can demonstrably improve the quality and quantity of shelter and services for the poor.

Such innovation could encompass:

- ☐ Projects with strong community participation i.e. Slum upgradation/ redevelopment projects initiated/spearheaded by the community; or with their demonstrable involvement and participation in design, planning and implementation
- ☐ New models of public-private partnerships whereby the private sector can be encouraged to take up affordable housing for the EWS/LIG.
- ☐ Innovations in planning, demonstrating integrated livelihoods, shelter and services; or convergence.
- ☐ Innovative or cost effective and green building design and technologies.
- ☐ Financial innovations in delivering the city/state wide programme.

Aims and Objectives

Vision

The mission seeks to address the housing requirement of urban poor including slum dwellers through following programme verticals:

- Slum rehabilitation of Slum Dwellers with participation of private developers using land as a resource
- Promotion of Affordable Housing for weaker section through credit linked subsidy
- Affordable Housing in Partnership with Public & Private sectors
- Subsidy for beneficiary-led individual house construction

Objectives

The project has been designed keeping in mind the following objectives.

- ☐ Integrated development of all existing slums, notified or non-notified, i.e., development of infrastructure and housing in the slums/rehabilitation colonies for the slum dwellers/urban poor, including rental housing.
- ☐ Development/improvement/maintenance of basic services to the urban poor, including water supply, sewerage, drainage, solid waste management, approach and internal road, street lighting.
- ☐ The Creation of affordable housing stock, including rental housing with the provision of civic infrastructure and services, on ownership.
- ☐ Encouraging Public Private Partnership by having pay and use toilets and educate the slum dwellers for keeping the environment clean and hygienic.

State PMAY Mission Director

The Nodal Ministry and National Mission Directorate is Ministry of Housing & Urban Poverty Alleviation, Government of India.

The Nodal Department for West Bengal is Municipal Affairs Dept. (M.A. Department), Government of West Bengal. The state level Nodal Agency is State Urban Development Agency (SUDA) under M.A. Department. State Urban Development Agency was set up in 1991 with a view to ensuring proper implementation and monitoring of the centrally assisted programmes for generating employment opportunities and alleviation of poverty throughout the State. SUDA is a Society registered under the West Bengal Societies Registration Act, 1961.

Funding Pattern of PMAY

Funding pattern for PMAY(Housing for all)

- ☐ Central share 1.5 LAKHS of total cost of dwelling unit
- ☐ Beneficiary share 0.25 LAKHS of total cost of dwelling unit
- ☐ State share rest of total cost of dwelling unit
- ☐ State + ULB bear the cost of infrastructure
- ☐ State share for infrastructure to be minimum 50%
- ☐ ULB share for infrastructure to be minimum 50%

- Cost of infrastructure 10 % of sum total cost of dwelling unit

Approvals & Release of Funds

- Releases and approvals to be on the basis of DPRs which need to be submitted with approval of State Level Sanctioning and Monitoring Committee
- Innovative projects to be considered for sanction even in the preparatory stage.
- Central Funds to be released in three installments to the State Governments/SLNA; central assistance under different components will be released to the state / UTs after the approval of CSMC and with concurrence of the integrated Financial Division of the Ministry. Central share would be released in three installment of 40%, 40% and 20% each.

Project Cost and Financing Strategy

For Dwelling Unit

Total no of Dwelling unit = 1842 Nos

Rate per Dwelling unit = 3.68 Lakhs

Total Cost of Dwelling unit = $1842 \times 3.68 = 6775.94$ Lakhs

Central Share = 1842×1.5 Lakhs = 2763 Lakhs

State Share = 1842×1.93 Lakhs = 3552.44 Lakhs

Beneficiary Share = 1842×0.25 Lakhs = 460.5 Lakhs

ULB Share = NIL

For Infrastructure

10 % of total Dwelling unit cost = $6775.94 \text{ Lakhs} \times 10\% = 677.59$ Lakhs

Central Share = NIL

State Share = $50\% \times 677.59$ Lakhs = 338.79 Lakhs

Beneficiary Share = NIL

ULB Share = $50\% \times 677.59$ Lakhs = 338.79 Lakhs

The total project cost will be 74.54 crores

Out of these 67.76 Crores is the cost of Housing Infrastructure. The following table shows the share of cost between housing infrastructure & Physical Infrastructure.

Table: Cost Break up between Housing & Infrastructure

SINo.	Component	Cost on Lakhs
1.	Housing Cost(2022) Dwelling Units)	6775.94
2.	Infrastructure Cost	677.59
	Total	7453.51

Materials of construction:

- ☐ PCC (1:3:6) for foundation
- ☐ RCC M-20 for substructure & superstructure (Column, Beam, Slab)
- ☐ HYSD Steel
- ☐ 1st Class Brick Masonry
- ☐ 1:6 (Cement: Sand) plaster – 10 mm on soffit of beam & slab, 15 mm on internal walls & 20 mm on external walls
- ☐ IPS flooring

Definition of Slum for Housing

Different definitions of a slum exist in different statutes and in urban poverty literature. For the purpose of HOUSING SCHEME, it is proposed to adopt the definition given in the 2001 Census, which is as follows:

- a. All areas notified as 'Slum' by State/Local Government and UT Administration under any Act;
- b. All areas recognized as 'Slum' by State/Local Government and UT Administration, which have not been formally notified as slum under any Act;

‘Slum’ or ‘Slum Area’– is a compact settlement of at least 20 households (For NE & Special Category States it is 10-15 households) with a collection of poorly built tenements, mostly of temporary nature, crowded together usually with inadequate sanitary and drinking water facilities in unhygienic conditions.

Situation Appraisal

The people living in the slums mostly have kutcha (995) and semi-pucca (847) housing. In certain cases where pucca housing is available, they are usually in dilapidated condition. The kutcha

houses are in very poor condition and require extensive repairs. Most of the houses have tiles on roof. While during the survey some of the houses have been noted to be in average condition, the quality of these houses is also speedily deteriorating.

Proposed Intervention

In line with the vision to 'housing for all', an integrated housing programme is proposed to be implemented. The target will be all the slum /Non Slum dwellers in the pocket.

Building Plan

The buildings are proposed to cover an area of approximate 32 Sq.mt along with provision of 2 rooms, kitchen and sanitation facility. The layout, size and type design of housing dwelling units depends on the local conditions and the preferences of the beneficiary. The houses, has been designed in accordance with the desire of the beneficiaries, keeping in view the climatic conditions and the need to provide ample space, kitchen, ventilation, sanitary facilities, etc. and the community perceptions, preferences and cultural attitudes.

In line with the scheme, carpet area of the house will be not less than 25 sq. mts and preferably two room accommodation plus kitchen and toilet should be constructed.

Compliance with Municipal Bye laws

All designs & drawings are created keeping in line with the municipal bye laws.

Building material

- ☐ PCC (1:3:6) for foundation
- ☐ RCC M-20 for substructure & superstructure (Column, Beam, Slab)
- ☐ HYSD Steel
- ☐ 1st class Brick Masonry
- ☐ 1:6 (Cement: Sand) plaster – 10 mm on soffit of beam & slab, 15 mm on internal walls & 20 mm on external walls
- ☐ IPS flooring

Structural Design

- ☐ Following are the general considerations in the analysis/design.
- ☐ For all structural elements, M20 grade concrete and Fe 415 grade of steel is used.
- ☐ Plinth beams passing through columns are provided as tie beams.

- ☐ Pedestals are proposed up to ground level.
- ☐ Beam Centre-line dimensions are followed for analysis and design.
- ☐ For all the building, walls of 250 mm and 125mm thick with 20 mm External plaster and 12 mm thick internal plaster are considered.
- ☐ Seismic loads are considered acting in the horizontal direction along either of the two principal directions.

Design data

- ☐ Live load: 2.0 kN/m² at typical floor
- ☐ 1.5 kN/m² on terrace (With Access) : 0.75 kN/m² on terrace (without Access)
- ☐ Floor finish 50mm (0.05*24) = : 1.2 kN/m²
- ☐ Ceiling plaster 12mm (0.012*20.8) : 0.25 kN/m²
- ☐ Partition walls (Wherever Necessary) : 1.0 kN/m²
- ☐ Terrace finish: 1.5 kN/m²
- ☐ Earthquake load: As per IS-1893 (Part 1) - 2002
- ☐ Depth of foundation below ground: ,0.7 m
- ☐ Walls: 250 mm thick brick masonry walls at external and 125mm walls internal.

Reference codes:

- ☐ IS 456: 2000 - Code of practice -Plain and Reinforced concrete.
- ☐ IS :1893 :2002 - Criteria for Earthquake resistant design of structures(Part-1)
- ☐ IS: 13920: 1993 - Ductile detailing of Reinforced concrete structures subjected to seismic forces.
- ☐ SP: 34 - Hand Book on Concrete Reinforcement and Detailing.
- ☐ S: 875: 1987 - Code of practice for design loads (other than earthquake) for buildings and structures. (Part-2)

1.3. City Profile and Overview

Rishra is located in Eastern India at in the Ganges Delta at an elevation ranging between 1.5m to 9m. It is spread linearly along the banks of the River Hooghly in a North – South direction. Much of the town was originally a vast wetland, reclaimed over the decades to accommodate the town's burgeoning population. The Sunderban National Park separates the town from the Bay of Bengal, which is located about 154 KM to south.

Like most of the Indo – Gangetic plains, the predominant soil type is alluvial. Quaternary sediments consisting of clay, silt, various grades of sand and gravel underlie the town of Rishra. These sediments are sandwiched between two clay beds, the lower one at depths between 250 and 650m and the upper one ranging between 10 and 40m in thickness. According to the Bureau of Indian standards, the town falls under Seismic Zone III, in a scale of I to V (in order to increasing proneness to earth quakes) while the wind and cyclone zoning is "very high damage risk", according to UNDP report.

Rishra Municipality is surrounded by Serampore Municipality in north, Konnagar Municipality in south, River Hooghly in the east and Nabagram, Rishra and Rajyadharpur gram Panchayat in the west.

Rishra has a tropical climate. The annual mean temperature is 26.8.⁰C (80⁰F); monthly mean temperature ranges from 19⁰C to 30⁰C (67⁰F to 86⁰ F), summers are hot and humid and maximum temperature often exceeds 40⁰C (104⁰ F) during May and June. Winter tends to last for only two and a half months, with seasonal lows dipping to 12⁰ C to 14⁰C between December and January. The highest recorded temperature is 43 ⁰C (111⁰F) and the lowest is 5 ⁰C (41 ⁰F). Often during the early summer, dusty squalls followed by spells of thunder storm and heavy rain lashes the city, bringing relief from the humid heat. These thunder storms are locally known as KalBaishakhi (Norwesters).

Rishra is one of the industrial units, and has India's largest jute product manufacturing hub in the periphery of its municipal limits. There are also a number of engineering and manufacturing firms and industries. The Jute mills are mainly located in the banks of river Hooghly. There are other industrial units dealing in the production and processing of chemicals, paints, textiles, steel/iron products etc.

Table 1: Population of Rishra Municipality

Sl. No.	Item	Rishra
1	Total population (Census 2011)	124527
2	Decadal Growth (Census 2011) (%)	9.95
3	Density	19225

Source: Census of India, 2011

Table 1 : City at a Glance

Sl.no	Indicator	2001	2011	2015
1	Area (inSqKm)			
1.1	Planning Area (Sq. Km)	6.48	6.48	6.48
1.2	Municipal Area (Sq. Km)	6.48	6.48	6.48
1.3	Area of Slums(Sq. Km)	4.38	4.38	4.38
2	Number of Municipal Wards	23	23	23
3	PopulationandHouseholds			
3.1	TotalPopulation (no'sinmillions)	113259	124527	129483
3.2	Number of Households	27194	30069	31290
3.3	Density of Population	17478	19217	19982
3.4	Slum households as percentage of total Households in city	44.77	44.78	44.79
3.5	Current (2015) Population(Year of Survey) (no'sinmillions)			129483
3.6	Current Number (2015) of Households(Year of survey)			31290
3.7	Slum populationaspercentageof totalpopulationincity	49.49		

Total list of Slum for 2015-2022

Sl.No	Slum Code No	Name of the Slum	Ward No	Area of Slum (in sq. M.)
1	1	RISHRA BUSTEE(1)	1	25000
2	2	RISHRA BUSTEE(2)	2	100000
3	3	RISHRA BUSTEE(3)	3	220000
4	4	RISHRA BUSTEE(4)	4	300000
5	43	NAWAZ REJINA NAGAR	4	2007
6	5	RISHRA BUSTEE(5)	5	30000
7	6	RISHRA BUSTEE(6)	6	40000
8	7	RISHRA BUSTEE(7)	7	150000
9	8	B.L.MUKHERJEE AND B.D. BANERJEE BYE LANE	8	10000
10	44	CHANDI CHARAN BANERJEE LANE	8	1000
11	9	S.D.MUKHERJEE AND N.S. ROAD	9	120000
12	10	K.B.SAHA ROAD AND N.S. ROAD	10	120000
13	11	N.K. BANERJEE STREET	11	20000
14	12	R.B.C. ROAD	11	40000
15	13	BEHIND LORETO SCHOOL	11	20000
16	14	K.C.DEY	12	20000
17	28	PANCHANANTOLLA	12	20000
18	38	D.D.HAR LANE	12	80000
19	39	SITALATOLLA	12	20000
20	45	SASTITOLLA	12	10000
21	15	BIRINCHIPARA	13	20000
22	17	BEHIND RISHRA HIGH SCHOOL	14	50000
23	18	BEHIND BURNING GHAT	14	30000

24	19	HARIPODDAR LANE	14	90000
25	20	BEHIND PREMMANDIR (BRAHMATOLLA)	14	60000
26	21	BAGKHAL BRICK FIELD	14	80000
27	22	BAGKHAL	15	70000
28	23	MOREPUKUR 1ST LANE	16	10000
29	24	DASPARA	16	10000
30	25	ANUBHAVA ASSEMBLY HALL	16	10000
31	26	SADHANKANAN	16	15000
32	27	KISHORE SANGHA	17	20000
33	34	NAYABUSTEE	18	30000
34	29	NAYABUSTEE	19	250000
35	30	HARIR MATH & NITYANANDA PALLY	20	150000
36	31	NATUNGRAM PRIMARY SCHOOL	20	70000
37	33	HOTELWALA GOLI	20	30000
38	46	AAM BAGAN	20	1000
39	47	BURMANPARA	20	1000
40	48	BALAKSANGHA MATH	20	1000
41	32	SUBHASH NAGAR	21	250000
42	35	NABINPALLY	22	320000
43	16	SUBHASHNAGAR RAILPARK	22	70000
44	40	LUXMIPALLY	22	400000
45	41	SUBHASHNAGAR GOVT. COLONEY BACK SIDE OF	22	10000

		WBSEB		
46	36	PALTEPARA	23	50000
47	37	BAGPARA	23	80000

List of Slum/Non Slum for 2017-18

Sl.No	Name of the Slums	Status	Land	Age in years	National High Way	Status of Housings	Road Status	Habitation pattern
1	RISHRA BUSTEE(4)	The condition of living in the slum is unhygienic	Land belongs to the Beneficiary	50	The National Highway NH-36 – 0.3 kms away	Major population is living in huts, made of darma / bricks with tin sheets and asbestos/tiles on roof	Majority portion of roads are brick paved or damaged roads.	Habitation pattern in the slums is congested with insufficient open space
2	RISHRA BUSTEE(5)	The condition of living in the slum is unhygienic	Land belongs to the Beneficiary	50	The National Highway NH-36 – 0.3 kms away	Major population is living in huts, made of darma / bricks with tin sheets and asbestos/tiles on roof	Majority portion of roads are brick paved or damaged roads.	Habitation pattern in the slums is congested with insufficient open space
3	RISHRA BUSTEE(6)	The condition of living in the slum is unhygienic	Land belongs to the Beneficiary	50	The National Highway NH-36 – 0.3 kms away	Major population is living in huts, made of darma / bricks with tin sheets and asbestos/tiles on roof	Majority portion of roads are brick paved or damaged roads.	Habitation pattern in the slums is congested with insufficient open space
4	RISHRA BUSTEE(7)	The condition of living in the slum is unhygienic	Land belongs to the Beneficiary	50	The National Highway NH-36 – 0.3 kms away	Major population is living in huts, made of darma / bricks with tin sheets and asbestos/tiles on roof	Majority portion of roads are brick paved or damaged roads.	Habitation pattern in the slums is congested with insufficient open space
5	B.L.MUKHERJEE AND B.D. BANERJEE BYE LANE	The condition of living in the slum is unhygienic	Land belongs to the Beneficiary	50	The National Highway NH-36 – 0.3 kms away	Major population is living in huts, made of darma / bricks with tin sheets and asbestos/tiles on roof	Majority portion of roads are brick paved or damaged roads.	Habitation pattern in the slums is congested with insufficient open space
6	CHANDI CHARAN BANERJEE LANE	The condition of living in the slum is unhygienic	Land belongs to the Beneficiary	50	The National Highway NH-36 – 0.3 kms away	Major population is living in huts, made of darma / bricks with tin sheets and asbestos/tiles on roof	Majority portion of roads are brick paved or damaged roads.	Habitation pattern in the slums is congested with insufficient open space

7	S.D.MUKHERJEE AND N.S. ROAD	The condition of living in the slum is unhygienic	Land belongs to the Beneficiary	40	The National Highway NH-36 – 0.3 kms away	Major population is living in huts, made of darma / bricks with tin sheets and asbestos/tiles on roof	Majority portion of roads are brick paved or damaged roads.	Habitation pattern in the slums is congested with insufficient open space
8	K.B.SAHA ROAD AND N.S. ROAD	The condition of living in the slum is unhygienic	Land belongs to the Beneficiary	40	The National Highway NH-36 – 0.3 kms away	Major population is living in huts, made of darma / bricks with tin sheets and asbestos/tiles on roof	Majority portion of roads are brick paved or damaged roads.	Habitation pattern in the slums is congested with insufficient open space
9	K.C.DEY	The condition of living in the slum is unhygienic	Land belongs to the Beneficiary	25	The National Highway NH-36 – 0.3 kms away	Major population is living in huts, made of darma / bricks with tin sheets and asbestos/tiles on roof	Majority portion of roads are brick paved or damaged roads.	Habitation pattern in the slums is congested with insufficient open space
10	PANCHANANTOLLA	The condition of living in the slum is unhygienic	Land belongs to the Beneficiary	25	The National Highway NH-36 – 0.3 kms away	Major population is living in huts, made of darma / bricks with tin sheets and asbestos/tiles on roof	Majority portion of roads are brick paved or damaged roads.	Habitation pattern in the slums is congested with insufficient open space
11	D.D.HAR LANE	The condition of living in the slum is unhygienic	Land belongs to the Beneficiary	20	The National Highway NH-36 – 0.3 kms away	Major population is living in huts, made of darma / bricks with tin sheets and asbestos/tiles on roof	Majority portion of roads are brick paved or damaged roads.	Habitation pattern in the slums is congested with insufficient open space
12	SITALATOLLA	The condition of living in the slum is unhygienic	Land belongs to the Beneficiary	20	The National Highway NH-36 – 0.3 kms away	Major population is living in huts, made of darma / bricks with tin sheets and asbestos/tiles on roof	Majority portion of roads are brick paved or damaged roads.	Habitation pattern in the slums is congested with insufficient open space

13	SASTITOLLA	The condition of living in the slum is unhygienic	Land belongs to the Beneficiary	50	The National Highway NH-36 – 0.3 kms away	Major population is living in huts, made of darma / bricks with tin sheets and asbestos/tiles on roof	Majority portion of roads are brick paved or damaged roads.	Habitation pattern in the slums is congested with insufficient open space
14	BIRINCHIPARA	The condition of living in the slum is unhygienic	Land belongs to the Beneficiary	30	The National Highway NH-36 – 0.3 kms away	Major population is living in huts, made of darma / bricks with tin sheets and asbestos/tiles on roof	Majority portion of roads are brick paved or damaged roads.	Habitation pattern in the slums is congested with insufficient open space
15	BEHIND RISHRA HIGH SCHOOL	The condition of living in the slum is unhygienic	Land belongs to the Beneficiary	40	The National Highway NH-36 – 0.3 kms away	Major population is living in huts, made of darma / bricks with tin sheets and asbestos/tiles on roof	Majority portion of roads are brick paved or damaged roads.	Habitation pattern in the slums is congested with insufficient open space
16	BEHIND BURNING GHAT	The condition of living in the slum is unhygienic	Land belongs to the Beneficiary	40	The National Highway NH-36 – 0.3 kms away	Major population is living in huts, made of darma / bricks with tin sheets and asbestos/tiles on roof	Majority portion of roads are brick paved or damaged roads.	Habitation pattern in the slums is congested with insufficient open space
17	HARIPODDAR LANE	The condition of living in the slum is unhygienic	Land belongs to the Beneficiary	40	The National Highway NH-36 – 0.3 kms away	Major population is living in huts, made of darma / bricks with tin sheets and asbestos/tiles on roof	Majority portion of roads are brick paved or damaged roads.	Habitation pattern in the slums is congested with insufficient open space
18	BEHIND PREMMANDIR (BRAHMATOLLA)	The condition of living in the slum is unhygienic	Land belongs to the Beneficiary	40	The National Highway NH-36 – 0.3 kms away	Major population is living in huts, made of darma / bricks with tin sheets and asbestos/tiles on roof	Majority portion of roads are brick paved or damaged roads.	Habitation pattern in the slums is congested with insufficient open space

19	BAGKHAL BRICK FIELD	The condition of living in the slum is unhygienic	Land belongs to the Beneficiary	40	The National Highway NH-36 – 0.3 kms away	Major population is living in huts, made of darma / bricks with tin sheets and asbestos/tiles on roof	Majority portion of roads are brick paved or damaged roads.	Habitation pattern in the slums is congested with insufficient open space
20	BAGKHAL	The condition of living in the slum is unhygienic	Land belongs to the Beneficiary	40	The National Highway NH-36 – 0.2 kms away	Major population is living in huts, made of darma / bricks with tin sheets and asbestos/tiles on roof	Majority portion of roads are brick paved or damaged roads.	Habitation pattern in the slums is congested with insufficient open space
21	MOREPUKUR 1ST LANE	The condition of living in the slum is unhygienic	Land belongs to the Beneficiary	20	The National Highway NH-36 – 0.2 kms away	Major population is living in huts, made of darma / bricks with tin sheets and asbestos/tiles on roof	Majority portion of roads are brick paved or damaged roads.	Habitation pattern in the slums is congested with insufficient open space
22	DASPARA	The condition of living in the slum is unhygienic	Land belongs to the Beneficiary	25	The National Highway NH-36 – 0.4 kms away	Major population is living in huts, made of darma / bricks with tin sheets and asbestos/tiles on roof	Majority portion of roads are brick paved or damaged roads.	Habitation pattern in the slums is congested with insufficient open space
23	ANUBHAVA ASSEMBLY HALL	The condition of living in the slum is unhygienic	Land belongs to the Beneficiary	25	The National Highway NH-36 – 0.2 kms away	Major population is living in huts, made of darma / bricks with tin sheets and asbestos/tiles on roof	Majority portion of roads are brick paved or damaged roads.	Habitation pattern in the slums is congested with insufficient open space
24	SADHANKANAN	The condition of living in the slum is unhygienic	Land belongs to the Beneficiary	25	The National Highway NH-36 – 0.2 kms away	Major population is living in huts, made of darma / bricks with tin sheets and asbestos/tiles on roof	Majority portion of roads are brick paved or damaged roads.	Habitation pattern in the slums is congested with insufficient open space

25	KISHORE SANGHA	The condition of living in the slum is unhygienic	Land belongs to the Beneficiary	25	The National Highway NH-36 – 0.4 kms away	Major population is living in huts, made of darma / bricks with tin sheets and asbestos/tiles on roof	Majority portion of roads are brick paved or damaged roads.	Habitation pattern in the slums is congested with insufficient open space
26	NAYABUSTEE	The condition of living in the slum is unhygienic	Land belongs to the Beneficiary	30	The National Highway NH-36 – 0.5 kms away	Major population is living in huts, made of darma / bricks with tin sheets and asbestos/tiles on roof	Majority portion of roads are brick paved or damaged roads.	Habitation pattern in the slums is congested with insufficient open space
27	NAYABUSTEE	The condition of living in the slum is unhygienic	Land belongs to the Beneficiary	30	The National Highway NH-36 – 0.5 kms away	Major population is living in huts, made of darma / bricks with tin sheets and asbestos/tiles on roof	Majority portion of roads are brick paved or damaged roads.	Habitation pattern in the slums is congested with insufficient open space
28	HARIR MATH & NITYANANDA PALLY	The condition of living in the slum is unhygienic	Land belongs to the Beneficiary	30	The National Highway NH-36 – 0.5 kms away	Major population is living in huts, made of darma / bricks with tin sheets and asbestos/tiles on roof	Majority portion of roads are brick paved or damaged roads.	Habitation pattern in the slums is congested with insufficient open space
29	NATUNGRAM PRIMARY SCHOOL	The condition of living in the slum is unhygienic	Land belongs to the Beneficiary	30	The National Highway NH-36 – 0.5 kms away	Major population is living in huts, made of darma / bricks with tin sheets and asbestos/tiles on roof	Majority portion of roads are brick paved or damaged roads.	Habitation pattern in the slums is congested with insufficient open space
30	HOTELWALA GOLI	The condition of living in the slum is unhygienic	Land belongs to the Beneficiary	30	The National Highway NH-36 – 0.5 kms away	Major population is living in huts, made of darma / bricks with tin sheets and asbestos/tiles on roof	Majority portion of roads are brick paved or damaged roads.	Habitation pattern in the slums is congested with insufficient open space

31	AAM BAGAN	The condition of living in the slum is unhygienic	Land belongs to the Beneficiary	50	The National Highway NH-36 – 0.5 kms away	Major population is living in huts, made of darma / bricks with tin sheets and asbestos/tiles on roof	Majority portion of roads are brick paved or damaged roads.	Habitation pattern in the slums is congested with insufficient open space
32	BURMANPARA	The condition of living in the slum is unhygienic	Land belongs to the Beneficiary	50	The National Highway NH-36 – 0.5 kms away	Major population is living in huts, made of darma / bricks with tin sheets and asbestos/tiles on roof	Majority portion of roads are brick paved or damaged roads.	Habitation pattern in the slums is congested with insufficient open space
33	BALAKSANGHA MATH	The condition of living in the slum is unhygienic	Land belongs to the Beneficiary	50	The National Highway NH-36 – 0.5 kms away	Major population is living in huts, made of darma / bricks with tin sheets and asbestos/tiles on roof	Majority portion of roads are brick paved or damaged roads.	Habitation pattern in the slums is congested with insufficient open space
34	SUBHASH NAGAR	The condition of living in the slum is unhygienic	Land belongs to the Beneficiary	30	The National Highway NH-36 – 0.5 kms away	Major population is living in huts, made of darma / bricks with tin sheets and asbestos/tiles on roof	Majority portion of roads are brick paved or damaged roads.	Habitation pattern in the slums is congested with insufficient open space
35	NABINPALLY	The condition of living in the slum is unhygienic	Land belongs to the Beneficiary	25	The National Highway NH-36 – 0.5 kms away	Major population is living in huts, made of darma / bricks with tin sheets and asbestos/tiles on roof	Majority portion of roads are brick paved or damaged roads.	Habitation pattern in the slums is congested with insufficient open space
36	SUBHASHNAGAR RAILPARK	The condition of living in the slum is unhygienic	Land belongs to the Beneficiary	30	The National Highway NH-36 – 0.4 kms away	Major population is living in huts, made of darma / bricks with tin sheets and asbestos/tiles on roof	Majority portion of roads are brick paved or damaged roads.	Habitation pattern in the slums is congested with insufficient open space

37	LUXMIPALLY	The condition of living in the slum is unhygienic	Land belongs to the Beneficiary	25	The National Highway NH-36 – 0.4 kms away	Major population is living in huts, made of darma / bricks with tin sheets and asbestos/tiles on roof	Majority portion of roads are brick paved or damaged roads.	Habitation pattern in the slums is congested with insufficient open space
38	SUBHASHNAGAR GOVT. COLONEY BACK SIDE OF WBSEB	The condition of living in the slum is unhygienic	Land belongs to the Beneficiary	20	The National Highway NH-36 – 0.4 kms away	Major population is living in huts, made of darma / bricks with tin sheets and asbestos/tiles on roof	Majority portion of roads are brick paved or damaged roads.	Habitation pattern in the slums is congested with insufficient open space
39	PALTEPARA	The condition of living in the slum is unhygienic	Land belongs to the Beneficiary	25	The National Highway NH-36 – 0.4 kms away	Major population is living in huts, made of darma / bricks with tin sheets and asbestos/tiles on roof	Majority portion of roads are brick paved or damaged roads.	Habitation pattern in the slums is congested with insufficient open space
40	BAGPARA	The condition of living in the slum is unhygienic	Land belongs to the Beneficiary	30	The National Highway NH-36 – 0.4 kms away	Major population is living in huts, made of darma / bricks with tin sheets and asbestos/tiles on roof	Majority portion of roads are brick paved or damaged roads.	Habitation pattern in the slums is congested with insufficient open space

House Type /Structure

Sl No	Name of Slum	Semi Pucca	Kuchha	Total
1	RISHRA BUSTEE(4)	38	31	69
2	RISHRA BUSTEE(5)	50	17	67
3	RISHRA BUSTEE(6)	44	18	62
4	RISHRA BUSTEE(7)	39	33	72
5	B.L.MUKHERJEE AND B.D. BANERJEE BYE LANE	30	15	45
6	CHANDI CHARAN BANERJEE LANE	10	8	18
7	S.D.MUKHERJEE AND N.S. ROAD	43	23	66
8	K.B.SAHA ROAD AND N.S. ROAD	5	15	20
9	K.C.DEY	8	5	13
10	PANCHANANTOLLA	4	5	9
11	D.D.HAR LANE	7	7	14
12	SITALATOLLA	13	10	23
13	SASTITOLLA	13	11	24
14	BIRINCHIPARA	45	65	110
15	BEHIND RISHRA HIGH SCHOOL	11	0	11
16	BEHIND BURNING GHAT	10	4	14
17	HARIPODDAR LANE	8	7	15
18	BEHIND PREMMANDIR (BRAHMATOLLA)	10	8	18
19	BAGKHAL BRICK FIELD	2	10	12
20	BAGKHAL	31	10	41
21	MOREPUKUR 1ST LANE	24	52	76
22	DASPARA	2	20	22
23	ANUBHAVA ASSEMBLY HALL	9	9	18
24	SADHANKANAN	5	8	13
25	KISHORE SANGHA	45	86	131
26	NAYABUSTEE	53	69	122

27	NAYABUSTEE	55	132	187
28	HARIR MATH & NITYANANDA PALLY	15	37	52
29	NATUNGRAM PRIMARY SCHOOL	14	0	14
30	HOTELWALA GOLI	8	14	22
31	AAM BAGAN	10	22	32
32	BURMANPARA	9	11	20
33	BALAKSANGHA MATH	31	9	40
34	SUBHASH NAGAR	46	92	138
35	NABINPALLY	8	14	22
36	SUBHASHNAGAR RAILPARK	25	20	45
37	LUXMIPALLY	10	5	15
38	SUBHASHNAGAR GOVT. COLONEY BACK SIDE OF WBSEB	8	7	15
39	PALTEPARA	10	25	35
40	BAGPARA	39	61	100

Status of Physical Infrastructure

RISHRA BUSTEE(4)	
Physical Infrastructure	Status
1. Connectivity to City-wide Water Supply System	Partially connected
2. Connectivity to City-wide Strom-water Drainage Supply System	Partially connected
3. Connectivity to City-wide Sewerage System	Not connected
4. Whether the slum is prone to flooding due to rains	No
5. Frequency of garbage Disposal	Once in two days
6. Arrangement for Global Disposal	Municipal staff
7. Frequency of clearance open drains	Once in 2 days
8. Approach Road/Lane/Constructed Path to Slum	Motorable Pucca
9. Distance from the nearest Motorable road	Less than 0.5 km
10. Internal Road	Non-Motorable Kaccha
11. Whether Street light facility is available in the Slum	No
RISHRA BUSTEE(5)	
Physical Infrastructure	Status
1. Connectivity to City-wide Water Supply System	Partially connected
2. Connectivity to City-wide Strom-water Drainage Supply System	Partially connected
3. Connectivity to City-wide Sewerage System	Not connected
4. Whether the slum is prone to flooding due to rains	No
5. Frequency of garbage Disposal	Once in two days
6. Arrangement for Global Disposal	Municipal staff
7. Frequency of clearance open drains	Once in 2 days
8. Approach Road/Lane/Constructed Path to Slum	Motorable Pucca
9. Distance from the nearest Motorable road	Less than 0.5 km
10. Internal Road	Non-Motorable Kaccha
11. Whether Street light facility is available in the Slum	yes
RISHRA BUSTEE(6)	
Physical Infrastructure	Status
1. Connectivity to City-wide Water Supply System	Partially connected

2. Connectivity to City-wide Strom-water Drainage Supply System	Partially connected
3. Connectivity to City-wide Sewerage System	Not connected
4. Whether the slum is prone to flooding due to rains	No
5. Frequency of garbage Disposal	Once in two days
6. Arrangement for Global Disposal	Municipal staff
7. Frequency of clearance open drains	Once in 2 days
8. Approach Road/Lane/Constructed Path to Slum	Motorable Pucca
9. Distance from the nearest Motorable road	Less than 0.5 km
10. Internal Road	Motorable Kaccha
11. Whether Street light facility is available in the Slum	yes
RISHRA BUSTEE(7)	
Physical Infrastructure	Status
1. Connectivity to City-wide Water Supply System	Partially connected
2. Connectivity to City-wide Strom-water Drainage Supply System	Partially connected
3. Connectivity to City-wide Sewerage System	Partially connected
4. Whether the slum is prone to flooding due to rains	No
5. Frequency of garbage Disposal	Once in two days
6. Arrangement for Global Disposal	Municipal staff
7. Frequency of clearance open drains	Once in 2 days
8. Approach Road/Lane/Constructed Path to Slum	Motorable Pucca
9. Distance from the nearest Motorable road	Less than 0.5 km
10. Internal Road	Non-Motorable Kaccha
11. Whether Street light facility is available in the Slum	yes
B.L.MUKHERJEE AND B.D. BANERJEE BYE LANE	
Physical Infrastructure	Status
1. Connectivity to City-wide Water Supply System	Partially connected
2. Connectivity to City-wide Strom-water Drainage Supply System	Partially connected
3. Connectivity to City-wide Sewerage System	Not connected
4. Whether the slum is prone to flooding due to rains	No
5. Frequency of garbage Disposal	Once in two days

6. Arrangement for Global Disposal	Municipal staff
7. Frequency of clearance open drains	Once in 2 days
8. Approach Road/Lane/Constructed Path to Slum	Motorable Pucca
9.Distance from the nearest Motorable road	Less than 0.5 km
10.Internal Road	Non-Motorable Kaccha
11.Whether Street light facility is available in the Slum	yes

CHANDI CHARAN BANERJEE LANE

Physical Infrastructure	Status
1. Connectivity to City-wide Water Supply System	Partially connected
2. Connectivity to City-wide Strom-water Drainage Supply System	Partially connected
3. Connectivity to City-wide Sewerage System	Not connected
4.Whether the slum is prone to flooding due to rains	No
5. Frequency of garbage Disposal	Once in two days
6. Arrangement for Global Disposal	Municipal staff
7. Frequency of clearance open drains	Once in 2 days
8. Approach Road/Lane/Constructed Path to Slum	Motorable Pucca
9.Distance from the nearest Motorable road	Less than 0.5 km
10.Internal Road	Non-Motorable Kaccha
11.Whether Street light facility is available in the Slum	yes

S.D.MUKHERJEE AND N.S. ROAD

Physical Infrastructure	Status
1. Connectivity to City-wide Water Supply System	Partially connected
2. Connectivity to City-wide Strom-water Drainage Supply System	Partially connected
3. Connectivity to City-wide Sewerage System	Not connected
4.Whether the slum is prone to flooding due to rains	Up to 15 days
5. Frequency of garbage Disposal	Once in two days

6. Arrangement for Global Disposal	Municipal staff
7. Frequency of clearance open drains	Once in 2 days
8. Approach Road/Lane/Constructed Path to Slum	Motorable Pucca
9.Distance from the nearest Motorable road	Less than 0.5 km
10.Internal Road	Non-Motorable Kaccha
11.Whether Street light facility is available in the Slum	No
K.B.SAHA ROAD AND N.S. ROAD	
Physical Infrastructure	Status
1. Connectivity to City-wide Water Supply System	Partially connected
2. Connectivity to City-wide Strom-water Drainage Supply System	Partially connected
3. Connectivity to City-wide Sewerage System	Not connected
4.Whether the slum is prone to flooding due to rains	Up to 15 days
5. Frequency of garbage Disposal	Daily
6. Arrangement for Global Disposal	Municipal staff
7. Frequency of clearance open drains	Daily
8. Approach Road/Lane/Constructed Path to Slum	Motorable Pucca
9.Distance from the nearest Motorable road	Less than 0.5 km
10.Internal Road	Non-Motorable Kaccha
11.Whether Street light facility is available in the Slum	yes
K.C.DEY	
Physical Infrastructure	Status
1. Connectivity to City-wide Water Supply System	Partially connected
2. Connectivity to City-wide Strom-water Drainage Supply System	Partially connected
3. Connectivity to City-wide Sewerage System	Not connected
4.Whether the slum is prone to flooding due to rains	Up to 15 days
5. Frequency of garbage Disposal	Daily
6. Arrangement for Global Disposal	Municipal staff
7. Frequency of clearance open drains	Daily

8. Approach Road/Lane/Constructed Path to Slum	Non-Motorable Kaccha
9.Distance from the nearest Motorable road	More than 5.0 km
10.Internal Road	Non-Motorable Kaccha
11.Whether Street light facility is available in the Slum	No
PANCHANANTOLLA	
Physical Infrastructure	Status
1. Connectivity to City-wide Water Supply System	Partially connected
2. Connectivity to City-wide Strom-water Drainage Supply System	Partially connected
3. Connectivity to City-wide Sewerage System	Not connected
4.Whether the slum is prone to flooding due to rains	Up to 15 days
5. Frequency of garbage Disposal	Daily
6. Arrangement for Global Disposal	Municipal staff
7. Frequency of clearance open drains	Daily
8. Approach Road/Lane/Constructed Path to Slum	Non-Motorable Kaccha
9.Distance from the nearest Motorable road	More than 5.0 km
10.Internal Road	Non-Motorable Kaccha
11.Whether Street light facility is available in the Slum	No
D.D.HAR LANE	
Physical Infrastructure	Status
1. Connectivity to City-wide Water Supply System	Partially connected
2. Connectivity to City-wide Strom-water Drainage Supply System	Partially connected
3. Connectivity to City-wide Sewerage System	Not connected

4. Whether the slum is prone to flooding due to rains	Up to 15 days
5. Frequency of garbage Disposal	Daily
6. Arrangement for Global Disposal	Municipal staff
7. Frequency of clearance open drains	Daily
8. Approach Road/Lane/Constructed Path to Slum	Non-Motorable Kaccha
9. Distance from the nearest Motorable road	More than 5.0 km
10. Internal Road	Non-Motorable Kaccha
11. Whether Street light facility is available in the Slum	No
SITALATOLLA	
Physical Infrastructure	Status
1. Connectivity to City-wide Water Supply System	Partially connected
2. Connectivity to City-wide Storm-water Drainage Supply System	Partially connected
3. Connectivity to City-wide Sewerage System	Not connected
4. Whether the slum is prone to flooding due to rains	Up to 15 days
5. Frequency of garbage Disposal	Daily
6. Arrangement for Global Disposal	Municipal staff
7. Frequency of clearance open drains	Daily
8. Approach Road/Lane/Constructed Path to Slum	Non-Motorable Kaccha
9. Distance from the nearest Motorable road	More than 5.0 km
10. Internal Road	Non-Motorable Kaccha
11. Whether Street light facility is available in the Slum	No
SASTITOLLA	
Physical Infrastructure	Status
1. Connectivity to City-wide Water Supply	Partially connected

System	
2. Connectivity to City-wide Strom-water Drainage Supply System	Partially connected
3. Connectivity to City-wide Sewerage System	Not connected
4. Whether the slum is prone to flooding due to rains	Up to 15 days
5. Frequency of garbage Disposal	Daily
6. Arrangement for Global Disposal	Municipal staff
7. Frequency of clearance open drains	Daily
8. Approach Road/Lane/Constructed Path to Slum	Non-Motorable Kaccha
9. Distance from the nearest Motorable road	More than 5.0 km
10. Internal Road	Non-Motorable Kaccha
11. Whether Street light facility is available in the Slum	No

BIRINCHIPARA

Physical Infrastructure	Status
1. Connectivity to City-wide Water Supply System	Partially connected
2. Connectivity to City-wide Strom-water Drainage Supply System	Partially connected
3. Connectivity to City-wide Sewerage System	Not connected
4. Whether the slum is prone to flooding due to rains	15-30 days
5. Frequency of garbage Disposal	Once in a week
6. Arrangement for Global Disposal	Municipal staff
7. Frequency of clearance open drains	Once in 15 days
8. Approach Road/Lane/Constructed Path to Slum	Motorable Pucca
9. Distance from the nearest Motorable road	More than 0.5 km
10. Internal Road	Non-Motorable Kaccha
11. Whether Street light facility is available in the Slum	yes

BEHIND RISHRA HIGH SCHOOL

Physical Infrastructure	Status
1. Connectivity to City-wide Water Supply System	Partially connected
2. Connectivity to City-wide Strom-water Drainage Supply System	Partially connected
3. Connectivity to City-wide Sewerage System	Not connected

4. Whether the slum is prone to flooding due to rains	15-30 days
5. Frequency of garbage Disposal	Once in a week
6. Arrangement for Global Disposal	Municipal staff
7. Frequency of clearance open drains	Once in 15 days
8. Approach Road/Lane/Constructed Path to Slum	Motorable Pucca
9. Distance from the nearest Motorable road	More than 0.5 km
10. Internal Road	Non-Motorable Kaccha
11. Whether Street light facility is available in the Slum	yes
BEHIND BURNING GHAT	
Physical Infrastructure	Status
1. Connectivity to City-wide Water Supply System	Partially connected
2. Connectivity to City-wide Storm-water Drainage Supply System	Partially connected
3. Connectivity to City-wide Sewerage System	Not connected
4. Whether the slum is prone to flooding due to rains	15-30 days
5. Frequency of garbage Disposal	Once in a week
6. Arrangement for Global Disposal	Municipal staff
7. Frequency of clearance open drains	Once in 15 days
8. Approach Road/Lane/Constructed Path to Slum	Motorable Pucca
9. Distance from the nearest Motorable road	More than 0.5 km
10. Internal Road	Non-Motorable Kaccha
11. Whether Street light facility is available in the Slum	yes
HARIPODDAR LANE	

Physical Infrastructure	Status
1. Connectivity to City-wide Water Supply System	Partially connected
2. Connectivity to City-wide Strom-water Drainage Supply System	Partially connected
3. Connectivity to City-wide Sewerage System	Not connected
4. Whether the slum is prone to flooding due to rains	15-30 days
5. Frequency of garbage Disposal	Once in a week
6. Arrangement for Global Disposal	Municipal staff
7. Frequency of clearance open drains	Once in 15 days
8. Approach Road/Lane/Constructed Path to Slum	Motorable Pucca
9. Distance from the nearest Motorable road	More than 0.5 km
10. Internal Road	Non-Motorable Kaccha
11. Whether Street light facility is available in the Slum	yes
BEHIND PREMMANDIR (BRAHMATOLLA)	
Physical Infrastructure	Status
1. Connectivity to City-wide Water Supply System	Partially connected
2. Connectivity to City-wide Strom-water Drainage Supply System	Partially connected
3. Connectivity to City-wide Sewerage System	Not connected
4. Whether the slum is prone to flooding due to rains	No
5. Frequency of garbage Disposal	Once in a week
6. Arrangement for Global Disposal	Municipal staff
7. Frequency of clearance open drains	Once in 2 days
8. Approach Road/Lane/Constructed Path to Slum	Motorable Pucca
9. Distance from the nearest Motorable road	Less than 0.5 km
10. Internal Road	Non-Motorable Kaccha
11. Whether Street light facility is available in the Slum	yes
BAGKHAL BRICK FIELD	

Physical Infrastructure	Status
1. Connectivity to City-wide Water Supply System	Partially connected
2. Connectivity to City-wide Storm-water Drainage Supply System	Partially connected
3. Connectivity to City-wide Sewerage System	Not connected
4. Whether the slum is prone to flooding due to rains	No
5. Frequency of garbage Disposal	Once in a week
6. Arrangement for Global Disposal	Municipal staff
7. Frequency of clearance open drains	Once in 2 days
8. Approach Road/Lane/Constructed Path to Slum	Motorable Pucca
9. Distance from the nearest Motorable road	Less than 0.5 km
10. Internal Road	Non-Motorable Kaccha
11. Whether Street light facility is available in the Slum	yes
BAGKHAL	
Physical Infrastructure	Status
1. Connectivity to City-wide Water Supply System	Partially connected
2. Connectivity to City-wide Storm-water Drainage Supply System	Partially connected
3. Connectivity to City-wide Sewerage System	Not connected
4. Whether the slum is prone to flooding due to rains	No
5. Frequency of garbage Disposal	Once in three days
6. Arrangement for Global Disposal	Municipal staff
7. Frequency of clearance open drains	Once in a month
8. Approach Road/Lane/Constructed Path to Slum	Motorable Pucca
9. Distance from the nearest Motorable road	Less than 0.5 km
10. Internal Road	Non-Motorable Kaccha
11. Whether Street light facility is available in the Slum	yes
MOREPUKUR 1ST LANE	

Physical Infrastructure	Status
1. Connectivity to City-wide Water Supply System	Partially connected
2. Connectivity to City-wide Storm-water Drainage Supply System	Partially connected
3. Connectivity to City-wide Sewerage System	Not connected
4. Whether the slum is prone to flooding due to rains	No
5. Frequency of garbage Disposal	Once in three days
6. Arrangement for Global Disposal	Municipal staff
7. Frequency of clearance open drains	Once in a month
8. Approach Road/Lane/Constructed Path to Slum	Motorable Pucca
9. Distance from the nearest Motorable road	Less than 0.5 km
10. Internal Road	Non-Motorable Kaccha
11. Whether Street light facility is available in the Slum	yes

DASPARA

Physical Infrastructure	Status
1. Connectivity to City-wide Water Supply System	Partially connected
2. Connectivity to City-wide Storm-water Drainage Supply System	Partially connected
3. Connectivity to City-wide Sewerage System	Not connected
4. Whether the slum is prone to flooding due to rains	Up to 15 days
5. Frequency of garbage Disposal	Once in a week
6. Arrangement for Global Disposal	Municipal staff
7. Frequency of clearance open drains	Once in a week
8. Approach Road/Lane/Constructed Path to Slum	Motorable Pucca
9. Distance from the nearest Motorable road	Less than 0.5 km
10. Internal Road	Non-Motorable Kaccha
11. Whether Street light facility is available in the Slum	yes

ANUBHAVA ASSEMBLY HALL

Physical Infrastructure	Status
1. Connectivity to City-wide Water Supply System	Partially connected
2. Connectivity to City-wide Strom-water Drainage Supply System	Partially connected
3. Connectivity to City-wide Sewerage System	Not connected
4. Whether the slum is prone to flooding due to rains	Up to 15 days
5. Frequency of garbage Disposal	Once in a week
6. Arrangement for Global Disposal	Municipal staff
7. Frequency of clearance open drains	Once in a week
8. Approach Road/Lane/Constructed Path to Slum	Motorable Pucca
9. Distance from the nearest Motorable road	Less than 0.5 km
10. Internal Road	Non-Motorable Kaccha
11. Whether Street light facility is available in the Slum	yes

SADHANKANAN

Physical Infrastructure	Status
1. Connectivity to City-wide Water Supply System	Partially connected
2. Connectivity to City-wide Strom-water Drainage Supply System	Partially connected
3. Connectivity to City-wide Sewerage System	Not connected
4. Whether the slum is prone to flooding due to rains	Up to 15 days
5. Frequency of garbage Disposal	Once in a week
6. Arrangement for Global Disposal	Municipal staff
7. Frequency of clearance open drains	Once in a week
8. Approach Road/Lane/Constructed Path to Slum	Motorable Pucca

9.Distance from the nearest Motorable road	Less than 0.5 km
10.Internal Road	Non-Motorable Kaccha
11.Whether Street light facility is available in the Slum	yes
KISHORE SANGHA	
Physical Infrastructure	Status
1. Connectivity to City-wide Water Supply System	Partially connected
2. Connectivity to City-wide Strom-water Drainage Supply System	Partially connected
3. Connectivity to City-wide Sewerage System	Not connected
4.Whether the slum is prone to flooding due to rains	Up to 15 days
5. Frequency of garbage Disposal	Once in two days
6. Arrangement for Global Disposal	Municipal staff
7. Frequency of clearance open drains	Once in a week
8. Approach Road/Lane/Constructed Path to Slum	Motorable Pucca
9.Distance from the nearest Motorable road	Less than 0.5 km
10.Internal Road	Non-Motorable Kaccha
11.Whether Street light facility is available in the Slum	yes
NAYABUSTEE	
Physical Infrastructure	Status
1. Connectivity to City-wide Water Supply System	Partially connected
2. Connectivity to City-wide Strom-water Drainage Supply System	Partially connected
3. Connectivity to City-wide Sewerage System	Not connected
4.Whether the slum is prone to flooding due to rains	Up to 15 days
5. Frequency of garbage Disposal	Once in two days
6. Arrangement for Global Disposal	Municipal staff
7. Frequency of clearance open drains	Once in 2 days
8. Approach Road/Lane/Constructed Path to Slum	Motorable Pucca
9.Distance from the nearest Motorable road	Less than 0.5 km
10.Internal Road	Non-Motorable Kaccha
11.Whether Street light facility is available in the Slum	yes
NAYABUSTEE	

Physical Infrastructure	Status
1. Connectivity to City-wide Water Supply System	Partially connected
2. Connectivity to City-wide Strom-water Drainage Supply System	Partially connected
3. Connectivity to City-wide Sewerage System	Not connected
4. Whether the slum is prone to flooding due to rains	Up to 15 days
5. Frequency of garbage Disposal	Once in two days
6. Arrangement for Global Disposal	Municipal staff
7. Frequency of clearance open drains	Once in 2 days
8. Approach Road/Lane/Constructed Path to Slum	Motorable Pucca
9. Distance from the nearest Motorable road	Less than 0.5 km
10. Internal Road	Non-Motorable Kaccha
11. Whether Street light facility is available in the Slum	yes

HARIR MATH & NITYANANDA PALLY

Physical Infrastructure	Status
1. Connectivity to City-wide Water Supply System	Partially connected
2. Connectivity to City-wide Strom-water Drainage Supply System	Partially connected
3. Connectivity to City-wide Sewerage System	Not connected
4. Whether the slum is prone to flooding due to rains	Up to 15 days
5. Frequency of garbage Disposal	Once in two days
6. Arrangement for Global Disposal	Municipal staff
7. Frequency of clearance open drains	Once in 2 days
8. Approach Road/Lane/Constructed Path to Slum	Motorable Pucca
9. Distance from the nearest Motorable road	Less than 0.5 km
10. Internal Road	Non-Motorable Kaccha
11. Whether Street light facility is available in the Slum	yes

NATUNGRAM PRIMARY SCHOOL	
Physical Infrastructure	Status
1. Connectivity to City-wide Water Supply System	Partially connected
2. Connectivity to City-wide Storm-water Drainage Supply System	Partially connected
3. Connectivity to City-wide Sewerage System	Not connected
4. Whether the slum is prone to flooding due to rains	Up to 15 days
5. Frequency of garbage Disposal	Once in two days
6. Arrangement for Global Disposal	Municipal staff
7. Frequency of clearance open drains	Once in 2 days
8. Approach Road/Lane/Constructed Path to Slum	Motorable Pucca
9. Distance from the nearest Motorable road	Less than 0.5 km
10. Internal Road	Non-Motorable Kaccha
11. Whether Street light facility is available in the Slum	yes
HOTELWALA GOLI	
Physical Infrastructure	Status
1. Connectivity to City-wide Water Supply System	Partially connected
2. Connectivity to City-wide Storm-water Drainage Supply System	Partially connected
3. Connectivity to City-wide Sewerage System	Not connected
4. Whether the slum is prone to flooding due to rains	Up to 15 days
5. Frequency of garbage Disposal	Once in two days
6. Arrangement for Global Disposal	Municipal staff
7. Frequency of clearance open drains	Once in 2 days

8. Approach Road/Lane/Constructed Path to Slum	Motorable Pucca
9.Distance from the nearest Motorable road	Less than 0.5 km
10.Internal Road	Non-Motorable Kaccha
11.Whether Street light facility is available in the Slum	yes
AAM BAGAN	
Physical Infrastructure	Status
1. Connectivity to City-wide Water Supply System	Partially connected
2. Connectivity to City-wide Strom-water Drainage Supply System	Partially connected
3. Connectivity to City-wide Sewerage System	Not connected
4.Whether the slum is prone to flooding due to rains	Up to 15 days
5. Frequency of garbage Disposal	Daily
6. Arrangement for Global Disposal	Municipal staff
7. Frequency of clearance open drains	Daily
8. Approach Road/Lane/Constructed Path to Slum	Non-Motorable Kaccha
9.Distance from the nearest Motorable road	More than 5.0 km
10.Internal Road	Non-Motorable Kaccha
11.Whether Street light facility is available in the Slum	No
BURMANPARA	
Physical Infrastructure	Status
1. Connectivity to City-wide Water Supply System	Partially connected
2. Connectivity to City-wide Strom-water Drainage Supply System	Partially connected
3. Connectivity to City-wide Sewerage System	Not connected
4.Whether the slum is prone to flooding due to rains	Up to 15 days
5. Frequency of garbage Disposal	Daily
6. Arrangement for Global Disposal	Municipal staff
7. Frequency of clearance open drains	Daily

8. Approach Road/Lane/Constructed Path to Slum	Non-Motorable Kaccha
9.Distance from the nearest Motorable road	More than 5.0 km
10.Internal Road	Non-Motorable Kaccha
11.Whether Street light facility is available in the Slum	No

BALAKSANGHA MATH

Physical Infrastructure	Status
1. Connectivity to City-wide Water Supply System	Partially connected
2. Connectivity to City-wide Strom-water Drainage Supply System	Partially connected
3. Connectivity to City-wide Sewerage System	Not connected
4.Whether the slum is prone to flooding due to rains	Up to 15 days
5. Frequency of garbage Disposal	Daily
6. Arrangement for Global Disposal	Municipal staff
7. Frequency of clearance open drains	Daily
8. Approach Road/Lane/Constructed Path to Slum	Non-Motorable Kaccha
9.Distance from the nearest Motorable road	More than 5.0 km
10.Internal Road	Non-Motorable Kaccha
11.Whether Street light facility is available in the Slum	No

SUBHASH NAGAR

Physical Infrastructure	Status
1. Connectivity to City-wide Water Supply System	Partially connected
2. Connectivity to City-wide Strom-water Drainage Supply System	Partially connected
3. Connectivity to City-wide Sewerage System	Not connected
4.Whether the slum is prone to flooding due to rains	Up to 15 days
5. Frequency of garbage Disposal	Once in two days

6. Arrangement for Global Disposal	Municipal staff
7. Frequency of clearance open drains	Once in 2 days
8. Approach Road/Lane/Constructed Path to Slum	Motorable Pucca
9.Distance from the nearest Motorable road	Less than 0.5 km
10.Internal Road	Non-Motorable Kaccha
11.Whether Street light facility is available in the Slum	yes

NABINPALLY

Physical Infrastructure	Status
1. Connectivity to City-wide Water Supply System	Partially connected
2. Connectivity to City-wide Strom-water Drainage Supply System	Partially connected
3. Connectivity to City-wide Sewerage System	Not connected
4.Whether the slum is prone to flooding due to rains	Up to 15 days
5. Frequency of garbage Disposal	Once in a week
6. Arrangement for Global Disposal	Municipal staff
7. Frequency of clearance open drains	Once in 2 days
8. Approach Road/Lane/Constructed Path to Slum	Motorable Pucca
9.Distance from the nearest Motorable road	Less than 0.5 km
10.Internal Road	Non-Motorable Kaccha
11.Whether Street light facility is available in the Slum	yes

SUBHASHNAGAR RAILPARK

Physical Infrastructure	Status
1. Connectivity to City-wide Water Supply System	Partially connected
2. Connectivity to City-wide Strom-water Drainage Supply System	Partially connected
3. Connectivity to City-wide Sewerage System	Not connected
4.Whether the slum is prone to flooding due to rains	Up to 15 days
5. Frequency of garbage Disposal	Once in a week
6. Arrangement for Global Disposal	Municipal staff
7. Frequency of clearance open drains	Once in 2 days

8. Approach Road/Lane/Constructed Path to Slum	Motorable Pucca
9.Distance from the nearest Motorable road	Less than 0.5 km
10.Internal Road	Non-Motorable Kaccha
11.Whether Street light facility is available in the Slum	yes

LUXMIPALLY

Physical Infrastructure	Status
1. Connectivity to City-wide Water Supply System	Partially connected
2. Connectivity to City-wide Strom-water Drainage Supply System	Partially connected
3. Connectivity to City-wide Sewerage System	Not connected
4.Whether the slum is prone to flooding due to rains	Up to 15 days
5. Frequency of garbage Disposal	Once in a week
6. Arrangement for Global Disposal	Municipal staff
7. Frequency of clearance open drains	Once in 2 days
8. Approach Road/Lane/Constructed Path to Slum	Motorable Pucca
9.Distance from the nearest Motorable road	Less than 0.5 km
10.Internal Road	Non-Motorable Kaccha
11.Whether Street light facility is available in the Slum	yes

SUBHASHNAGAR GOVT. COLONEY BACK SIDE OF WBSEB

Physical Infrastructure	Status
1. Connectivity to City-wide Water Supply System	Partially connected
2. Connectivity to City-wide Strom-water Drainage Supply System	Partially connected
3. Connectivity to City-wide Sewerage System	Not connected
4.Whether the slum is prone to flooding due to rains	Up to 15 days
5. Frequency of garbage Disposal	Once in a week

6. Arrangement for Global Disposal	Municipal staff
7. Frequency of clearance open drains	Once in 2 days
8. Approach Road/Lane/Constructed Path to Slum	Non-Motorable Pucca
9.Distance from the nearest Motorable road	Less than 0.5 km
10.Internal Road	Motorable Kaccha
11.Whether Street light facility is available in the Slum	yes

PALTEPARA

Physical Infrastructure	Status
1. Connectivity to City-wide Water Supply System	Partially connected
2. Connectivity to City-wide Strom-water Drainage Supply System	Partially connected
3. Connectivity to City-wide Sewerage System	Not connected
4.Whether the slum is prone to flooding due to rains	Up to 15 days
5. Frequency of garbage Disposal	Once in a week
6. Arrangement for Global Disposal	Municipal staff
7. Frequency of clearance open drains	Once in a week
8. Approach Road/Lane/Constructed Path to Slum	Motorable Pucca
9.Distance from the nearest Motorable road	Less than 0.5 km
10.Internal Road	Non-Motorable Kaccha
11.Whether Street light facility is available in the Slum	yes

BAGPARA

Physical Infrastructure	Status
1. Connectivity to City-wide Water Supply System	Partially connected
2. Connectivity to City-wide Strom-water Drainage Supply System	Partially connected
3. Connectivity to City-wide Sewerage System	Not connected
4.Whether the slum is prone to flooding due to rains	Up to 15 days
5. Frequency of garbage Disposal	Once in a week
6. Arrangement for Global Disposal	Municipal staff
7. Frequency of clearance open drains	Once in a week

8. Approach Road/Lane/Constructed Path to Slum	Motorable Pucca
9.Distance from the nearest Motorable road	Less than 0.5 km
10.Internal Road	Non-Motorable Kaccha
11.Whether Street light facility is available in the Slum	yes

Details of Social Infrastructure at a glance:

1. RISHRA BUSTEE(4)

Education & Social Infrastructure	
Pre-primary School	
Anganwadi under ICDS	Within Slum
Municipal Pre-school	NA
Private Pre-school	Within Slum
Primary School	
Municipal	Within Slum
State Government	Within Slum
Private	Within Slum
High School	
Municipal	NA
Private	Within Slum
State Government	Within Slum
Adult Education Centre	NA
Health Facilities	Around slum
Urban Health Post	Within Slum
Primary Health Centre	More than 5.0 km
Government Hospital	More than 5.0 km
Maternity Centre	More than 5.0 km
Private Clinic	Within Slum
Registered Medical Practitioner (RMP)	NA
Ayurvedic Doctor/Vaidya	Within Slum
Social Development/Welfare	Within slum
Community Hall	Within Slum
Livelihood/Production Centre	NA
Vocational Training/Training cum Production Centre	NA
Street Children Rehabilitation Centre	NA
Night Shelter	NA

Old Age Home	NA
Self Help Groups/DWCUA Groups in Slum	NA
No. of Neighbourhoods Groups (NHGs) in slum	8
Slum-dwellers Association	NA
Youth Association	7
Women's Association/Mahila Samithis	NA

2. RISHRA BUSTEE(5)

Education & Social Infrastructure	
Pre-primary School	
Anganwadi under ICDS	Within Slum
Municipal Pre-school	NA
Private Pre-school	NA
Primary School	
Municipal	0.5 to 1.0 kms
State Government	Within distance less than 0.5 km
Private	NA
High School	
Municipal	NA
Private	NA
State Government	Within distance less than 0.5 km
Adult Education Centre	NA
Health Facilities	Around slum
Urban Health Post	Within distance less than 0.5 km
Primary Health Centre	More than 0.5 km
Government Hospital	More than 0.5 km
Maternity Centre	More than 0.5 km
Private Clinic	NA
Registered Medical Practitioner (RMP)	Within Slum

Ayurvedic Doctor/Vaidya	NA
Social Development/Welfare	Within Slum
Community Hall	0.5 to 1.0 kms
Livelihood/Production Centre	NA
Vocational Training/Training cum Production Centre	NA
Street Children Rehabilitation Centre	NA
Night Shelter	NA
Old Age Home	NA
Self Help Groups/DWCUA Groups in Slum	NA
No. of Neighbourhoods Groups (NHGs) in slum	5
Slum-dwellers Association	NA
Youth Association	5
Women's Association/Mahila Samithis	NA

3. RISHRA BUSTEE(6)

Education & Social Infrastructure	
Pre-primary School	
Anganwadi under ICDS	Within Slum
Municipal Pre-school	NA
Private Pre-school	NA
Primary School	
Municipal	0.5 to 1.0 kms
State Government	Within Slum
Private	NA
High School	
Municipal	NA
Private	NA
State Government	Within Slum
Adult Education Centre	NA
Health Facilities	Around slum

Urban Health Post	NA
Primary Health Centre	More than 5.0 kms
Government Hospital	More than 5.0 kms
Maternity Centre	2.0 to 5.0 kms
Private Clinic	Within Slum
Registered Medical Practitioner (RMP)	Within Slum
Ayurvedic Doctor/Vaidya	NA
Social Development/Welfare	Within Slum
Community Hall	NA
Livelihood/Production Centre	NA
Vocational Training/Training cum Production Centre	NA
Street Children Rehabilitation Centre	NA
Night Shelter	NA
Old Age Home	NA
Self Help Groups/DWCUA Groups in Slum	NA
No. of Neighbourhoods Groups (NHGs) in slum	4
Slum-dwellers Association	NA
Youth Association	3
Women's Association/Mahila Samithis	NA

4. RISHRA BUSTEE(7)

Education & Social Infrastructure	
Pre-primary School	
Anganwadi under ICDS	Within Slum
Municipal Pre-school	NA
Private Pre-school	Within Slum
Primary School	
Municipal	0.5 to 1.0 kms
State Government	Within Slum
Private	Within Slum

High School	
Municipal	NA
Private	NA
State Government	0.5 to 1.0 kms
Adult Education Centre	NA
Health Facilities	Around slum
Urban Health Post	Within distance less than 0.5 km
Primary Health Centre	More than 5.0 kms
Government Hospital	More than 5.0 kms
Maternity Centre	More than 5.0 kms
Private Clinic	Within Slum
Registered Medical Practitioner (RMP)	Within Slum
Ayurvedic Doctor/Vaidya	NA
Social Development/Welfare	Within Slum
Community Hall	0.5 to 1.0 kms
Livelihood/Production Centre	NA
Vocational Training/Training cum Production Centre	NA
Street Children Rehabilitation Centre	NA
Night Shelter	NA
Old Age Home	NA
Self Help Groups/DWCUA Groups in Slum	NA
No. of Neighbourhoods Groups (NHGs) in slum	9
Slum-dwellers Association	NA
Youth Association	2
Women's Association/Mahila Samithis	NA

5. B.L.MUKHERJEE AND B.D. BANERJEE BYE LANE

Education & Social Infrastructure	
Pre-primary School	
Anganwadi under ICDS	Within Slum

Municipal Pre-school	NA
Private Pre-school	NA
Primary School	
Municipal	NA
State Government	0.5 to 1.0 kms
Private	0.5 to 1.0 kms
High School	
Municipal	NA
Private	Within distance less than 0.5 km
State Government	0.5 to 1.0 kms
Adult Education Centre	Within Slum
Health Facilities	Around slum
Urban Health Post	1.0 to 2.0 kms
Primary Health Centre	More than 5.0 kms
Government Hospital	More than 5.0 kms
Maternity Centre	1.0 to 2.0 kms
Private Clinic	NA
Registered Medical Practitioner (RMP)	NA
Ayurvedic Doctor/Vaidya	NA
Social Development/Welfare	Within Slum
Community Hall	NA
Livelihood/Production Centre	NA
Vocational Training/Training cum Production Centre	NA
Street Children Rehabilitation Centre	NA
Night Shelter	NA
Old Age Home	NA
Self Help Groups/DWCUA Groups in Slum	NA
No. of Neighbourhoods Groups (NHGs) in slum	1
Slum-dwellers Association	NA

Youth Association	1
Women's Association/Mahila Samithis	NA

6. CHANDI CHARAN BANERJEE LANE

Education & Social Infrastructure	
Pre-primary School	
Anganwadi under ICDS	NA
Municipal Pre-school	NA
Private Pre-school	NA
Primary School	
Municipal	NA
State Government	NA
Private	NA
High School	
Municipal	NA
Private	NA
State Government	NA
Adult Education Centre	NA
Health Facilities	NA
Urban Health Post	NA
Primary Health Centre	NA
Government Hospital	NA
Maternity Centre	NA
Private Clinic	NA
Registered Medical Practitioner (RMP)	NA
Ayurvedic Doctor/Vaidya	NA
Social Development/Welfare	NA
Community Hall	NA
Livelihood/Production Centre	NA
Vocational Training/Training cum Production Centre	NA

Street Children Rehabilitation Centre	NA
Night Shelter	NA
Old Age Home	NA
Self Help Groups/DWCUA Groups in Slum	NA
No. of Neighbourhoods Groups (NHGs) in slum	0
Slum-dwellers Association	NA
Youth Association	0
Women's Association/Mahila Samithis	NA

7. S.D.MUKHERJEE AND N.S. ROAD

Education & Social Infrastructure	
Pre-primary School	
Anganwadi under ICDS	Within Slum
Municipal Pre-school	NA
Private Pre-school	NA
Primary School	
Municipal	Within distance less than 0.5 km
State Government	NA
Private	NA
High School	
Municipal	NA
Private	NA
State Government	Within distance less than 0.5 km
Adult Education Centre	NA
Health Facilities	Around slum
Urban Health Post	Within Slum
Primary Health Centre	2.0 to 5.0 kms
Government Hospital	NA
Maternity Centre	0.5 to 1.0 kms
Private Clinic	NA

Registered Medical Practitioner (RMP)	NA
Ayurvedic Doctor/Vaidya	NA
Social Development/Welfare	Within Slum
Community Hall	Within Slum
Livelihood/Production Centre	NA
Vocational Training/Training cum Production Centre	NA
Street Children Rehabilitation Centre	NA
Night Shelter	NA
Old Age Home	NA
Self Help Groups/DWCUA Groups in Slum	NA
No. of Neighbourhoods Groups (NHGs) in slum	2
Slum-dwellers Association	NA
Youth Association	NA
Women's Association/Mahila Samithis	NA

8. K.B.SAHA ROAD AND N.S. ROAD

Education & Social Infrastructure	
Pre-primary School	
Anganwadi under ICDS	Within Slum
Municipal Pre-school	NA
Private Pre-school	Within distance less than 0.5 km
Primary School	
Municipal	NA
State Government	Within Slum
Private	Within Slum
High School	
Municipal	NA
Private	NA
State Government	NA
Adult Education Centre	NA

Health Facilities	Around slum
Urban Health Post	Within distance less than 0.5 km
Primary Health Centre	More than 5.0 km
Government Hospital	More than 5.0 km
Maternity Centre	2.0 to 5.0 kms
Private Clinic	Within Slum
Registered Medical Practitioner (RMP)	Within distance less than 0.5 km
Ayurvedic Doctor/Vaidya	NA
Social Development/Welfare	Within Slum
Community Hall	Within distance less than 0.5 km
Livelihood/Production Centre	NA
Vocational Training/Training cum Production Centre	NA
Street Children Rehabilitation Centre	NA
Night Shelter	NA
Old Age Home	NA
Self Help Groups/DWCUA Groups in Slum	NA
No. of Neighbourhoods Groups (NHGs) in slum	1
Slum-dwellers Association	NA
Youth Association	2
Women's Association/Mahila Samithis	NA

9. K.C.DEY

Education & Social Infrastructure	
Pre-primary School	
Anganwadi under ICDS	Within distance less than 0.5 km
Municipal Pre-school	NA
Private Pre-school	Within distance less than 0.5 km
Primary School	
Municipal	NA
State Government	Within distance less than 0.5 km

Private	Within distance less than 0.5 km
High School	
Municipal	NA
Private	NA
State Government	Within distance less than 0.5 km
Adult Education Centre	Within distance less than 0.5 km
Health Facilities	NA
Urban Health Post	NA
Primary Health Centre	More than 5.0 km
Government Hospital	More than 5.0 km
Maternity Centre	More than 5.0 km
Private Clinic	NA
Registered Medical Practitioner (RMP)	Within Slum
Ayurvedic Doctor/Vaidya	NA
Social Development/Welfare	NA
Community Hall	0.5 to 1.0 kms
Livelihood/Production Centre	NA
Vocational Training/Training cum Production Centre	NA
Street Children Rehabilitation Centre	NA
Night Shelter	NA
Old Age Home	NA
Self Help Groups/DWCUA Groups in Slum	0
No. of Neighbourhoods Groups (NHGs) in slum	1
Slum-dwellers Association	0
Youth Association	2
Women's Association/Mahila Samithis	0

10. PANCHANANTOLLA

Education & Social Infrastructure	
Pre-primary School	
Anganwadi under ICDS	Within distance less than 0.5 km
Municipal Pre-school	NA
Private Pre-school	Within distance less than 0.5 km
Primary School	
Municipal	NA
State Government	Within distance less than 0.5 km
Private	Within distance less than 0.5 km
High School	
Municipal	NA
Private	NA
State Government	Within distance less than 0.5 km
Adult Education Centre	Within distance less than 0.5 km
Health Facilities	NA
Urban Health Post	NA
Primary Health Centre	More than 5.0 km
Government Hospital	More than 5.0 km
Maternity Centre	More than 5.0 km
Private Clinic	NA
Registered Medical Practitioner (RMP)	Within Slum
Ayurvedic Doctor/Vaidya	NA
Social Development/Welfare	NA
Community Hall	0.5 to 1.0 kms
Livelihood/Production Centre	NA
Vocational Training/Training cum Production Centre	NA
Street Children Rehabilitation Centre	NA
Night Shelter	NA
Old Age Home	NA

Self Help Groups/DWCUA Groups in Slum	0
No. of Neighbourhoods Groups (NHGs) in slum	1
Slum-dwellers Association	0
Youth Association	2
Women's Association/Mahila Samithis	0

11. D.D.HAR LANE

Education & Social Infrastructure	
Pre-primary School	
Anganwadi under ICDS	Within distance less than 0.5 km
Municipal Pre-school	NA
Private Pre-school	Within distance less than 0.5 km
Primary School	
Municipal	NA
State Government	Within distance less than 0.5 km
Private	Within distance less than 0.5 km
High School	
Municipal	NA
Private	NA
State Government	Within distance less than 0.5 km
Adult Education Centre	Within distance less than 0.5 km
Health Facilities	NA
Urban Health Post	NA
Primary Health Centre	More than 5.0 km
Government Hospital	More than 5.0 km
Maternity Centre	More than 5.0 km
Private Clinic	Within Slum
Registered Medical Practitioner (RMP)	NA
Ayurvedic Doctor/Vaidya	NA

Social Development/Welfare	NA
Community Hall	0.5 to 1.0 kms
Livelihood/Production Centre	NA
Vocational Training/Training cum Production Centre	NA
Street Children Rehabilitation Centre	NA
Night Shelter	NA
Old Age Home	NA
Self Help Groups/DWCUA Groups in Slum	0
No. of Neighbourhoods Groups (NHGs) in slum	0
Slum-dwellers Association	0
Youth Association	2
Women's Association/Mahila Samithis	0

12. SITALATOLLA

Education & Social Infrastructure	
Pre-primary School	
Anganwadi under ICDS	Within distance less than 0.5 km
Municipal Pre-school	NA
Private Pre-school	Within distance less than 0.5 km
Primary School	
Municipal	NA
State Government	Within distance less than 0.5 km
Private	Within distance less than 0.5 km
High School	
Municipal	NA
Private	NA
State Government	Within distance less than 0.5 km
Adult Education Centre	Within distance less than 0.5 km
Health Facilities	NA

Urban Health Post	NA
Primary Health Centre	More than 5.0 km
Government Hospital	More than 5.0 km
Maternity Centre	More than 5.0 km
Private Clinic	NA
Registered Medical Practitioner (RMP)	Within the slum
Ayurvedic Doctor/Vaidya	NA
Social Development/Welfare	NA
Community Hall	0.5 to 1.0 kms
Livelihood/Production Centre	NA
Vocational Training/Training cum Production Centre	NA
Street Children Rehabilitation Centre	NA
Night Shelter	NA
Old Age Home	NA
Self Help Groups/DWCUA Groups in Slum	0
No. of Neighbourhoods Groups (NHGs) in slum	0
Slum-dwellers Association	0
Youth Association	2
Women's Association/Mahila Samithis	0

13. SASTITOLLA

Education & Social Infrastructure	
Pre-primary School	
Anganwadi under ICDS	NA
Municipal Pre-school	NA
Private Pre-school	NA
Primary School	
Municipal	NA
State Government	NA
Private	NA

High School	
Municipal	NA
Private	NA
State Government	NA
Adult Education Centre	NA
Health Facilities	Around slum
Urban Health Post	NA
Primary Health Centre	NA
Government Hospital	NA
Maternity Centre	NA
Private Clinic	NA
Registered Medical Practitioner (RMP)	NA
Ayurvedic Doctor/Vaidya	NA
Social Development/Welfare	Within Slum
Community Hall	NA
Livelihood/Production Centre	NA
Vocational Training/Training cum Production Centre	NA
Street Children Rehabilitation Centre	NA
Night Shelter	NA
Old Age Home	NA
Self Help Groups/DWCUA Groups in Slum	NA
No. of Neighbourhoods Groups (NHGs) in slum	1
Slum-dwellers Association	NA
Youth Association	NA
Women's Association/Mahila Samithis	NA

14. BIRINCHIPARA

Education & Social Infrastructure	
Pre-primary School	

Anganwadi under ICDS	Within distance less than 0.5 km
Municipal Pre-school	NA
Private Pre-school	Within distance less than 0.5 km
Primary School	
Municipal	0.5 to 1.0 kms
State Government	NA
Private	NA
High School	
Municipal	NA
Private	NA
State Government	0.5 to 1.0 kms
Adult Education Centre	NA
Health Facilities	Around slum
Urban Health Post	Within distance less than 0.5 km
Primary Health Centre	2.0 to 5.0 kms
Government Hospital	More than 5.0 kms
Maternity Centre	More than 5.0 kms
Private Clinic	NA
Registered Medical Practitioner (RMP)	NA
Ayurvedic Doctor/Vaidya	NA
Social Development/Welfare	Within Slum
Community Hall	1.0 to 2.0 kms
Livelihood/Production Centre	NA
Vocational Training/Training cum Production Centre	NA
Street Children Rehabilitation Centre	NA
Night Shelter	NA
Old Age Home	NA
Self Help Groups/DWCUA Groups in Slum	NA
No. of Neighbourhoods Groups (NHGs) in slum	1

Slum-dwellers Association	NA
Youth Association	NA
Women's Association/Mahila Samithis	NA

15. BEHIND RISHRA HIGH SCHOOL

Education & Social Infrastructure	
Pre-primary School	
Anganwadi under ICDS	0.5 to 1.0 kms
Municipal Pre-school	NA
Private Pre-school	0.5 to 1.0 kms
Primary School	
Municipal	NA
State Government	0.5 to 1.0 kms
Private	NA
High School	
Municipal	NA
Private	NA
State Government	Within the slum
Adult Education Centre	With distance less than 0.5 kms
Health Facilities	Around slum
Urban Health Post	0.5 to 1.0 kms
Primary Health Centre	1.0 to 2.0 kms
Government Hospital	More than 5.0 kms
Maternity Centre	1.0 to 2.0 kms
Private Clinic	NA
Registered Medical Practitioner (RMP)	With distance less than 0.5 kms
Ayurvedic Doctor/Vaidya	NA
Social Development/Welfare	NA
Community Hall	With distance less than 0.5 kms
Livelihood/Production Centre	NA

Vocational Training/Training cum Production Centre	NA
Street Children Rehabilitation Centre	NA
Night Shelter	NA
Old Age Home	NA
Self Help Groups/DWCUA Groups in Slum	1
No. of Neighbourhoods Groups (NHGs) in slum	NA
Slum-dwellers Association	0
Youth Association	1
Women's Association/Mahila Samithis	1

16. BEHIND BURNING GHAT

Education & Social Infrastructure	
Pre-primary School	
Anganwadi under ICDS	Within the slum
Municipal Pre-school	NA
Private Pre-school	0.5 to 1.0 kms
Primary School	
Municipal	NA
State Government	With distance less than 0.5 kms
Private	0.5 to 1.0 kms
High School	
Municipal	NA
Private	NA
State Government	0.5 to 1.0 kms
Adult Education Centre	Within the slum
Health Facilities	Around slum
Urban Health Post	0.5 to 1.0 kms
Primary Health Centre	Morethan 5.0 kms
Government Hospital	More than 5.0 kms

Maternity Centre	1.0 to 2.0 kms
Private Clinic	NA
Registered Medical Practitioner (RMP)	0.5 to 1.0 kms
Ayurvedic Doctor/Vaidya	NA
Social Development/Welfare	NA
Community Hall	0.5 to 1.0 kms
Livelihood/Production Centre	NA
Vocational Training/Training cum Production Centre	NA
Street Children Rehabilitation Centre	NA
Night Shelter	NA
Old Age Home	NA
Self Help Groups/DWCUA Groups in Slum	0
No. of Neighbourhoods Groups (NHGs) in slum	NA
Slum-dwellers Association	1
Youth Association	1
Women's Association/Mahila Samithis	1

17. HARIPODDAR LANE

Education & Social Infrastructure	
Pre-primary School	
Anganwadi under ICDS	With distance less than 0.5 kms
Municipal Pre-school	NA
Private Pre-school	NA
Primary School	
Municipal	NA
State Government	With distance less than 0.5 kms
Private	NA
High School	

Municipal	NA
Private	NA
State Government	With distance less than 0.5 kms
Adult Education Centre	With distance less than 0.5 kms
Health Facilities	Around slum
Urban Health Post	0.5 to 1.0 kms
Primary Health Centre	More than 5.0 kms
Government Hospital	More than 5.0 kms
Maternity Centre	2.0 to 5.0 kms
Private Clinic	NA
Registered Medical Practitioner (RMP)	NA
Ayurvedic Doctor/Vaidya	NA
Social Development/Welfare	NA
Community Hall	With distance less than 0.5 kms
Livelihood/Production Centre	NA
Vocational Training/Training cum Production Centre	NA
Street Children Rehabilitation Centre	NA
Night Shelter	NA
Old Age Home	1.0 to 2.0 kms
Self Help Groups/DWCUA Groups in Slum	0
No. of Neighbourhoods Groups (NHGs) in slum	NA
Slum-dwellers Association	0
Youth Association	0
Women's Association/Mahila Samithis	1

18. BEHIND PREMMANDIR (BRAHMATOLLA)

Education & Social Infrastructure	
Pre-primary School	
Anganwadi under ICDS	Within Slum
Municipal Pre-school	NA

Private Pre-school	NA
Primary School	
Municipal	0.5 to 1.0 kms
State Government	NA
Private	Within distance less than 0.5 km
High School	
Municipal	NA
Private	NA
State Government	0.5 to 1.0 kms
Adult Education Centre	Within distance less than 0.5 km
Health Facilities	Around slum
Urban Health Post	Within Slum
Primary Health Centre	More than 5.0 kms
Government Hospital	More than 5.0 kms
Maternity Centre	2.0 to 5.0 kms
Private Clinic	NA
Registered Medical Practitioner (RMP)	Within Slum
Ayurvedic Doctor/Vaidya	NA
Social Development/Welfare	Within Slum
Community Hall	Within distance less than 0.5 km
Livelihood/Production Centre	NA
Vocational Training/Training cum Production Centre	NA
Street Children Rehabilitation Centre	NA
Night Shelter	NA
Old Age Home	NA
Self Help Groups/DWCUA Groups in Slum	NA
No. of Neighbourhoods Groups (NHGs) in slum	1
Slum-dwellers Association	NA
Youth Association	1

Women's Association/Mahila Samithis	1
--	----------

19. BAGKHAL BRICK FIELD

Education & Social Infrastructure	
Pre-primary School	
Anganwadi under ICDS	Within Slum
Municipal Pre-school	NA
Private Pre-school	0.5 to 1.0 kms
Primary School	
Municipal	NA
State Government	0.5 to 1.0 kms
Private	0.5 to 1.0 kms
High School	
Municipal	NA
Private	NA
State Government	0.5 to 1.0 kms
Adult Education Centre	Within the slum
Health Facilities	Around slum
Urban Health Post	With distance less than 0.5 kms
Primary Health Centre	More than 5.0 kms
Government Hospital	More than 5.0 kms
Maternity Centre	1.0 to 2.0 km
Private Clinic	NA
Registered Medical Practitioner (RMP)	NA
Ayurvedic Doctor/Vaidya	NA
Social Development/Welfare	NA
Community Hall	0.5 to 1.0 kms
Livelihood/Production Centre	NA
Vocational Training/Training cum Production Centre	NA
Street Children Rehabilitation Centre	NA

Night Shelter	NA
Old Age Home	0.5 to 1.0 kms
Self Help Groups/DWCUA Groups in Slum	0
No. of Neighbourhoods Groups (NHGs) in slum	NA
Slum-dwellers Association	0
Youth Association	0
Women's Association/Mahila Samithis	1

20. BAGKHAL

Education & Social Infrastructure	
Pre-primary School	
Anganwadi under ICDS	Within Slum
Municipal Pre-school	NA
Private Pre-school	NA
Primary School	
Municipal	NA
State Government	Within Slum
Private	NA
High School	
Municipal	NA
Private	NA
State Government	2.0 to 5.0 kms
Adult Education Centre	NA
Health Facilities	Around slum
Urban Health Post	Within Slum
Primary Health Centre	More than 5.0 kms
Government Hospital	More than 5.0 kms
Maternity Centre	More than 5.0 kms
Private Clinic	NA
Registered Medical Practitioner (RMP)	NA

Ayurvedic Doctor/Vaidya	NA
Social Development/Welfare	Within Slum
Community Hall	0.5 to 1.0 kms
Livelihood/Production Centre	NA
Vocational Training/Training cum Production Centre	NA
Street Children Rehabilitation Centre	NA
Night Shelter	NA
Old Age Home	NA
Self Help Groups/DWCUA Groups in Slum	NA
No. of Neighbourhoods Groups (NHGs) in slum	6
Slum-dwellers Association	NA
Youth Association	5
Women's Association/Mahila Samithis	NA

21. MOREPUKUR 1ST LANE

Education & Social Infrastructure	
Pre-primary School	
Anganwadi under ICDS	Within the slum
Municipal Pre-school	NA
Private Pre-school	NA
Primary School	
Municipal	NA
State Government	Within the slum
Private	NA
High School	
Municipal	NA
Private	NA
State Government	0.5 to 1.0 kms
Adult Education Centre	NA
Health Facilities	NA

Urban Health Post	NA
Primary Health Centre	NA
Government Hospital	More than 5.0 kms
Maternity Centre	0.5 to 1.0 kms
Private Clinic	NA
Registered Medical Practitioner (RMP)	Within the slum
Ayurvedic Doctor/Vaidya	NA
Social Development/Welfare	NA
Community Hall	With distance less than 0.5 kms
Livelihood/Production Centre	NA
Vocational Training/Training cum Production Centre	NA
Street Children Rehabilitation Centre	NA
Night Shelter	NA
Old Age Home	NA
Self Help Groups/DWCUA Groups in Slum	0
No. of Neighbourhoods Groups (NHGs) in slum	NA
Slum-dwellers Association	0
Youth Association	1
Women's Association/Mahila Samithis	0

22. DASPARA

Education & Social Infrastructure	
Pre-primary School	
Anganwadi under ICDS	Within distance less than 0.5 km
Municipal Pre-school	NA
Private Pre-school	Within distance less than 0.5 km
Primary School	
Municipal	Within distance less than 0.5 km
State Government	NA
Private	Within distance less than 0.5 km

High School	
Municipal	NA
Private	NA
State Government	0.5 to 1.0 kms
Adult Education Centre	NA
Health Facilities	Around slum
Urban Health Post	NA
Primary Health Centre	NA
Government Hospital	More than 5.0 kms
Maternity Centre	1.0 to 2.0 kms
Private Clinic	Within Slum
Registered Medical Practitioner (RMP)	Within Slum
Ayurvedic Doctor/Vaidya	NA
Social Development/Welfare	Within Slum
Community Hall	Within distance less than 0.5 km
Livelihood/Production Centre	NA
Vocational Training/Training cum Production Centre	NA
Street Children Rehabilitation Centre	NA
Night Shelter	NA
Old Age Home	NA
Self Help Groups/DWCUA Groups in Slum	NA
No. of Neighbourhoods Groups (NHGs) in slum	1
Slum-dwellers Association	NA
Youth Association	2
Women's Association/Mahila Samithis	NA

23. ANUBHAVA ASSEMBLY HALL

Education & Social Infrastructure	
Pre-primary School	
Anganwadi under ICDS	With distance less than 0.5 kms

Municipal Pre-school	NA
Private Pre-school	With distance less than 0.5 kms
Primary School	
Municipal	Within distance less than 0.5 km
State Government	NA
Private	NA
High School	
Municipal	NA
Private	NA
State Government	Within distance less than 0.5 km
Adult Education Centre	NA
Health Facilities	Around slum
Urban Health Post	NA
Primary Health Centre	With distance less than 0.5 kms
Government Hospital	More than 5.0 kms
Maternity Centre	0.5 to 1.0 kms
Private Clinic	With distance less than 0.5 kms
Registered Medical Practitioner (RMP)	With distance less than 0.5 kms
Ayurvedic Doctor/Vaidya	NA
Social Development/Welfare	NA
Community Hall	Within the slum
Livelihood/Production Centre	NA
Vocational Training/Training cum Production Centre	NA
Street Children Rehabilitation Centre	NA
Night Shelter	NA
Old Age Home	NA
Self Help Groups/DWCUA Groups in Slum	0
No. of Neighbourhoods Groups (NHGs) in slum	NA
Slum-dwellers Association	0

Youth Association	3
Women's Association/Mahila Samithis	0

24. SADHANKANAN

Education & Social Infrastructure	
Pre-primary School	
Anganwadi under ICDS	Within the slum
Municipal Pre-school	NA
Private Pre-school	Within the slum
Primary School	
Municipal	NA
State Government	Within the slum
Private	Within the slum
High School	
Municipal	NA
Private	NA
State Government	0.5 to 1.0 kms
Adult Education Centre	NA
Health Facilities	Around slum
Urban Health Post	With distance less than 0.5 kms
Primary Health Centre	More than 5.0 kms
Government Hospital	More than 5.0 kms
Maternity Centre	With distance less than 0.5 kms
Private Clinic	Within the slum
Registered Medical Practitioner (RMP)	Within the slum
Ayurvedic Doctor/Vaidya	NA
Social Development/Welfare	NA
Community Hall	With distance less than 0.5 kms
Livelihood/Production Centre	NA

Vocational Training/Training cum Production Centre	NA
Street Children Rehabilitation Centre	NA
Night Shelter	NA
Old Age Home	NA
Self Help Groups/DWCUA Groups in Slum	0
No. of Neighbourhoods Groups (NHGs) in slum	NA
Slum-dwellers Association	0
Youth Association	2
Women's Association/Mahila Samithis	0

25. KISHORE SANGHA

Education & Social Infrastructure	
Pre-primary School	
Anganwadi under ICDS	Within Slum
Municipal Pre-school	Within Slum
Private Pre-school	NA
Primary School	
Municipal	Within Slum
State Government	Within Slum
Private	NA
High School	
Municipal	NA
Private	NA
State Government	Within Slum
Adult Education Centre	NA
Health Facilities	Around slum
Urban Health Post	NA
Primary Health Centre	More than 5.0 kms
Government Hospital	2.0 to 5.0 kms

Maternity Centre	1.0 to 2.0 kms
Private Clinic	Within distance less than 0.5 km
Registered Medical Practitioner (RMP)	Within distance less than 0.5 km
Ayurvedic Doctor/Vaidya	NA
Social Development/Welfare	Within Slum
Community Hall	NA
Livelihood/Production Centre	NA
Vocational Training/Training cum Production Centre	NA
Street Children Rehabilitation Centre	NA
Night Shelter	NA
Old Age Home	NA
Self Help Groups/DWCUA Groups in Slum	NA
No. of Neighbourhoods Groups (NHGs) in slum	1
Slum-dwellers Association	NA
Youth Association	1
Women's Association/Mahila Samithis	NA

26. NAYABUSTEE

Education & Social Infrastructure	
Pre-primary School	
Anganwadi under ICDS	Within Slum
Municipal Pre-school	NA
Private Pre-school	Within Slum
Primary School	
Municipal	1.0 to 2.0 kms
State Government	Within Slum
Private	Within Slum
High School	
Municipal	NA
Private	Within Slum

State Government	Within Slum
Adult Education Centre	NA
Health Facilities	Around slum
Urban Health Post	Within Slum
Primary Health Centre	Within Slum
Government Hospital	More than 5.0 kms
Maternity Centre	1.0 to 2.0 kms
Private Clinic	NA
Registered Medical Practitioner (RMP)	NA
Ayurvedic Doctor/Vaidya	NA
Social Development/Welfare	Within Slum
Community Hall	1.0 to 2.0 kms
Livelihood/Production Centre	NA
Vocational Training/Training cum Production Centre	NA
Street Children Rehabilitation Centre	NA
Night Shelter	NA
Old Age Home	NA
Self Help Groups/DWCUA Groups in Slum	NA
No. of Neighbourhoods Groups (NHGs) in slum	5
Slum-dwellers Association	NA
Youth Association	NA
Women's Association/Mahila Samithis	NA

27. NAYABUSTEE

Education & Social Infrastructure	
Pre-primary School	
Anganwadi under ICDS	Within Slum
Municipal Pre-school	NA
Private Pre-school	Within Slum

Primary School	
Municipal	NA
State Government	NA
Private	Within Slum
High School	
Municipal	NA
Private	NA
State Government	Within Slum
Adult Education Centre	NA
Health Facilities	Around slum
Urban Health Post	NA
Primary Health Centre	Within Slum
Government Hospital	More than 5.0 kms
Maternity Centre	1.0 to 2.0 kms
Private Clinic	Within Slum
Registered Medical Practitioner (RMP)	Within Slum
Ayurvedic Doctor/Vaidya	NA
Social Development/Welfare	Within Slum
Community Hall	Within Slum
Livelihood/Production Centre	NA
Vocational Training/Training cum Production Centre	NA
Street Children Rehabilitation Centre	NA
Night Shelter	NA
Old Age Home	NA
Self Help Groups/DWCUA Groups in Slum	NA
No. of Neighbourhoods Groups (NHGs) in slum	14
Slum-dwellers Association	2
Youth Association	16
Women's Association/Mahila Samithis	NA

28. HARIR MATH & NITYANANDA PALLY

Education & Social Infrastructure	
Pre-primary School	
Anganwadi under ICDS	0.5 to 1.0 kms
Municipal Pre-school	NA
Private Pre-school	NA
Primary School	
Municipal	0.5 to 1.0 kms
State Government	0.5 to 1.0 kms
Private	NA
High School	
Municipal	NA
Private	NA
State Government	0.5 to 1.0 kms
Adult Education Centre	NA
Health Facilities	Around slum
Urban Health Post	0.5 to 1.0 kms
Primary Health Centre	More than 5.0 kms
Government Hospital	More than 5.0 kms
Maternity Centre	1.0 to 2.0 kms
Private Clinic	NA
Registered Medical Practitioner (RMP)	NA
Ayurvedic Doctor/Vaidya	NA
Social Development/Welfare	NA
Community Hall	1.0 to 2.0 kms
Livelihood/Production Centre	NA
Vocational Training/Training cum Production Centre	NA
Street Children Rehabilitation Centre	NA
Night Shelter	NA

Old Age Home	NA
Self Help Groups/DWCUA Groups in Slum	0
No. of Neighbourhoods Groups (NHGs) in slum	NA
Slum-dwellers Association	0
Youth Association	2
Women's Association/Mahila Samithis	0

29. NATUNGRAM PRIMARY SCHOOL

Education & Social Infrastructure	
Pre-primary School	
Anganwadi under ICDS	Within the slum
Municipal Pre-school	NA
Private Pre-school	NA
Primary School	
Municipal	0.5 to 1.0 kms
State Government	Within the slum
Private	NA
High School	
Municipal	NA
Private	NA
State Government	0.5 to 1.0 kms
Adult Education Centre	NA
Health Facilities	Around slum
Urban Health Post	0.5 to 1.0 kms
Primary Health Centre	More than 5.0 kms
Government Hospital	More than 5.0 kms
Maternity Centre	1.0 to 2.0 kms
Private Clinic	NA
Registered Medical Practitioner (RMP)	NA

Ayurvedic Doctor/Vaidya	NA
Social Development/Welfare	NA
Community Hall	1.0 to 2.0 kms
Livelihood/Production Centre	NA
Vocational Training/Training cum Production Centre	NA
Street Children Rehabilitation Centre	NA
Night Shelter	NA
Old Age Home	NA
Self Help Groups/DWCUA Groups in Slum	0
No. of Neighbourhoods Groups (NHGs) in slum	NA
Slum-dwellers Association	0
Youth Association	0
Women's Association/Mahila Samithis	0

30. HOTELWALA GOLI

Education & Social Infrastructure	
Pre-primary School	
Anganwadi under ICDS	0.5 to 1.0 kms
Municipal Pre-school	NA
Private Pre-school	NA
Primary School	
Municipal	1.0 to 2.0 kms
State Government	0.5 to 1.0 kms
Private	With distance less than 0.5 kms
High School	
Municipal	NA
Private	NA
State Government	0.5 to 1.0 kms
Adult Education Centre	NA

Health Facilities	Around slum
Urban Health Post	0.5 to 1.0 kms
Primary Health Centre	More than 5.0 kms
Government Hospital	More than 5.0 kms
Maternity Centre	0.5 to 1.0 kms
Private Clinic	NA
Registered Medical Practitioner (RMP)	NA
Ayurvedic Doctor/Vaidya	NA
Social Development/Welfare	NA
Community Hall	0.5 to 1.0 kms
Livelihood/Production Centre	NA
Vocational Training/Training cum Production Centre	NA
Street Children Rehabilitation Centre	NA
Night Shelter	NA
Old Age Home	NA
Self Help Groups/DWCUA Groups in Slum	0
No. of Neighbourhoods Groups (NHGs) in slum	NA
Slum-dwellers Association	0
Youth Association	0
Women's Association/Mahila Samithis	0

31. AAM BAGAN

Education & Social Infrastructure	
Pre-primary School	
Anganwadi under ICDS	NA
Municipal Pre-school	NA
Private Pre-school	NA
Primary School	
Municipal	NA
State Government	NA

Private	NA
High School	
Municipal	NA
Private	NA
State Government	NA
Adult Education Centre	NA
Health Facilities	Around slum
Urban Health Post	NA
Primary Health Centre	NA
Government Hospital	NA
Maternity Centre	NA
Private Clinic	NA
Registered Medical Practitioner (RMP)	NA
Ayurvedic Doctor/Vaidya	NA
Social Development/Welfare	Within Slum
Community Hall	NA
Livelihood/Production Centre	NA
Vocational Training/Training cum Production Centre	NA
Street Children Rehabilitation Centre	NA
Night Shelter	NA
Old Age Home	NA
Self Help Groups/DWCUA Groups in Slum	NA
No. of Neighbourhoods Groups (NHGs) in slum	1
Slum-dwellers Association	NA
Youth Association	NA
Women's Association/Mahila Samithis	NA

32. BURMANPARA

Education & Social Infrastructure
Pre-primary School

Anganwadi under ICDS	NA
Municipal Pre-school	NA
Private Pre-school	NA
Primary School	
Municipal	NA
State Government	NA
Private	NA
High School	
Municipal	NA
Private	NA
State Government	NA
Adult Education Centre	NA
Health Facilities	NA
Urban Health Post	NA
Primary Health Centre	NA
Government Hospital	NA
Maternity Centre	NA
Private Clinic	NA
Registered Medical Practitioner (RMP)	NA
Ayurvedic Doctor/Vaidya	NA
Social Development/Welfare	NA
Community Hall	NA
Livelihood/Production Centre	NA
Vocational Training/Training cum Production Centre	NA
Street Children Rehabilitation Centre	NA
Night Shelter	NA
Old Age Home	NA
Self Help Groups/DWCUA Groups in Slum	NA
No. of Neighbourhoods Groups (NHGs) in slum	NA

Slum-dwellers Association	NA
Youth Association	NA
Women's Association/Mahila Samithis	NA

33. BALAKSANGHA MATH

Education & Social Infrastructure	
Pre-primary School	
Anganwadi under ICDS	NA
Municipal Pre-school	NA
Private Pre-school	NA
Primary School	
Municipal	NA
State Government	NA
Private	NA
High School	
Municipal	NA
Private	NA
State Government	NA
Adult Education Centre	NA
Health Facilities	NA
Urban Health Post	NA
Primary Health Centre	NA
Government Hospital	NA
Maternity Centre	NA
Private Clinic	NA
Registered Medical Practitioner (RMP)	NA
Ayurvedic Doctor/Vaidya	NA
Social Development/Welfare	NA
Community Hall	NA

Livelihood/Production Centre	NA
Vocational Training/Training cum Production Centre	NA
Street Children Rehabilitation Centre	NA
Night Shelter	NA
Old Age Home	NA
Self Help Groups/DWCUA Groups in Slum	NA
No. of Neighbourhoods Groups (NHGs) in slum	NA
Slum-dwellers Association	NA
Youth Association	NA
Women's Association/Mahila Samithis	NA

34. SUBHASH NAGAR

Education & Social Infrastructure	
Pre-primary School	
Anganwadi under ICDS	Within Slum
Municipal Pre-school	Within distance less than 0.5 km
Private Pre-school	Within Slum
Primary School	
Municipal	Within distance less than 0.5 km
State Government	Within Slum
Private	Within distance less than 0.5 km
High School	
Municipal	NA
Private	NA
State Government	Within distance less than 0.5 km
Adult Education Centre	NA
Health Facilities	Around slum
Urban Health Post	NA
Primary Health Centre	Within Slum
Government Hospital	NA

Maternity Centre	Within distance less than 0.5 km
Private Clinic	Within Slum
Registered Medical Practitioner (RMP)	Within distance less than 0.5 km
Ayurvedic Doctor/Vaidya	1.0 to 2.0 kms
Social Development/Welfare	Within Slum
Community Hall	Within Slum
Livelihood/Production Centre	NA
Vocational Training/Training cum Production Centre	NA
Street Children Rehabilitation Centre	NA
Night Shelter	NA
Old Age Home	NA
Self Help Groups/DWCUA Groups in Slum	NA
No. of Neighbourhoods Groups (NHGs) in slum	3
Slum-dwellers Association	2
Youth Association	1
Women's Association/Mahila Samithis	NA

35. NABINPALLY

Education & Social Infrastructure	
Pre-primary School	
Anganwadi under ICDS	Within Slum
Municipal Pre-school	NA
Private Pre-school	NA
Primary School	
Municipal	NA
State Government	Within distance less than 0.5 km
Private	Within Slum
High School	
Municipal	NA
Private	NA

State Government	Within distance less than 0.5 km
Adult Education Centre	NA
Health Facilities	Around slum
Urban Health Post	Within distance less than 0.5 km
Primary Health Centre	More than 5.0 kms
Government Hospital	More than 5.0 kms
Maternity Centre	More than 5.0 kms
Private Clinic	NA
Registered Medical Practitioner (RMP)	NA
Ayurvedic Doctor/Vaidya	NA
Social Development/Welfare	Within Slum
Community Hall	NA
Livelihood/Production Centre	NA
Vocational Training/Training cum Production Centre	NA
Street Children Rehabilitation Centre	NA
Night Shelter	NA
Old Age Home	NA
Self Help Groups/DWCUA Groups in Slum	1
No. of Neighbourhoods Groups (NHGs) in slum	1
Slum-dwellers Association	NA
Youth Association	1
Women's Association/Mahila Samithis	NA

36. SUBHASHNAGAR RAILPARK

Education & Social Infrastructure	
Pre-primary School	
Anganwadi under ICDS	With distance less than 0.5 kms
Municipal Pre-school	NA
Private Pre-school	NA
Primary School	

Municipal	NA
State Government	With distance less than 0.5 kms
Private	Within Slum
High School	
Municipal	NA
Private	NA
State Government	0.5 to 1.0 kms
Adult Education Centre	NA
Health Facilities	Around slum
Urban Health Post	With distance less than 0.5 kms
Primary Health Centre	More than 5.0 kms
Government Hospital	More than 5.0 kms
Maternity Centre	1.0 to 2.0 kms
Private Clinic	NA
Registered Medical Practitioner (RMP)	With distance less than 0.5 kms
Ayurvedic Doctor/Vaidya	NA
Social Development/Welfare	NA
Community Hall	NA
Livelihood/Production Centre	NA
Vocational Training/Training cum Production Centre	NA
Street Children Rehabilitation Centre	NA
Night Shelter	NA
Old Age Home	NA
Self Help Groups/DWCUA Groups in Slum	0
No. of Neighbourhoods Groups (NHGs) in slum	NA
Slum-dwellers Association	0
Youth Association	1
Women's Association/Mahila Samithis	0

37. LUXMIPALLY

Education & Social Infrastructure	
Pre-primary School	
Anganwadi under ICDS	With distance less than 0.5 kms
Municipal Pre-school	NA
Private Pre-school	NA
Primary School	
Municipal	NA
State Government	Within the slum
Private	NA
High School	
Municipal	NA
Private	NA
State Government	With distance less than 0.5 kms
Adult Education Centre	NA
Health Facilities	Around slum
Urban Health Post	Within the slum
Primary Health Centre	More than 5.0 kms
Government Hospital	More than 5.0 kms
Maternity Centre	1.0 to 2.0 kms
Private Clinic	Within the slum
Registered Medical Practitioner (RMP)	Within the slum
Ayurvedic Doctor/Vaidya	NA
Social Development/Welfare	NA
Community Hall	Within the slum
Livelihood/Production Centre	NA
Vocational Training/Training cum Production Centre	NA
Street Children Rehabilitation Centre	NA
Night Shelter	NA

Old Age Home	NA
Self Help Groups/DWCUA Groups in Slum	0
No. of Neighbourhoods Groups (NHGs) in slum	NA
Slum-dwellers Association	0
Youth Association	1
Women's Association/Mahila Samithis	0

38. SUBHASHNAGAR GOVT. COLONEY BACK SIDE OF WBSEB

Education & Social Infrastructure	
Pre-primary School	
Anganwadi under ICDS	Within Slum
Municipal Pre-school	NA
Private Pre-school	Within Slum
Primary School	
Municipal	NA
State Government	NA
Private	NA
High School	
Municipal	NA
Private	NA
State Government	2.0 to 5.0 kms
Adult Education Centre	NA
Health Facilities	Around slum
Urban Health Post	Within distance less than 0.5 km
Primary Health Centre	More than 5.0 kms
Government Hospital	More than 5.0 kms
Maternity Centre	0.5 to 1.0 km
Private Clinic	NA
Registered Medical Practitioner (RMP)	NA
Ayurvedic Doctor/Vaidya	NA

Social Development/Welfare	Within Slum
Community Hall	0.5 to 1.0 km
Livelihood/Production Centre	NA
Vocational Training/Training cum Production Centre	NA
Street Children Rehabilitation Centre	NA
Night Shelter	NA
Old Age Home	NA
Self Help Groups/DWCUA Groups in Slum	NA
No. of Neighbourhoods Groups (NHGs) in slum	1
Slum-dwellers Association	NA
Youth Association	1
Women's Association/Mahila Samithis	NA

39. PALTEPARA

Education & Social Infrastructure	
Pre-primary School	
Anganwadi under ICDS	Within Slum
Municipal Pre-school	0.5 to 1.0 kms
Private Pre-school	1.0 to 2.0 kms
Primary School	
Municipal	1.0 to 2.0 kms
State Government	0.5 to 1.0 kms
Private	1.0 to 2.0 kms
High School	
Municipal	NA
Private	NA
State Government	1.0 to 2.0 kms
Adult Education Centre	NA
Health Facilities	Around slum

Urban Health Post	NA
Primary Health Centre	Within Slum
Government Hospital	More than 5.0 kms
Maternity Centre	0.5 to 1.0 kms
Private Clinic	Within Slum
Registered Medical Practitioner (RMP)	Within distance less than 0.5 km
Ayurvedic Doctor/Vaidya	Within Slum
Social Development/Welfare	Within Slum
Community Hall	Within distance less than 0.5 km
Livelihood/Production Centre	NA
Vocational Training/Training cum Production Centre	NA
Street Children Rehabilitation Centre	NA
Night Shelter	NA
Old Age Home	NA
Self Help Groups/DWCUA Groups in Slum	NA
No. of Neighbourhoods Groups (NHGs) in slum	1
Slum-dwellers Association	1
Youth Association	1
Women's Association/Mahila Samithis	1

40. BAGPARA

Education & Social Infrastructure	
Pre-primary School	
Anganwadi under ICDS	Within the slum
Municipal Pre-school	0.5 to 1.0 kms
Private Pre-school	1.0 to 2.0 kms
Primary School	
Municipal	1.0 to 2.0 kms
State Government	0.5 to 1.0 kms
Private	1.0 to 2.0 kms

High School	
Municipal	NA
Private	NA
State Government	1.0 to 2.0 kms
Adult Education Centre	NA
Health Facilities	NA
Urban Health Post	NA
Primary Health Centre	Within Slum
Government Hospital	More than 5.0 kms
Maternity Centre	0.5 to 1.0 kms
Private Clinic	Within Slum
Registered Medical Practitioner (RMP)	Within distance less than 0.5 km
Ayurvedic Doctor/Vaidya	Within distance less than 0.5 km
Social Development/Welfare	NA
Community Hall	Within distance less than 0.5 km
Livelihood/Production Centre	NA
Vocational Training/Training cum Production Centre	NA
Street Children Rehabilitation Centre	NA
Night Shelter	NA
Old Age Home	NA
Self Help Groups/DWCUA Groups in Slum	0
No. of Neighbourhoods Groups (NHGs) in slum	NA
Slum-dwellers Association	0
Youth Association	0
Women's Association/Mahila Samithis	0

MAP

MAP

Executive Summary

Project Details

1	State	:	West Bengal
2	City	:	Rishra Municipality
3	Project Name	:	Pradhan Mantri Awas Yojana Housing for All (Urban)
4	Project Cost	:	7453.51
5	Central Share	:	2763.00
6	State Share	:	3891.23
7	ULB Share	:	338.79
8	Beneficiary Share	:	460.50
9	Total Infrastructure cost	:	677.57
10	Percentage of Infrastructure cost of Housing Cost	:	10.00 %
11	Infrastructure cost per dwelling unit	:	0.3678
12	Year of Implementation	:	2017-18
13	Component Housing construction	:	Beneficiary Led Construction (BLC)
14	SOR Adopted	:	PWD (WB) w.e.f 1.7.14 with current corrigendum.

 Chairman
 Rishra Municipality

Project Contributions (Physical + Financial) (Rs. In lacs)

SI No.	Scheme Component	Type	Quantity	Unit	Rate (in Rs./unit)	Proposed project cost (in lakh)	Appraised Project Cost (in lakh)	Central Share (@ Rs. 1.5 Lac/D.U.)	State Govt. Share (@Rs.1.92858 Lac/D.U.)	ULB Share	Beneficiaries Share (@ Rs. 0.25 Lac/D.U.)
A. HOUSING											
1	New in- situ										
	Single storied units		1842	Nos.	367858.00	6775.94	6775.94	2763.00	3552.44	0.00	460.50
	Total Housing Cost Sub Total (A)					6775.94	6775.94	2763.00	3552.44	0.00	460.50
B. INFRASTRUCTURE											
SI No.	Scheme Component	Type	Quantity	Unit	Rate (in Rs./unit)	Proposed project cost (in lakh)	Appraised Project Cost (in lakh)	Central Share (in lakh)	State Govt. Share (@ 50%) (in lakh)	ULB Share (@ 50%) (in lakh)	Beneficiaries Share (in lakh)
1	Roads										
i	BT Roads	Bituminous	26739	Sqm	612.00	163.64	163.64	0.00	81.82	81.82	0.00

ii	CC Roads	Cement Concrete	14825	Sqm	1736.00	257.36	257.36	0.00	128.68	128.68	0.00
2	Water Supply										
i	Pipeline (Dist)	100 mm dia. Dist. (DI)	0	Mtr	1066.00	0.00	0.00	0.00	0.00	0.00	0.00
3	Storm Water Drains										
i	Surface drain	Brick Masonry	10101	Mtr	2540.00	256.57	256.57	0.00	128.28	128.28	0.00
Total Infrastructure Cost Sub Total (B)						677.57	677.57	0.00	338.79	338.79	0.00
Grand Total (A+B)						7453.51	7453.51	2763.00	3891.23	338.79	460.50

Dipankar Choudhuri

Signature of the State Level Competent
Name & Designation: ~~Municipal Engineer~~ A.E. Rishra
Municipality

Address: 49/56/57 Rabindra Sartani Rishra P.O. & P.S. Rishra
Dist: Hooghly Pin: 712248

Fax No: + 91-033-2672 0306

Telephone No.: + 91-033-2672-2953

Mobile No.: 9830526570

E-mail: rishramunicipality@yahoo.com

Signature of the State Level Competent Technical Officer
Name & Designation: Amit Das, Chief Engineer, Municipal Engineering
Dte. Govt. of West Bengal

Address: Bilkash Bhawan, South Block, 1st Floor, Salt lake,
Kolkata - 7000 91

Fax No: +91- 33- 23375474

Telephone No.: +91-33-23371331

Mobile No.: (0)9475825219

E-mail: ce_medite@yahoo.com

Chairman
Rishra Municipality.

Signature of the State Level Nodal Officer
Name & Designation: Sri M.N. Pradhan, IAS
Director, SUDA

Address: State Urban Development Agency

Fax No: 91-33-23585767

Telephone No: + 91-33-23585767

Mobile No.: (0) 9830031488

E-Mail: wbsudadir@gmail.com

Signature of the Chairman / CEO/Commissioner of ULB/
Name & Designation: Shankar Prasad Shaw, Chairman, Rishra
Municipality

Address: 49/56/57 Rabindra Sartani Rishra P.O. & P.S. Rishra Dist
Hooghly Pin: 712248

Fax No.: + 91-033-2672-0306

Telephone No.: + 91-033-2672-2953

Mobile No.: (0)9830094712

E-mail No.: rishramunicipality@yahoo.com

FUND FLOW PATTERN

Rupees in lakhs

NAME OF THE SCHEME	ESTIMATED COST	YEAR 2017-18			
		GOI	GOWB	ULB	Beneficiaries
PMAY project - , Rishra Municipality	7453.51	2763.00	3891.23	338.79	460.50
					7453.52

Chairman
Rishra Municipality

PHASING OF FUND

Rupees in lakhs

YEAR 2016-17	RELEASE OF FUND				
	GOI	GOWB	ULB	Beneficiaries	TOTAL
1st Installment @ 40%	1105.20	1556.49	135.52	460.50	3257.71
2nd Installment @ 40%	1105.20	1556.49	135.52	0.00	2797.21
3rd Installment @ 20%	552.60	778.25	67.76	0.00	1398.60
TOTAL	2763.00	3891.23	338.79	460.50	7453.52

REQUIREMENT OF FUND

Rupees in lakhs

SL. NO	NAME OF THE SCHEME	YEAR 2017-18	TOTAL
1	PMAY project - , Rishra Municipality	7453.52	7453.52
Total		7453.52	7453.52

Format for Project under Beneficiary led Construction or Enhancement

1	Name of the State		WEST BENGAL					
2	Name of the City		RISHRA					
3	Project Name		HOUSING FOR ALL					
4	Project Code		19801729014					
5	State Level Nodal Agency		SUDA					
6	Implementing Agency / ULB'		RISHRA MUNICIPALITY					
7	Date of approval by State Level sanctioning and Monitoring Committee (SLSMC)							
8	Project Cost (Rs in Lakhs)		7453.51					
9	No of Beneficiaries covered in the project		Gen	SC	ST	OBC	Minority	Total
			1406	102	4	148	182	1842
10	(i) No of Beneficiary (New Construction)		1842					
	(ii) No of Beneficiary (Enhancement)		NIL					
11	Whether selected beneficiaries have rightful owner ship of the land?		Yes					
12	Whether the building plan for all houses have been approved?		If required , ULB will approved the Plan					
13	(i) G.O.I grant required (Rs. 1.5 lakh per eligible beneficiary) (Rs. in lakhs)		2763.00					
	(ii) State grant if any (Rs. in lakhs)		3891.23					
	(iii) ULB grant if anybody (Rs. in lakhs)		338.79					
	(iv) Beneficiary Share (Rs. in lakhs)		460.50					
	(v) Total (Rs. In lakhs)		7453.52					
14	Whether technical specification / design for housing have been ensured as per Indian standards /NBC/State norms?		Yes					
15	Whether disaster (earth quick, flood, cyclone, land slide etc.) resistance features have been adopted in concept design and implementation?		Yes					
16	Brief of project including any other information ULB/State would like to furnish.							

*State will give code number to each project sanctioned under HFA as 'ABCDEFGHJK'

(Where 'AB' is State Code as per census 'CDEFGH' is city code as per census 'IJ' is running number of project of the city and 'K' is project component code i.e. 'k' will be i-for in0situ- slum redevelopment 2 -for Relocation 3 for AHP and 4-for Beneficiary -led-Construction

It is hereby confirmed that State /UT/ and ULB have checked all the beneficiaries as per guideline of HFA. It is also submitted that no beneficiary has been selected for more than one benefit under the Mission including Credit Linked Subsidy Scheme (CLSS) component of the Mission.

Signature
(State Level Nodal Officer)

Signature
(Secretary / Principal Secretary, Concerned Department)

Chairman
Rishra Municipality

SLUM WISE DETAILS OF DU AND INFRASTRUCTURE COST OF 2017-18

Slum No.	Name of Slum	Slum Code	Area SqKm	Population	Dwelling Units (@ Rs. 3.67858 Lakh/ each)		Drainage (M) (Rs.2540.00/M) (Section -400x400)		Pipe Line @ Rs.1066.00 /M		Bituminous Roads (@ Rs. 612.00/Sq.M)		Concrete Roads (@ Rs. 1736.00/Sq.M)		Total cost of Infrastruct ure @ 10% of D.U. cost Rs. In Lac	Grand Total (Rs. In lakh)
					Qty.	Amt. (in Lakh)	Qty.	Amt. (in Lakh)	Qty.	Amt. (in Lakh)	Qty.	Amt. (in Lakh)	Qty.	Amt. (in Lakh)		
1	RISHRA BUSTEE(4)	4	0.30	6965	69	253.82	378	9.61	0	0.00	1002	6.13	555	9.64	25.38	279.20
2	RISHRA BUSTEE(5)	5	0.03	4324	67	246.46	367	9.33	0	0.00	973	5.95	539	9.36	24.65	271.11
3	RISHRA BUSTEE(6)	6	0.04	4712	62	228.07	340	8.64	0	0.00	900	5.51	499	8.66	22.81	250.88
4	RISHRA BUSTEE(7)	7	0.15	8537	72	264.86	395	10.03	0	0.00	1045	6.40	579	10.06	26.48	291.34
5	B.L.MUKHERJEE AND B.D. BANERJEE BYE LANE	8	0.01	2136	45	165.54	247	6.27	0	0.00	653	4.00	362	6.29	16.55	182.09
6	CHANDI CHARAN BANERJEE LANE	44	0.00	1396	18	66.21	99	2.51	0	0.00	261	1.60	145	2.51	6.62	72.84
7	S.D.MUKHERJEE AND N.S. ROAD	9	0.12	6160	66	242.79	362	9.19	0	0.00	958	5.86	531	9.22	24.28	267.06
8	K.B.SAHA ROAD AND N.S. ROAD	10	0.12	5505	20	73.57	110	2.79	0	0.00	290	1.78	161	2.79	7.36	80.93
9	K.C.DEY	14	0.02	492	13	47.82	71	1.81	0	0.00	189	1.15	105	1.82	4.78	52.60
10	PANCHANANTOLLA	28	0.02	536	9	33.11	49	1.25	0	0.00	131	0.80	72	1.26	3.31	36.42
11	D.D.HAR LANE	38	0.08	560	14	51.50	77	1.95	0	0.00	203	1.24	113	1.96	5.15	56.65
12	SITALATOLLA	39	0.02	875	23	84.61	126	3.20	0	0.00	334	2.04	185	3.21	8.46	93.07
13	SASTTOLLA	45	0.01	674	24	88.29	132	3.34	0	0.00	348	2.13	193	3.35	8.83	97.11
14	BIRINCHIPARA	15	0.02	5632	110	404.64	603	15.32	0	0.00	1597	9.77	885	15.37	40.46	445.11

Chairman
Rishra Municipality

SLUM WISE DETAILS OF DU AND INFRASTRUCTURE COST OF 2017-18

Chairman
Rishra Municipality

Slum No.	Name of Slum	Slum Code	Area SqKm	Population	Dwelling Units (@ Rs.3.67858 Lakh/ each)		Drainage (M) (Rs.2540.00/M) (Section -400x400)		Pipe Line @ Rs.1066.00 /M		Bituminous Roads (@ Rs. 612.00/Sq.M)		Concrete Roads (@ Rs. 1736.00/Sq.M)		Total cost of Infrastruct ure @ 10% of D.U. cost Rs. In Lac	Grand Total (Rs. In lakh)
					Qty.	Amt. (in Lakh)	Qty.	Amt. (in Lakh)	Qty.	Amt. (in Lakh)	Qty.	Amt. (in Lakh)	Qty.	Amt. (in Lakh)		
15	BEHIND RISHRA HIGH SCHOOL	17	0.05	660	11	40.46	60	1.53	0	0.00	160	0.98	89	1.54	4.05	44.51
16	BEHIND BURNING GHAT	18	0.03	578	14	51.50	77	1.95	0	0.00	203	1.24	113	1.96	5.15	56.65
17	HARIPODDAR LANE	19	0.09	698	15	55.18	82	2.09	0	0.00	218	1.33	121	2.10	5.52	60.70
18	BEHIND PREMANDIR (BRAHMATOLLA)	20	0.06	487	18	66.21	99	2.51	0	0.00	261	1.60	145	2.51	6.62	72.84
19	BAGKHAL BRICK FIELD	21	0.08	759	12	44.14	66	1.67	0	0.00	174	1.07	97	1.68	4.41	48.56
20	BAGKHAL	22	0.07	4236	41	150.82	225	5.71	0	0.00	595	3.64	330	5.73	15.08	165.90
21	MOREPUKUR 1ST LANE	23	0.01	985	76	279.57	417	10.59	0	0.00	1103	6.75	612	10.62	27.96	307.53
22	DASPARA	24	0.01	1205	22	80.93	121	3.06	0	0.00	319	1.95	177	3.07	8.09	89.02
23	ANUBHAVA ASSEMBLY HALL	25	0.01	984	18	66.21	99	2.51	0	0.00	261	1.60	145	2.51	6.62	72.84
24	SADHANKANAN	26	0.02	911	13	47.82	71	1.81	0	0.00	189	1.15	105	1.82	4.78	52.60
25	KISHORE SANGHA	27	0.02	3913	131	481.89	718	18.25	0	0.00	1902	11.64	1054	18.30	48.19	530.08
26	NAVABUSTEE	34	0.03	5850	122	448.79	669	16.99	0	0.00	1771	10.84	982	17.05	44.88	493.66
27	NAVABUSTEE	29	0.25	11884	187	687.89	1025	26.05	0	0.00	2715	16.61	1505	26.13	68.79	756.68
28	HARIR MATH & NITYANANDA PALY	30	0.15	1125	52	191.29	285	7.24	0	0.00	755	4.62	419	7.27	19.13	210.41

SLUM WISE DETAILS OF DU AND INFRASTRUCTURE COST OF 2017-18

Chairman
Rishana Municipality

Slum No.	Name of Slum	Slum Code	Area SqKm	Population	Dwelling Units (@ Rs. 3,67,858 Lakh/ each)		Drainage (M) (Rs.2540.00/M) (Section -400x400)		Pipe Line @ Rs.1066.00 /M		Bituminous Roads (@ Rs. 612.00/Sq.M)		Concrete Roads (@ Rs. 1736.00/Sq.M)		Total cost of Infrastruct ure @ 10% of D.U. cost Rs. In Lac	Grand Total (Rs. In lakh)
					Qty.	Amt. (in Lakh)	Qty.	Amt. (in Lakh)	Qty.	Amt. (in Lakh)	Qty.	Amt. (in Lakh)	Qty.	Amt. (in Lakh)		
29	NATUNGRAM PRIMARY SCHOOL	31	0.07	1205	14	51.50	77	1.95	0	0.00	203	1.24	113	1.96	5.15	56.65
30	HOTELWALA GOLI	33	0.03	1120	22	80.93	121	3.06	0	0.00	319	1.95	177	3.07	8.09	89.02
31	AAM BAGAN	46	0.00	1348	32	117.71	175	4.46	0	0.00	465	2.84	258	4.47	11.77	129.49
32	BURMANPARA	47	0.00	1428	20	73.57	110	2.79	0	0.00	290	1.78	161	2.79	7.36	80.93
33	BALAKSANGHA MATH	48	0.00	1417	40	147.14	219	5.57	0	0.00	581	3.55	322	5.59	14.71	161.86
34	SUBHASH NAGAR	32	0.25	5069	138	507.64	757	19.22	0	0.00	2003	12.26	1111	19.28	50.76	558.41
35	NABINPALLY	35	0.32	1258	22	80.93	121	3.06	0	0.00	319	1.95	177	3.07	8.09	89.02
36	SUBHASHNAGAR RAILPARK	16	0.07	1348	45	165.54	247	6.27	0	0.00	653	4.00	362	6.29	16.55	182.09
37	LUXMIPALLY	40	0.40	1448	15	55.18	82	2.09	0	0.00	218	1.33	121	2.10	5.52	60.70
38	SUBHASHNAGAR GOVT. COLONEY BACK SIDE OF WBSEB	41	0.01	1259	15	55.18	82	2.09	0	0.00	218	1.33	121	2.10	5.52	60.70
39	PALTEPARA	36	0.05	1785	35	128.75	192	4.88	0	0.00	508	3.11	282	4.89	12.87	141.62
40	BAGPARA	37	0.08	2129	100	367.86	548	13.93	0	0.00	1452	8.88	805	13.97	36.78	404.64
Total				103593	1842	6775.94	10101	256.57	0	0.00	26739	163.64	14825	257.36	677.57	7453.51

DETAILED ESTIMATE FOR THE CONSTRUCTION OF SINGLE UNIT DWELLING HOUSE

Pradhan Mantri Awas Yojana Housing For All (Urban)

Total Covered Area- 32.18 sq.m (With Electrical Works)

Reference of Schedule of Rates : PWD (W.B.), Schedule of Rates Building & Sanitary w.e.f-01.07.2014 & Corrigenda

Kolkata /24 Pgs (N & S)/ Kalyani Sub Div.)

Floor Area 25.37 sqm

SL No.	Description of Works	Quantity	Unit	Rate (Rs.)	Amount (Rs.)
1	Earthwork in excavation in foundation trenches or drains, in all sorts of soil (including mixed soil but excluding laterite or sandstone) including removing spreading or stacking the spoils within a lead of 75 m as directed including trimming the sides of trenches, levelling, dressing and ramming the bottom, bailing out water etc. as required complete. a) Depth of excavation not exceeding 1500mm . SOR, PWD, P-1, I -2 a	13.000	%cu.m	12047.00	1566.11
2	Earth work in filling in foundation trenches or plinth with good earth in layers not exceeding 150 mm. including watering and ramming etc. layer by layer complete.(Payment to be made on the basis of measurement of finished quantity of work) a) With earth obtained from excavation of foundation. SOR, PWD, P-1, T/3 a	11.120	%cu.m	7831.00	870.81
3	Supplying Laying Polithin Sheets etc. SOR, PWD, P-45, T - 13	22.000	sqm	25.00	550.00
4	Cement concrete with graded Stone ballast (40 mm.) excluding shuttering.a) In ground floor and foundation.6 : 3 : 1 proportion Pakur variety SOR, PWD, Page 24 ; Item -10 a	3.500	cu.m.	5823.00	20380.50
5	25 mm. thick damp proof with cement concrete (4:2:1) (with graded stone aggregate 10 mm. Normal size) and painting the top surface with a coat of bitumen using 1.7 kg. per sq.m. including heating the bitumen and cost and carriage of all materials complete. SOR, PWD, P-45, T-12	6.810	sqm,	297.00	2022.57
6	Brick work with 1st class bricks in cement mortar (6:1) a) In foundation and plinth. b) In super structure SOR, PWD, P-29, T -22(a), (b)	10.430 15.240	cum cum	5719.00 5943.00	59649.17 90571.32
7	125mm thick brick work with 1st. class bricks in cement mortar (4:1). a) In ground floor SOR, PWD, P-73, I -29	23.220	sq.m.	783.00	18181.26
8	Ordinary Cement concrete (mix 1:1.5:3) with graded stone chips (20 mm nominal size) excluding shuttering and reinforcement if any, in ground floor as per relevant IS codes. (i) Pakur Variety SOR, PWD, P-14, T -7(i)	3.940	cu.m.	6851.66	26995.54
9	Reinforcements for reinforced concrete work in all sorts of structures including distribution bars, stirrups, binders etc. including supply of rods, initial straightening and removal of loose rust (if necessary), cutting to requisite length, hooking and bending to correct shape, placing in proper position and binding with 16G black annealed wire at every inter-section, complete as per drawing and direction (a) For works in foundation, basement and upto roof of ground floor / upto 4m. (i) Tor steel/Mild steel. SOR, PWD, P-27, T -15(i)	0.309	MT	60705.93	18775.74

Dipankar Chaudhuri
Assistant Engineer
Rishra Municipality



Chairman
Rishra Municipality.

SL No.	Description of Works	Quantity	Unit	Rate (Rs.)	Amount (Rs.)
10	Hire and labour charges for shuttering with centreing and necessary staging upto 4 m. using approved stout props and thick hard wood planks of approved thickness with required bracing for concrete slabs, beams, columns, lintels curved or straight including fitting, fixing and striking out after completion of works. (upto roof of ground floor). (When the height of a particular floor is more than 4 m. the equivalent floor ht. shall be taken as 4 m. and extra for works beyond the initial 4 m. ht. shall be allowed under 12(e) for every 4 m. or part thereof.) SOR, PWD, P-112, T-12(a) 25 mm. to 30 mm. thick wooden shuttering as per decision & direction of Engineer-in-charge. Ground Floor	37.063	M ²	360.00	13342.68
11	Plaster (to wall, floor, ceiling etc.) with sand and cement mortar including rounding off or chamfering corners as directed and raking out joints or roughening of concrete surface, including throating, nosing and drip course where necessary . In ground floor. A) With 6:1 cement mortar. a) Inside wall 20 mm thick plaster SOR, PWD, P-151, T -2 (i)(b) b) Out side Wall, 15mm th. SOR, PWD, P-151, I -2 (i)(c) B)10mm th ceiling plaster (4:1) SOR, PWD, P-151, I -2 (i)(c)	116.940 111.950 23.330	sq.m. sq.m. sq.m.	181.00 156.00 140.00	21166.14 17464.20 3266.20
12	Neat cement punning about 1.5mm thick in wall, dado, window, sills, floor, drain etc. SOR, PWD, P-152, I -8	26.700	sq.m.	38.00	1014.60
13	Artificial stone in floor,dado, staircase etc. with cement concrete (4:2:1) with stone chips laid in panels as directed with topping made with ordinary or white cement (as necessary) and marble dust in proportion (2:1) including smooth finishing and rounding off corners and including application of cement slurry before flooring works, using cement @ 1.75 kg./sq.m. all complete including all materials and labour. In ground floor. 3 mm. thick topping (High polishing grinding on this item is not permitted) with ordinary cement. 20mm thick SOR, PWD, P-40, I -2 (i)	26.490	sq.m.	265.00	7019.85
14	Supplying, fitting & fixing MS clamp for fixing door and window frame made of flat bent bar, end bifurcated, fixed in cement concrete with stone chips (4:2:1)a fitted and fixed omplete as per direction. 40mm x 6mm x 125 mm length. (Cost of cement concrete will be paid separately) SOR, PWD, P-90, I -18 (c)	34	each	22.00	748.00
15	Wood work in door and window frame fitted and fixed complete including a protective coat of painting at the contact surface of the frame other Local wood SOR, PWD, P-85, T -1(i)	0.213	cu.m.	46171.00	9834.42
16	Panel Shutter of door & Window (each Panal Consisting Of single Plan without Join) 25 mm thick shutter with 12 mm thick Panal of size 30 to 45 cm. Other Local wood SOR, PWD, P-105, I -84 (iv)c	8.520	sq.m.	1567.00	13350.84
17	Iron butt hinges of approved quality fitted and fixed with steel screws, with ISI mark. a)75mm x 47mm x 1.70mm SOR, PWD, P-91, T -20(iv)	32.000	each	34.00	1088.00
18	Iron Socket Bolt of approved quality fitted and fixed complete. i) 150 mm long x 10 mm dia SOR, PWD P-93, I -25,c	11.000	each	71.00	781.00
19	White washing including cleaning and smoothening surface thoroughly (5 parts of stone lime and 1 part of shell lime should be used in the finishing coat). Two Coats SOR, PWD, P-155, I -3 (b)	124.960	%sq.m	1887.00	2358.00
20	Colour washing with ella with a coat of white wash priming including cleaning and smoothing surface thoroughly external surface One Coat SOR, PWD, P-155, I -4(ii)(a)	100.560	%sq.m	1514.00	1522.48

Dipender Choudhury
Assistant Engineer
Rishra Municipality

Chairman
Rishra Municipality

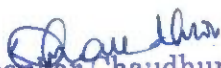
SL No.	Description of Works	Quantity	Unit	Rate (Rs.)	Amount (Rs.)
21	Priming one coat on timber, plastered or on steel or other metal surface with synthetic enamel/oil bound primer of approved quality including smoothening surfaces by sand papering etc. 1) On timber surface SOR, PWD, P - 162, I - 7(a) 2) On Steel Surface SOR, PWD, P - 162, I - 7(b)	21.690 2.700	sq.m. sq.m.	41.00 31.00	889.29 83.70
22	Painting with best quality synthetic enamel paint of approved make and brand including smoothening surface by sand papering etc. including using of approved putty etc. on the surface, if necessary : With super gloss (hi-gloss)-With any shade except white a) On timber or plastered surface Two Coats b) On Steel surface Two Coats SOR, PWD, P - 162, - 8A(aII),(bII)	21.690 2.700	sq.m. sq.m.	89.00 86.00	1930.41 232.20
23	Iron hasp bolt of approved quality fitted and fixed complete (oxidised) with 16 mm dia with center bolt and round fitting. 300 mm long SOR, PWD, P-93, I - 27c	2.000	each	193.00	386.00
24	Precast piered concrete jally work as per design and manufacture's specification including moulding etc. with stone chips and necessary reinforcement shuttering complete including fitting, fixing in position in all floors. (a) 37.5 mm th. panels Cement & steel required for this item will not be issued by deptt. SOR, PWD, P-32 I - 38 (b)	1.690	sq.m.	351.00	593.19
5	Supplying, fitting and fixing UPVC down pipes A type and fittings conforming to IS 13592-1992 with necessary clamps nails including making holes in walls, etc. and cutting trenches in any soil, through masonry concrete structure etc. if necessary and mending good damages including jointing with jointing materials (Spun yarn, valamoid / bitumen / M. seal etc.) complete. P-173, I-21 A (ii), C(ii), D(ii) SOR, PWD, P173, I - 21 A (ii), C(ii), D(ii) i) UPVC Pipe 110 mm dia ii) UPVC Bend 87.5 degree 110 mm dia iii) UPVC Shoe 110 mm	3.000 2.000 1.000	Mtr. each each	291.00 162.00 128.00	873.00 324.00 128.00
26	M.S.or W.I. Ornamental grill of approved design joints continuously welded with M.S, W.I. Flats and bars of windows, railing etc. fitted and fixed with necessary screws and lugs in ground floor. Grill weighing 10 kg/sq m to 16 kg/m2 SOR, PWD, P - 76, I - 10 (i) (2.70sam @ 10.5ka per sam = 28.35 ka)	0.284	Qntl	8247.00	2342.15
27	Shallow water closet Indian pattern(I.P.W.C.) of approved make in white vitreous chinaware supplied ,fitted and fixed in position (excluding cost of concrete for fixing). 450 mm long SOR, PWD, (Sanitary) P - 65, I - 1 (iii)	1.000	each	1062.00	1062.00
28	Foot rest for water closet of size 275 mm X 125 mm with Artificial stone(4:2:1) with 6 mm stone chips and chequered including adding colour as necessary. SOR, PWD, (Sanitary) P - 66, I - 9	1.000	Pair	70.00	70.00
29	Supplying,fitting and fixing cast iron 'P' or 'S' trap conforming to I.S. 3989 / 1970 and 1729 / 1964 including lead caulked joints and painting two coats to the exposed surface. S Trap 100 mm SOR, PWD, (Sanitary) P - 54, I - 14(B-iii)	1.000	each	923.00	923.00
30	Supplying, fitting fixing CI Round Gratings 150mm dia SOR, PWD, (Sanitary) P - 55, I - 18(ii)	1.000	Each	100.00	100.00

 Dipankar Chaudhuri
 Assistant Engineer
 Rishra Municipality

 Chairman
 Rishra Municipality

SL No.	Description of Works	Quantity	Unit	Rate (Rs.)	Amount (Rs.)
	Construction of 2 circular leach pit of inside diameter 1000 mm. & a depth of 1000 mm. With a layer of 250 mm. Thick brick work with cement mortar (6:1) & honeycombed brick wall (4:1) at every alternate layer upto a height of 925 mm. From bottom and then 125 mm. thick brick wall (4:1) for a height of 300 mm. and covered with 75mm. RCC slab (4:2:1) with 8mm tor steel @ 150 mm. centre to centre both ways including plustering and neat cement punning on top of the slab and making hooking arrangment on slab for lifting of the slab if require as well as jointing the connection with the inspection pit (450 x 450) covered with 50mm thick RCC slab (4:2:1) with stone chips and necessary reinforcement and connected with 100 mm dia PVC pipe laid over rammed earth and then covered the pipe properly with powder earth including supplying fitting fixing fibre glass pan P-tap & polythene pipe as per requirement to connect with the inspection pit complete with all respect as per direction of EIC.(ANNEXURE-II)	1	Item	7544.00	7544.00
	TOTAL AMOUNT		Rs.		350000.36
	Say		Rs.		350000.00
	Add for Electrical Works (ANNEXURE-I)		Rs.		17858.00
	TOTAL AMOUNT		Rs.		367858.00
(Rupees Three lakh Sixty seven thousand Eight hundred & Fifty eight only)					

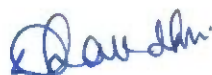

Dipankar Chaudhuri
Assistant Engineer
Rishra Municipality



Chairman
Rishra Municipality

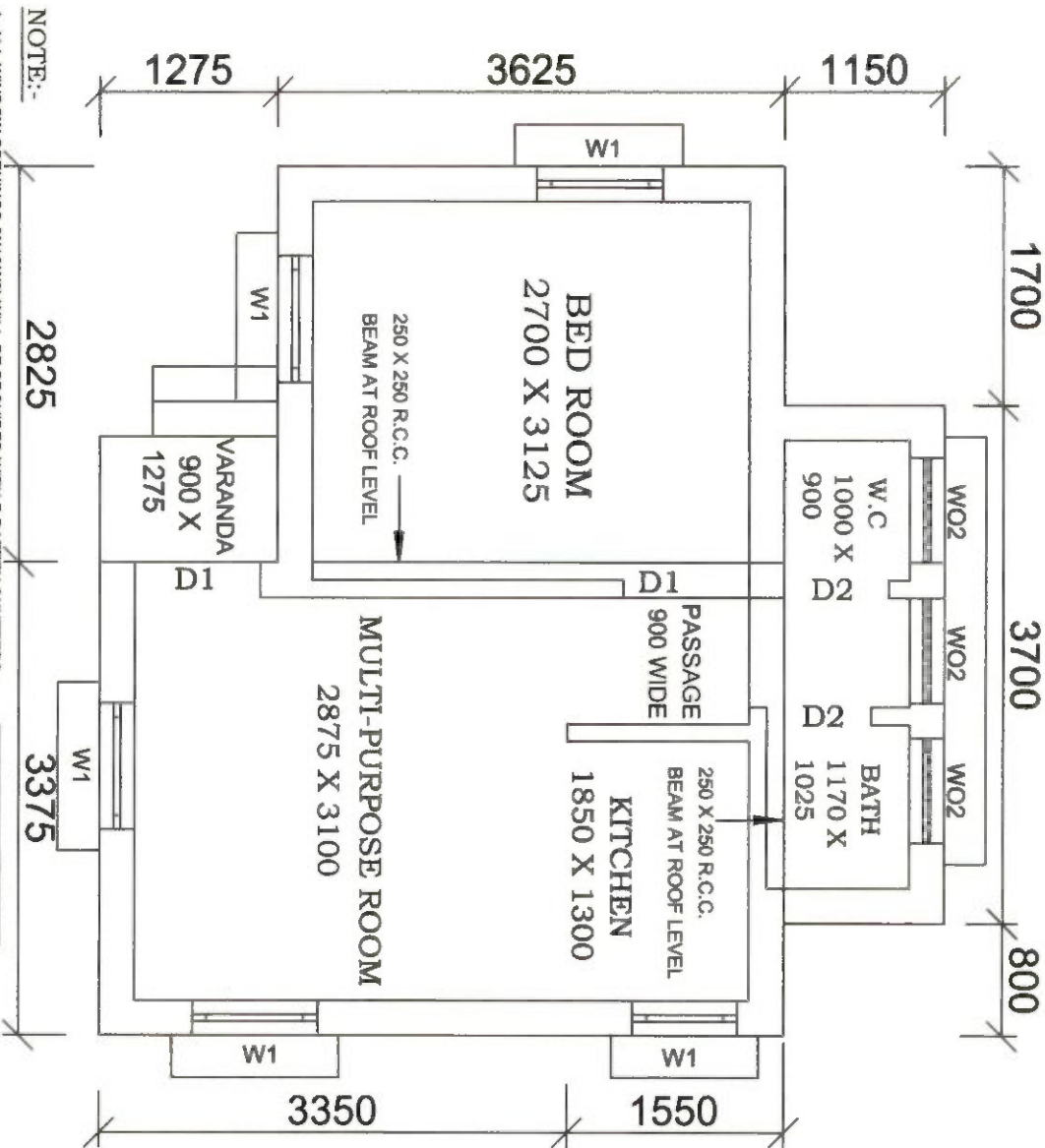

- NOTE:-
1. ALL WINDOW OPENINGS (W1&W2) WILL BE PROVIDED WITH Z-BATTEN SHUTTERS.
 2. ALL DOORS (D1&D2)- 25TH Z-BATTEN SHUTTERS, SINGLE LEAF.
 3. W02 - OPENING PROVIDED WITH R.C.C. JALLI.
 4. PLINTH HEIGHT - 450 TH.
 5. CEILING HEIGHT - 2750 TH.
 6. MAIN WALL - 250 TH.
 7. PARTITION WALL - 125 TH.
 8. ROOF SLAB, BEAM, LINTEL, ETC. WITH REINFORCED CEMENT CONCRETE M20 GRADE.
 9. FLOOR OF VERANDAH, WC, BATH, & KITCHEN ROOM TO BE KEPT 15 MM BELOW THE FLOOR LEVEL OF ROOM & PASSAGE.
 10. 100 MM TH. PIECE LINTEL OVER OPENING HAVE BEEN PROVIDED.
 11. ALL DIMENSION ARE IN MM.

DOORS & WINDOWS SCHEDULE		
MARKING	DIMENSION	
W1	900 X 900	
W2	750 X 900	
W02	750 X 750	
D1	900 X 2100	
D2	750 X 2100	

FLOOR AREA - 25.37 SQM.

BUILT UP AREA - 32.18 SQM.

FOUNDATION DETAILS

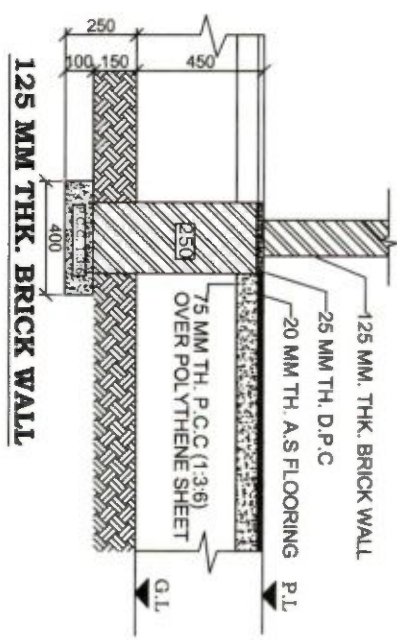

125 MM THK. BRICK WALL

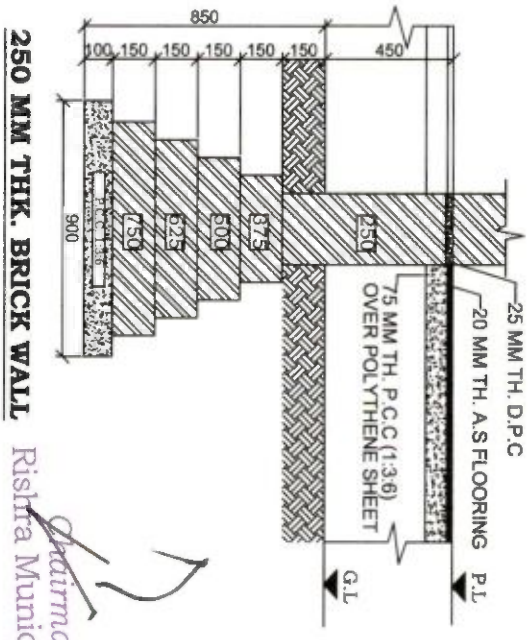

250 MM THK. BRICK WALL

Chairman
Rishra Municipality

PRADHAN MANTRI AWAS YOJANA

HOUSING FOR ALL (URBAN)

OFFICE OF THE CHIEF ENGINEER

MUNICIPAL ENGINEERING DIRECTORATE

GOVT. OF WEST BENGAL

DWG. NO.

SCALE :- 1:50 & 1:25

Dipankar Chatterjee
Assistant Engineer
Rishra Municipality

ESTIMATE FOR ELECTRICAL WORKS FOR ONE DWELLING UNIT UNDER PMAY

(ANNEXURE-I)

Sl.No	Item of works	Unit	Rate	Quantity	Amount
1	Supplying & fitting polythene pipe complete with fittings as necessary. Under celing /beam/bound with 22SWG GI wire inclusive S & Drawing 1x18 SWG GI wire as fish wire inside the pipe & fittings and providing 55 mm dia disc of MS sheet (20SWG) having colour paint at one face first ended at the load point end of the polythene pipe with fish wire (synchronizing with roof/beam casting work of building construction) 19 mm dia 3 mm thick polythene pipe	RM	39.00	25.00	975.00
2	Powerckt wiring supplying and drawing 1 ; 1KV grade single core stranded FR PVC insulated & unseathed single core stranded Copper wire (Finolex make) 2 x 2.5 sqmm (PH & N) +1x1.5 sqmm (ECC) per laid polythene pipe and by the prelaid GI fish wire & making necessary connections as required.	RM	76.00	50.00	3800.00
3	Concealed Distribution wiring in in 2x1.5 sqmm single core standard *FR* insulated and unseathed cop per wire Finolex make & 1x1.5 sq mm single core stranded PVC insulated and unseathed cop per (Finolex make) wire used as ECC in 19 mm bore 3 mm thk. polythene pipe complete with all accessries embedded in wall smooth run to light / fan/call bell point with pino key type switchb (6 Amps) (Anchor make) fixed on sheet metal (16 SWG) Switch Board with bakelite/ perspex (wall maching colour) Top cover (3 mm thick) flushed in wall including mending all good damages to original finish Average per point 6.00 mt.	points	828.00	10.00	8280.00
4	Deistribution concealed wiring with 2x1.5 sq mm (PH & N) single core stranded FR PVC insulated & unsheathed single core stranded 1.1 KV grade Copper Wire (finolex) & 1x1.5 sq mm (ECC) single core stranded (PH & N) 1.1 KV grade cu wire (finolex) & 1 x 1.5 sq mm single core stranded PVC insulated & unsheathed cu wire (finolex) used as ECC in 19 mm bore, 3 mm thick polythene pipe complete with all accessories embedded in wall 250 volt 5 amp 3 pin plug point including S & F 250 Volt 5 amp 3 pin flush type plug socket & piano key type swich (Anchor make) on existing switch board as mentioned sl. no.3	points	76.00	2.00	152.00
5	Supplying & drawing 1.1 KV grade single core stranded FR PVC insulated & unseathed single core stranded cu Wire 3x2.5 sq mm (finolex make) in the prelaid polythene pipe & by the prelaid GI fishwire & making necessary connection as required (CESC supply to consumer DP near to CESC & inside the room another DP near CESC & inside the room another DP of dwelling units)	RM	86.00	15.00	1290.00

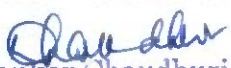
Dipankar Chaudhuri
Assistant Engineer
Rishra Municipality

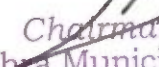
Chairman
Rishra Municipality.

Sl.No.	Item of works	Unit	Rate	Quantity	Amount
6	Supplying Delivery & instalation on wall of 30/32 amp DP MCBof Havel's make with enclosed box along with all its necessary 1 connection complete.(Anchor)	nos	808.00	2	1616.00
7	Earthing in soft soil with 50 mm dia GI pipe (TATA make Medium) 3.64 mm th. X 3.04 Mtr long and 1 x 4 SWG GI (hot dip) wire (4 m long) 13 mmdia x 80 mm long GI bolts, double nuts, double washer including S & F 15 mm dia GI protection (1 mtr long) to be filled with bitumen partlyunder the ground level & partly above GL driven to an average depth of 3.65 m below the GL & restoring surface duly rammed.	each	1715.00	1	1715.00
8	Connecting the equipment to earth BUSbar inclusive S&F 10 SWG (Hot Dip) GI wire on wall /floor with a staples buried inside wall /floor as required & making connection to equipments with bolt, nut, washer, cable lugs etc. as required & mending good damages.	M	6.00	5	30.00
			TOTAL		17858.00
Rupees Thirteen Thousand Eight Hundred Seventy Eight Only					17858.00

 Dipankar Chaudhuri
 Assistant Engineer
 Rishra Municipality

 Chairman
 Rishra Municipality

Detailed Estimate for Single Dwelling unit
Floor area 25.36 sqm Built up area 32.18 sqm

	C/L of main outer wall				125 mm Partitionwall		Varandah C/L	
	4.65				3.375		1.275	
	0.8				1.15		0.9	
	1.15				1.15	2.3	2.175	
	3.45				2.187			
	1.15				1.9			
	1.7				1.387	5.474		
	3.375				11.149			
	1.275							
	2.825							
	3.125							
	23.5							
	X wall	1.25						
Sl.no.								
1	Earth work in excavation							
	250 mm wall							
	1	23.5	0.75	0.7	12.34			
		0.875	0.75	0.7	0.46			
		24.375			12.8	m ³		
	125 mm Wall							
		2.625		0.4	0.225	0.24		
	WC	0.4	0.4	0.225	0.04			
	Bath	0.65	0.4	0.225	0.06			
	5.474	0.75		0.225				
		4.724	0.4	0.225	0.43			
	Varanda	1.425	0.4	0.225	0.13			
					0.88			
	Step	0.5	0.9	0.075	0.034			
					13.715	m ³		
2	Soling							
		24.375	0.75		18.281			
		11.45	0.4		4.58			
					22.861			
3	Polythene sheet							
		2.575	3.125		8.047			
		2.875	2.625		7.547			
		2	1.65		3.3			
	passage	0.625	2.375		1.484			
	Bath&WC	2.7	0.9		2.43			
	Varndah	1.025	0.6		0.615			
	step	0.9	0.5		0.45			
					23.873			
4	Jhama concrete							
			18.28	0.075	1.371			
			4.58	0.075	0.344			
			23.93	0.075	1.795			
					3.51			
5	Earth work in filling 1/5 excavation							
			13.715	5	2.743			
			23.48	0.375	8.805			
					11.548	m ³		
6	B.W (6:1) in Foundation of plinth							

Dipankar Chatterhuri
Assistant Engineer
Rishra Municipality

Chairman
Rishra Municipality

		23.5	0.625	14.6875					
		23.5	0.5	11.75					
		23.5	0.375	8.8125					
				35.25	0.15	5.288			
		23.5	0.25		0.525	3.084			
	X wall	0.938	0.625	0.586					
		1	0.5	0.5					
		1.063	0.375	0.399					
				1.485	0.15	0.223			
		1.125	0.25		0.525	0.148			
	125mm	3.125	0.25		0.525	0.41			
	Bath&WC	2	0.9	0.25	0.523	0.235			
	Kit	5.224	0.25		0.525	0.686			
	Vard	1.925	0.25		0.525	0.253			
	Steps		0.5	0.9	0.15	0.068			
			0.25	0.9	0.15	0.034			
						10.427	m ³		
7	DPC	23.5							
		1.125							
		24.625		0.25		6.156			
		3.125							
		1.8							
		5.224							
		10.149		0.125		1.269			
						7.425			
	Less		0.9	0.25	0.225				
			0.9	0.125	0.113				
		3	0.75	0.125	0.281				
						0.619			
						6.806	sqm		
8	BW in super structure (6:1)								
		23.5							
		1.125							
		24.625	2.75	0.25	16.93				
	Parapet	23.8	0.075	0.25	0.446				
						17.376			
	Less opens								
		1	0.9	2.1	1.89				
		4	0.9	0.9	3.24				
		1	0.75	0.9	0.675				
		3	0.75	0.75	1.688				
				7.493	0.25	1.873			
	Lintel								
		1	1.525	1.525					
		4	1.2	4.8					
		1	1.05	1.05					
				7.375	0.25	0.1	0.184		
	Wo2								
		1	3.05	3.05	0.25	0.1	0.076		
					(-)	2.134			
	Net brick work					15.242	m ³		

Dipankar Chaudhary
Assistant Engineer
Rishra Municipality

Chairman
Rishra Municipality

9	125 th. Brick work (6:1)							
	room		3.125	2.6	8.125			
	kit		2.125	2.75	5.844			
			1.65	2.75	4.5375			
			1.45	2.65	3.8425			
	2		0.9	2.1	3.78			
						26.12875		
	Less opening							
	1 0.9		0.9					
	3 0.75		2.25					
			3.15	2.1	6.615			
	Lintel							
	1 1.3		1.3					
	1 1.025		1.025					
			2.325	0.1	0.2325			
					6.8475			
						19.28125		
	Parapet							
	23.5			0.15		3.525		
						22.806		
	passeege	0.75		0.55		0.4125		
						23.219	sqm	
10	Conc M-20							
	Roof slab							
	32.15	1.1475	31.003		0.1	3.1		
	Beam		3.625	0.25	0.15	0.136		
			2.575	0.25	0.1	0.064		
	Lintel						3.301	
	D1	1	1.525	1.525				
	W1	4	1.2	4.8				
	W2	1	1.05	1.05				
	WO2	1	3.05	3.05				
				10.425	0.25	0.1	0.261	
	D1	1	1.39	1.39				
	D2	1	1.025	1.025				
	D2	2	1.4	2.8				
	O2	1	0.875	0.875				
	D2	2		6.09	0.125	0.1	0.076	
	Chaja							
	W1	4	1.2	4.8				
	W2	1	1.03	1.03				
	D1	1	1.275	1.275				
	WO2	1	3.05	3.05				
				10.155	0.3	0.075	0.228	
							3.866	m³
11	Reinforcement							
		3.866	0.80%	1	7850	0.243	MT	
12	Shuttering							
	31	23.5	1.125					

Dipankar Chaudhary
Assistant Engineer
Rishra Municipality

Chairman
Rishra Municipality

			24.63	0.25					
	3I			6.156	24.844				
	Side beam	2	3.125	0.15	0.9375				
		2	2.325	0.1	0.465				
	side slab	1	25.3	0.1	2.53				
	Lintel	1	0.9	0.25	0.225				
		1	1.525	0.1	0.153				
		1	1.275	0.35	0.446				
		1	0.3	0.05	0.015				
						29.615	sqm		
	4W1	4	0.9	0.25	0.9				
		4	1.2	0.1	0.48				
		4	1.2	0.35	1.68				
	2	4	0.3	0.05	0.12				
	1W2	1	0.75	0.25	0.188				
		1	1.05	0.1	0.105				
		1	1.05	0.35	0.368				
	2	1	0.3	0.05	0.03				
	WO2	3	0.75	0.25	0.563				
	1	1	3.05	0.1	0.305				
		1	3.05	0.35	1.068				
	2	1	0.3	0.05	0.03				
	Lintel 125 Wall								
	D1	1	0.9	0.125	0.113				
		2	1.3	0.1	0.26				
	D2	2	0.75	0.125	0.188				
	2	2	1.15	0.1	0.46				
	D2	2	0.75	0.125	0.188				
		2	1.9	0.1	0.38				
						7.423			
						37.038	sqm		
13	Plaster (6:1)								
	Out side 15 mmth.								
			2.85	1.125	0.45				
	25.3				4.425	111.953	sqm		
	Inside 20 mm th.								
	2	2.7	3.125	2.75	32.038				
	2	2.875	2.625	2.75	30.25				
	2	2	1.65	2.75	20.075				
	2	2.075		2.75	11.413				
	Above lintel								
	1	0.75		0.65	0.488				
	Bath								
	2	0.9		2.75	4.95				
	WC								
	1	2.95		2.75	8.113				
	1	2.25		2.75	6.188				
	4	2.2		0.9	7.92				
	T. 125 wall								
	2	0.9		0.125	0.225				
						121.658			
	Open out side less								
	3	0.75		2.1	4.725				

Dipankar Chaudhury
Assistant Engineer
Rishra Municipality

Chairman
Rishra Municipality

					(-)	4.725			
						116.933	sqm		
	Celling Plaster				24.47				
	Less				1.14				
						23.33	Sqm		
14	Neat cement punning								
	Out side	Plinth							
		25.3	0.45			11.385	Sqm	11.385	
	Inside		2.7	3.125					
			2	5.825	0.1	1.165	Sqm		
				2.875	2.625				
			2	5.5	0.1	1.1	Sqm		
	Kithen		2	1.65					
			2	3.65	0.45	3.285	Sqm		
			1	1.65	0.45	0.743	Sqm		
			2	2.075	0.1	0.415	Sqm		
	Varanda			1.775	0.1	0.178	Sqm		
	step WC	1		3	0.45	1.35	Sqm		
	Bath			3.5	2	7	Sqm		
				0.75	0.1	0.075	Sqm		
	In side punning						15.31	15.31	
	Total							26.695	Sqm
15	Art. Stone flooring								
	Floor area					25.37	sqm		
	Step	2	0.9	0.25		0.45			
	W1	4	0.9	0.1		0.36			
	W2	1	0.75	0.1		0.075			
	W3	3	0.75	0.1		0.225			
							26.48	Sqm	
16	Ms Clamp for door & window								
	D1+D2	4		6		24			
	W1+W2	5		2		10			
								34 nos.	
17	Wood work in Door & window frame								
	D1	2	5.1	10.2					
	D2	2	4.95	9.9					
	W1	4	3.6	14.4					
	W2	1	3.3	3.3					
				37.8	0.075	0.075	0.213	m ³	
18	Z batten shutter								
	D1	2	0.775	2.025		3.139			
	D2	2	0.625	2.025		2.531			
	W1	4	0.775	0.775		2.403			
	W2	1	0.775	0.625		0.484			
							8.557	sqm	
19	Iron Butt Hinges								
	D1+D2					12			
	W1	4		4		16			
	W2	1		4		4			
								32 nos.	

Dipankar Choudhuri
Assistant Engineer
Rishra Municipality

Chairman
Rishra Municipality

20	Iron socket bolt							
	Door			6				
	Window			5				
							11 nos.	
21	White wash							
	Inside+Ceiling Plaster- inside punning							
			116.933	23.33	15.31		124.953	sqm
22	Colour wash							
	Out side Plaster- out side punning							
			111.953	11.385			100.568	sqm
23	Priming on timber surface							
	2	2	0.9	2.1		7.56		
	2	2	0.75	2.1		6.3		
	4	2	0.9	0.9		6.48		
	1	2	0.75	0.9		1.35		
							21.69	sqm
24	Painting best quality on wooden surface							
	same sl.no. 23						21.69	sqm
25	MS ornamental gril....10Kg-16 Kg							
	W1	4	0.75	0.75	2.25			
	W2	1	0.75	0.6	0.45			
					2.7			
					@12Kg/sqm		32.4	Kg
26	Priming on Steel surface						2.7	sqm
27	Painting best quality on steel surface						2.7	sqm
	same sl.no. 24							
28	R.C.C. Shelf							
		1.75	0.5				0.875	sqm
29	Roof treatment with cow dang							
				32.18				
	Deduct	1.14	(varanda)	1.14				
	Cornice	25	0.125	3.125				
				27.915			27.915	sqm

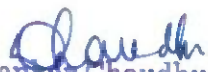
 Dipankar Chaudhuri
 Assistant Engineer
 Rishra Municipality

 Chairman
 Rishra Municipality

**Cost Estimate for 2 Nos Leach Pit for single unit Dwelling Unit
P.W.D Schedule of Rates effect from 1st July 2014**

(ANNEXURE-II)

Sl No	Description of Items	Quantity	Unit	Rate	Amount
1	Earth work in excavation of foundation trenches or drains in all sorts of soil (including mixed soil but excluding or stacking the spoils within a lead of 75 m. as directed. The item includes necessary trimming the sides of trenches leveling dressing and ramming the bottom boiling out water aqs required complete. Depth of exavation not existing 1500mm P.No-1, I-2(a)	2.500	%Cu.M	12047.00	301.18
2	Cement concrete with graded jhama Khoa ballast (30 mm size) excluding shuttering. In ground floor and foundation (a) 6:3:1 proportion.	0.050	Cu.M	5803.06	290.15
3	Brick work with 1st class bricks in cement mortar (6 :1). a) In foundation & Plinth P.no-29, I-21(a)	0.010	Cu.M	5719.00	57.19
4	125 mm. thick brick work with 1st class bricks in cement mortar (4 : 1) G.Floor	3.000	SqM	714.00	2,142.00
5	Controlled Cement concrete with well graded stone chips (20 - mm nominal size) excluding shuttering and reinforcement with complete design of concrete as per I : 456 and relevant special publications submission of job mix formula after preliminary mix design after testing of concrete cubes as per direction of Engineer-in charge Consumption of cement will not be less than 300 Kg of cement -with Super plasticiser per cubic meter of controlled concrete but actual consumption will be determined on- the basis of preliminary test and job mix formula. -I n ground floor and foundation. [Using concrete mixture] M 20 Grade P.no-12, I-16(a)	0.145	Cu.M	6871.54	996.37
6	Reinforcemnet for reinforced concrete work in all sorts of structures incl. Distribution bars, stirrups, binder etc. incl. supply of rods, initial straightening & removal of loose rust (if necessary), cutting to requisite length, hooking etc P.no-27, I-15(a)(i)	0.010	M.T	68508.00	685.08
7	Supplying, fitting and fixing UPVC down pipes A type and fittings conforming to IS 13592-1992 with necessary clamps nails including making holes in walls, etc. and cutting trenches in any soil, through masonry concrete structure etc. if necessary and mending good damages including jointing with jointing materials (Spun yarn, valamoid / bitumen / M. seal etc.) complete.				
	i) UPVC Pipe 110 mm dia P.no-173, I-21(B)C(ii)	4.000	Mtr	291.00	1,164.00
	ii) UPVC Bend 87.5 degree 110 mm dia P.no-174, I-21(B)C(ii)	2.000	Each	162.00	324.00
8	Jaffri brick work 125 mm. thick with 1st class bricks in cement mortar (4:1) including 12 mm. thick cement plaster (4:1) in all faces in ground floor P.no-32, I-35	2.000	SqM	792.00	1,584.00
Cost of 2 no leach pit					7,543.97
Total=					7,544.00

Dipankar Chaudhuri
Assistant Engineer

Rishra Municipality

Chairman
Rishra Municipality

ESTIMATE FOR CONSTRUCTION OF BITUMINOUS ROAD PER SQ-MTR

All rates are taken from P.W.D. Schedule Roads Deptt: 2014 Effective from 1st June 2014.

Consider 100.0m x 3.0m Bituminous Road

Sl. No	Description						UNIT	QTY.	RATE (RS.)	AMOUNT (RS.)
	Details	No	L	B	H	Qty.				
1	Page-238 , Item-13.16(a), For BT road	1.0	100.000	3.000		300.00	Sqm	300.00	14.40	4,320.00
					Total-	300.00				
2	P-244 , Item-4.09 , (i) For BT road	1.0	100.000	3.000	0.100	30.00	Cum	30.00	1,782.15	53,464.50
					Total-	30.00				
3	P-244 , Item-4.10 , (i) Water Bound Macadam Sub Base by consolidating Jhama metal / Laterite chelly or stone metal / shingles of specific size in hard crust to requisite thickness (measured after compaction) in layers including screening of metals etc. as necessary, hand packing, sweeping, watering and rolling in stages with power roller to proper line, grade and camber, lighting, guarding & barricading and making necessary earthen bundh of one metre width on each side where necessary to protect edges and preparing the bed by necessary cutting or filling and rolling all complete including the cost of all materials and hire and labour charges of all men and machineries and compacting to the required density, as per Clause 404 of Specifications for Road & Bridge Works of MoRT&H (5th Revision). (i) For Construction of Sub Base by consolidating Jhama metal (63 mm to 45 mm) with moorum screening : For BT road	1.0	100.000	3.000	0.075	22.50	Cum	22.50	1,798.58	40,468.05
					Total-	22.50				
4	Page-245 Item No.4.11 (III) For BT road	1.000	100.000	3.000	0.075	22.50	Cum	22.50	3,173.67	71,407.58
					Total-	22.50				
5	Page-253 Item-5.11 Providing, laying and rolling of Open - graded premix surfacing of 20 mm thickness composed of 13.2 mm (@ 0.018 m³ per m²) and 11.2 mm (@ 0.009 m³ per m²) size stone aggregates, including thoroughly cleaning of the surface, screening, cleaning and pre-heating stone chips and fully pre-coating the same either using viscosity grade paving bitumen or cut-back or emulsion, carrying the mixture by any suitable arrangements, laying the mixture uniformly over the surface, including line, grade and level to serve as wearing course on a previously prepared base, including mixing in Mobile Hot Mix Plant (Light Duty) and thoroughly rolling with a smooth wheeled roller 8-10 tonne capacity, finished to required level and grades including the cost and carriage of stone chips and matrix, heating the matrix, preheating the aggregates to required temperature and including the hire charges of Mobile Hot Mix Plant (Light Duty) and other machinery, pay of operators, cost of fuel and lubricants etc. complete to be followed by seal coat of either Type A or Type B as per Technical Specification Clause 508 for Rural Roads of MORD. a) Using Mobile HMP (Light duty). a) on WBM surface						Cum	300.00	172.33	51,699.00

Dipankar Chaudhuri
Assistant Engineer
Rishra Municipality

Chairman
Rishra Municipality

ESTIMATE FOR CONSTRUCTION OF BITUMINOUS ROAD PER SQ-MTR

All rates are taken from P.W.D. Schedule Roads Deptt: 2014 Effective from 1st June 2014.

Consider 100.0m x 3.0m Bituminous Road

Sl. No	Description						UNIT	QTY.	RATE (RS.)	AMOUNT (RS.)
	Details	No	L	B	H	Qty.				
	b) on WBM surface									
	For BT road	1.0	100.000	3.000		300.00				
					Total-	300.00				
6	Page-254 Item 5.13. B.(i)						Sqm	300.00	57.00	17,100.00
	For BT road	1.0	100.0	3.0		300.00				
					Total-	300.00				
7	Page-235 Item 3.01(i)						Cum	180.00	89.90	16,182.00
	For BT road	2.0	100.000	3.000	0.300	180.00				
					Total-	180.00				

Total-	254,641.13
Add Contingency @ 3%	7,639.23
G. Total-	262,280.36
Total area of Road in Sq.m	300.00
Rate /Sq.m=	874.27
Say	874.00

Dipankar Chaudhuri
Assistant Engineer
Rishra Municipality

Chairman
Rishra Municipality

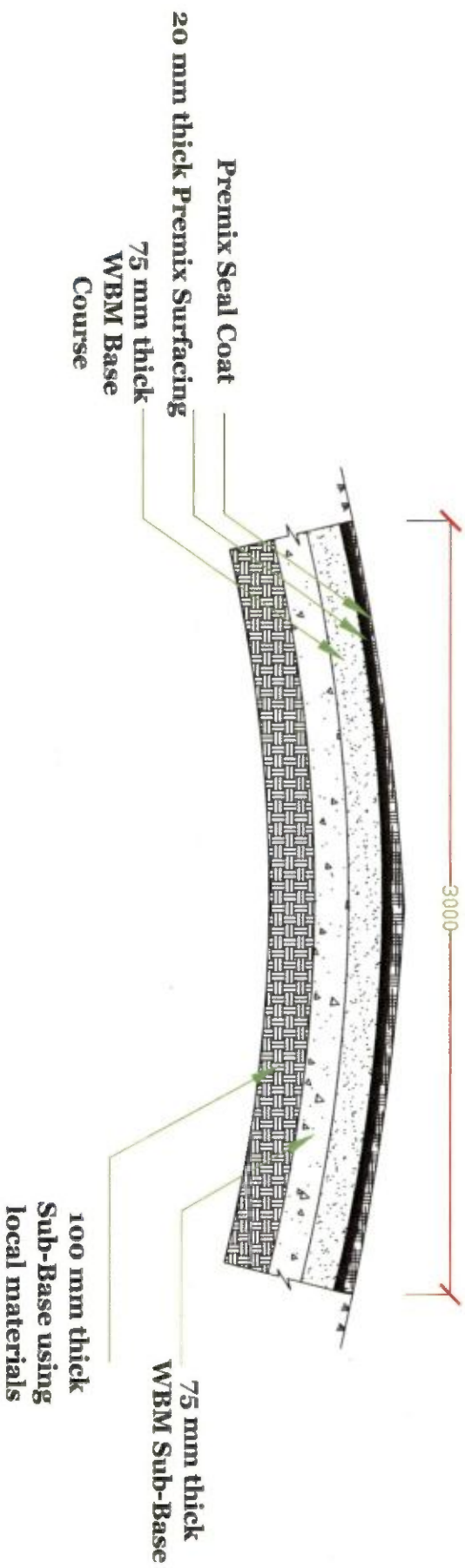

**TYPICAL CROSS-SECTION
OF BITUMINOUS ROAD**

Dipankar

[Signature] Assistant Engineer]

Dipankar Chaudhuri
Assistant Engineer
Rishra Municipality

Chairman
[Signature]
Chairman
Rishra Municipality

**ESTIMATE OF CEMENT CONCRETE ROAD UNDER PMAY
(UNIT LENGTH AND WIDTH 2.5m)**

Sl.No.	Description of item	Quantity	Unit	Rate	Amount
1 Pg.-1,I-1	Surface Dressing of the ground in any kind of soil including removing vegetation inequalities not exceeding 15 cm depth and disposal of the rubbish within a lead upto 75 m as directed.	2.5	m ²	11	27.5
2 pg.-1,I-2	Earth work in excavation of foundation trenches or drains, in all sorts of soil (including mixed soil but excluding laterite or sandstone) including removing, spreading or stacking the spoils within a lead of 75 m. as directed. The item includes necessary trimming the sides of trenches, levelling, dressing and ramming the bottom, bailing out water as required complete. (a) Depth of excavation not exceeding 1,500 mm.	0.312	%m ³	12047	37.59
3 pg.-11,I-1	Single Brick Flat Soling of picked jhama bricks including ramming and dressing bed to proper level and filling joints with local sand.	2.5	m ²	377	942.5
4 pg.-26,I-12(f)	Hire and labour charges for shuttering with centering and necessary staging upto 4 m using approved stout props and thick hard wood planks of approved thickness with required bracing for concrete slabs, beams and columns, lintels curved or straight including fitting, fixing and striking out after completion of works (upto roof of ground floor) (f) 25 mm to 30 mm shuttering without staging in foundation	0.2	m ²	225	45
5 Pg.-11,I-5	Ordinary Cement concrete (mix 1:2:4) with graded stone chips (20 mm nominal size) excluding shuttering and reinforcement, if any, in ground floor as per relevant IS codes. a) Pakur Variety	0.25	m ³	6111.98	1527.99
6 Pg.-1,I-3(a)	Earth work in filling in foundation trenches or plinth with good earth, in layers not exceeding 150 mm. including watering and ramming etc. layer by layer complete. (Payment to be made on the basis of measurement of finished quantity of work) (a) With earth obtained from excavation of foundation.	0.312	%m ³	7831	24.43

TOTAL= 2605.01

Dipankar Chaudhuri
Assistant Engineer
Rishra Municipality

Chairman
Rishra Municipality

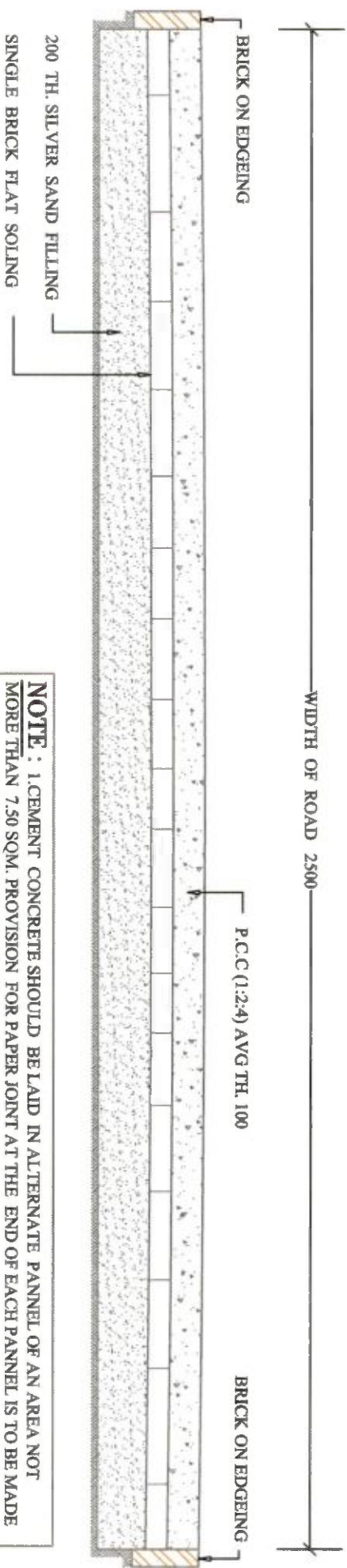

NOTE : 1. CEMENT CONCRETE SHOULD BE LAID IN ALTERNATE PANNEL OF AN AREA NOT MORE THAN 7.50 SQM. PROVISION FOR PAPER JOINT AT THE END OF EACH PANNEL IS TO BE MADE
2. ALL DIMENSIONS ARE IN MM.

TYPICAL CROSS SECTION OF CEMENT CONCRETE ROAD

Dipankar Chaudhuri
Dipankar Chaudhuri
Assistant Engineer
Rishra Municipality

Chairman
Chairman
Rishra Municipality

PRADHAN MANTRI AWAS YOJANA
HOUSING FOR ALL (URBAN)
OFFICE OF THE CHIEF ENGINEER
MUNICIPAL ENGINEERING DIRECTORATE
GOVT. OF WEST BENGAL
DWG. NO.

Abstract of Estimated Cost for Drain section of 400mm x 400mm

All rates are taken from P.W.D. Schedule 2014 ,Kolkata location followed.

Length= 1.0 Mtr.

Sl. No	Description						UNIT	QTY.	RATE (RS.)	AMOUNT (RS.)
	Details	No	L	B	H	Qty.				
1	Earth work in excavation of foundation trenches or drains. In all sorts of soil (including mixed soil but excluding laterite or sandstone) including removing. Spreading or stacking the spoils within a lead of 75m. As directed. The item includes necessary trimming the sides of trenches, leveling dressing and ramming the bottom complete a) Depth of excavation not exceeding 1500mm. Page-1, Item-2.						%Cum	0.60	12,047.00	72.73
	For drain	1.0	1.000	1.05	0.575	0.60				-
					Total-	0.60				-
2	Earth work in filling in foundation trenches or plinth with good earth. In layers not exceeding 150 mm. including watering and ramming etc. layer by layer complete. (Payment to be made on basis of measurement of finished quantity of work). (a) With earth obtained from excavation of foundation. Page-1, Item No.-3.a						%Cum	0.04	7,831.00	3.13
	Consider total Earth	2.0	1.000	0.050	0.400	0.04				-
					Total-	0.04				-
3	Single Brick Flat Soling of picked jhama bricks including ramming and dressing bed to proper level and filling joints with local sand. Page-11, Item-1.						Sqm	1.05	377.00	395.85
	For drain	1.0	1.000	1.050		1.05				-
					Total-	1.05				-
4	Ordinary Cement concrete (mix 1:2:4) with graded stone chips (20 mm nominal size) excluding shuttering and reinforcement, if any, as per relevant IS codes. A) Pakur Variety. Page-11, Item-5.a a) Ground floor.						Cum	0.11	4,603.00	483.32
	For drain	1.0	1.000	1.050	0.100	0.11				-
					Total-	0.11				-
5	Brick work with 1st class bricks in cement mortar (4:1) (a) In foundation and plinth Page-29, Item No.-21.a						Cum	0.2	6,068.00	1,213.60
	For drain	2.0	1.000	0.250	0.400	0.20				-
					Total-	0.20				-
6	Plaster (to wall, floor, ceiling etc.) with sand and cement mortar including rounding off or chamfering corners as directed and raking out joints including throating, nosing and drip course, scaffolding/staging where necessary (Ground floor). [Excluding cost of chipping over concrete surface] (ii) with 1:4 cement mortar Page-151, Item-2.ii.b (a) 15mm thick plaster						m ²	1.7	176.00	299.20
	For drain	1.0	1.000	1.700		1.70				-
					Total-	1.70				-
7	Neat cement punning about 1.5mm thick in wall, dado, window sill, floor etc. Page-152, Item-8. NOTE: Cement 0.152 cu.m per 100 sq.m.						m ²	1.7	38.00	64.60
	For drain	1.0	1.000	1.700		1.70				-
					Total-	1.70				-

Total-	2,532.43
Add Contingency @ 3%	75.97
G. Total-	2,608.40
Rate /Mtr length=	2,608.40

Dipankar Chaudhuri
Assistant Engineer
Rishra Municipality

Chairman
Rishra Municipality

CROSS SECTION OF DRAIN (400 x 400)

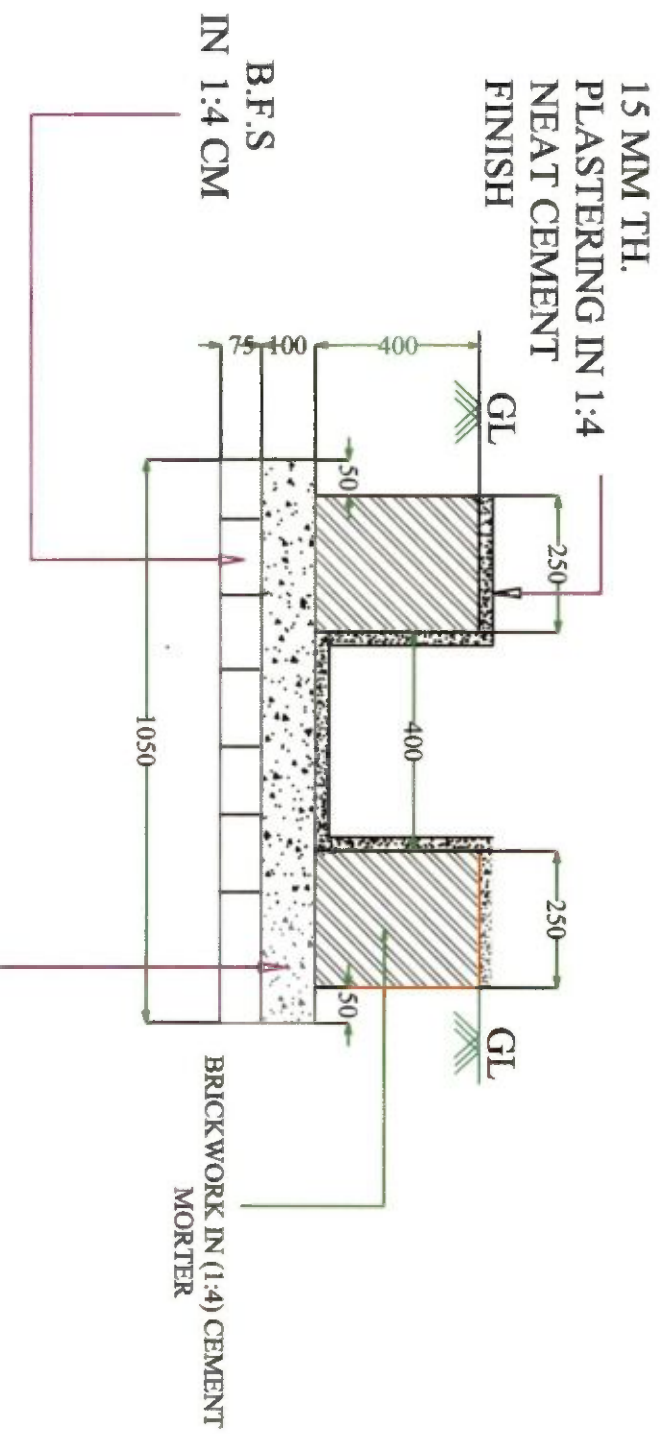

100 MM TH. P.C.C (1:2:4) OVER
75 TH. BRICK FLAT SOLING

Dipanker

Dipanker Chaudhuri



Assistant Engineer
Kishna Municipality

Chairman
Rishra Municipality

Chairman