

STATE URBAN DEVELOPMENT AGENCY

“ইলগাস ভবন”, এইচ-সি ব্লক, সেক্টর-৩, বিধাননগর, কলকাতা-৭০০ ১০৬, পশ্চিমবঙ্গ

“ILGUS BHAVAN”, H-C Block, Sector - III, Bidhannagar, Kolkata - 700 106, West Bengal

ক্রমিক নং SUDA-23/2015 (Pt. 11)/199

তারিখ 28.04.2017

From: Finance Officer, SUDA

To: District Magistrate, Dakshin Dinajpur

MEMORANDUM

Sub: Release of fund to District Magistrate, Dakshin Dinajpur for construction of IHHL with the objective of declaring the ULBs in the District ODF under SBM

Madam/Sir,

In continuation Dakshin Dinajpur vide Memo No. 595/GMA dated 12.04.2017 amounts shown in here under statement are being released in favour of District Magistrate, Dakshin Dinajpur for construction of 6840 nos. IHHL and 90 nos. of Public Community Toilet Blocks in the ULBs of the Districts. The amounts released represent the central and matching state shares as well as the Additional state shares.

The District Administration is requested to place appropriate funds at the disposal of the ULBs to enable them to continue the pace of construction of IHHL and public community Toilet Blocks.

Sl. No.	District	Central Share	Matching State Share	Addt. State Share	Total (Rs. In lakh)	Name of Payee	Bank Details
1	Dakshin Dinajpur	230.40	76.80	200.05	507.25	CNTRL RURAL SANITTN PROG.	State Bank Of India, Balurghat Branch, A/C No:- 11273426956 IFS Code:- SBIN0000020
	Grand Total	230.40	76.80	200.05	507.25		

Yours faithfully,

Encl: As stated

 Finance Officer, SUDA.

দূরভাষ : ২৩৫৮ ৬৪০৩ / ৫৭৬৭, ফ্যাক্স : ২৩৫৮ ৫৮০০

Tel : 2358 6403/5767, Fax : 2358 5800, E-mail : wbsudadir@gmail.com

Account Section : 2358 6408

In this connection kindly find enclosed herewith the provisional number of IHHL units to be constructed in the Urban Local Bodies of the District ULB wise as per findings of the comprehensive house to house survey for identification of insanitary latrine/no latrine facilities. However the actual number will be as per field executions. The model plan for the latrine unit as prepared by Municipal Engineering Directorate at an estimated cost of Rs. 10,990/- has been decided to be adopted in the program. A copy of plan and estimate of the model design of the latrine is enclosed herewith. The implementation of the program may be undertaken under the overall co-ordination of the District Magistrates and the respective ULBs. The work may be executed preferably through sanitary mart or such other self-help groups (as was done in the case of Nadia) or through the ULBs or otherwise as may be decided by the respective District Administration.

It is further informed that the progress of construction of IHHL starting from applications by the beneficiaries to completion of the units are required to be uploaded in the Govt. of India's portal under SBM. The uploading may be done by CSC e-Governance Services India Ltd. (a special purpose vehicle company constituted by Dept. of Information Technology, Govt. of India and entrusted to look after the CSC scheme across the country) or by the respective ULBs.

The District Administrations will also be required to identify the households where there is no suitable space for construction of IHHL. On receiving a feedback from the Districts proposals for construction of Community Toilets in close proximity of the identified households will be prepared and submitted to the MA Dept. for reference to Finance Department for the required additional State share. Simultaneously the concerned ULBs will be required to identify suitable lands for construction of Community Toilets.

It has further been decided that the following fund sharing pattern will be adopted for construction of IHHL

GOI share	:	Rs. 4000
Matching State share	:	Rs. 1333
ULB contribution	:	Rs. 2000
Beneficiary's contribution	:	Rs. 1000
Additional State share	:	Rs. 2657
Total		Rs. 10,990

Com mitments from the ULBs should be obtained by the District Magistrates regarding payment of ULBs share and beneficiary's share.

Handwritten signature and date: 26-11-18

The release of fund is also subject to the following conditions:

- 1) The fund should be utilized only for the purpose for which it is released and for no other purpose.
- 2) Works for the released amount should be executed strictly as per scheme Guidelines.
- 3) Monthly report of Physical and Financial progress should be sent to SUDA and MED by the 7th of the following month.
- 4) The amount released herein should be kept in the dedicated Bank Account for SBM maintained by the ULBs.
- 5) A subsidiary Cash Book should be maintained for keeping accounts (deposits and withdrawals) of funds.
- 6) Money receipt in Form 42 may be sent immediately after receipt of the online transfer.
- 7) Appropriate amounts should be sub allotted to the concerned ULBs.

 28.04.17

Finance Officer, SUDA.

SUDA-23/2015 (pt.II)/199/1(u)

28.04.2017

Copy Forwarded for kind information of:

1. Secretary, UD & MA Dept, Govt. of West Bengal.
2. Sri B.N.KAR, Addl. Dir. SBM and Addl. Dir. ILGUS.
3. Chief Engineer, M.E. Directorate.
4. Cashier, SUDA.

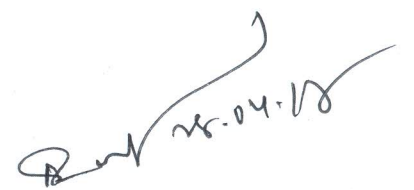
 28.04.17

Finance Officer, SUDA.

Page 1

Abstract of Cost Estimate of Individual Household Latrine with GCI Sheet Wall, Roof & Door and Double leach pit of circular ferro-cement/ concrete rings.

Sl. No.	Description of Item	Quantity	Unit	Rate (Rs.)	Amount (Rs.)
1	1st Class Bricks	85.00	Each	8.50	722.50
2	Cement (Reputed brand with ISI mark)	3.00	Bag	370.00	1110.00
3	1/2" Stone-Chips	5.00	C.ft.	43.00	215.00
1	Sand (Coarse)	15.00	C.ft.	32.00	480.00
2	Steel (using B mm rod) for 2 pit covers	2.50	kg	55.00	137.50
3	Jhama bats (PWD SOR-Wage for Breaking)	3.00	C.ft.	40.00	120.00
4	GCI sheet (of thickness 0.18 mm) for door of height 5'-0" (cutting piece from sheet of full height 10'-0"; 7 pieces in bundle @ Rs. 2,100/-)	1.00	Piece	475.00	475.00
5	GCI sheet (of thickness 0.25 mm) for roof & wall of height 5'-0" & width 2'-8" 9cutting piece from sheet of height 10'-0"; 7 pieces in bundle @Rs. 2,450/-)	3.00	Piece	535.00	1605.00
6	PVC pipe (4" dia, 2'-0" long) with 'Y' junction	1.00	Set	200.00	200.00
7	Washer, Nut-bolt, Black anneated wire (for binding GI wire of ferro cement rings used), Hinges, Sikols P sheet etc.	LS	LS	LS	100.00
8	Ceramic rural pan / trap with foot rest	1.00	Set	500.00	500.00
9	Double leach pit lining with circular ferro-cement/ concrete rings in each pit	1.00	Set	LS	1000.00
10	Timber batten for door and roof (local heart wood)	LS	LS	LS	500.00
11	Display Board	LS	LS	LS	100.00
12	Transportation cost of all Materials	LS	LS	LS	400.00
13	Skilled labour for Masonary work	4.00	MD	326.00	1304.00
14	Supervisor (to be engaged for every 6 IHHL's vide Memo No. 301 (20)/Comm-P & RD/P/NREGA/10E-01/06 (part-I) dated 08.10.2013 of P & RDD, Government of West Bengal.	0.20	MD	300.00	60.00
15	Un-skilled labour for masonary work	8.00	MD	245.00	1960.00
GRAND TOTAL = RS.					10989.00
SAY = RS.					10989.00
(Rupees Ten Thousand Nine Hundred & Eighty Nine Only)					
NB:- This estimate is prepared on the basis of PWD (WB) Schedule of Rates for building works (effective from 01st July, 2014) and Local justified marked rate:					

[Signature]
27/12/15

[Signature]
23/11/15

[Signature]

Encl. 2

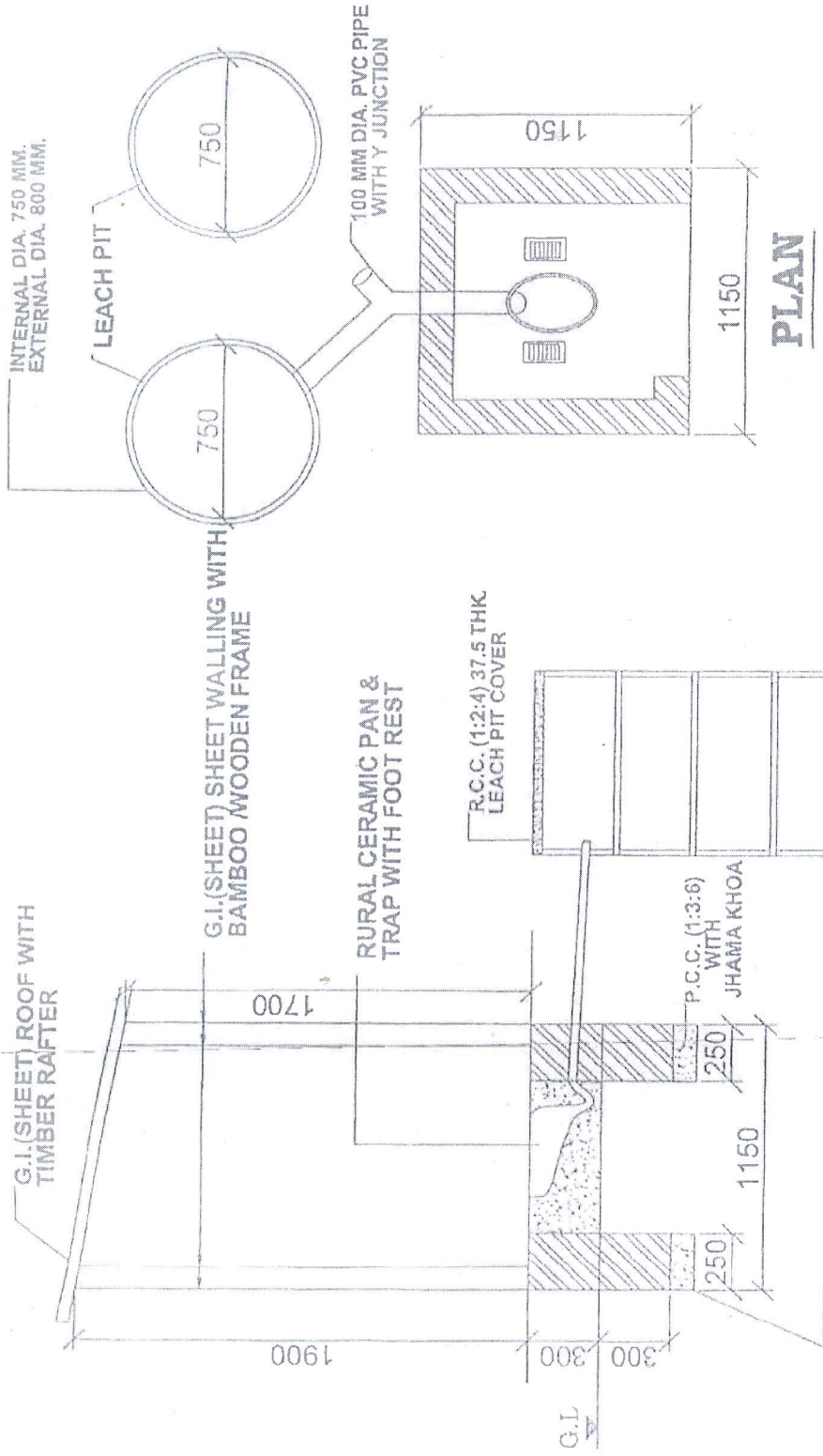

রাজ্য নগর উন্নয়ন সংস্থা

STATE URBAN DEVELOPMENT AGENCY

“ইলগাস ভবন”, এইচ-সি ব্লক, সেক্টর-৩, বিধাননগর, কলকাতা-৭০০ ১০৬, পশ্চিমবঙ্গ

“ILGUS BHAVAN”, H-C Block, Sector - III, Bidhannagar, Kolkata - 700 106, West Bengal

ক্রমিক নং SUDA-37/2015/Pt-3/177

তারিখ 26.04.2017

From: Finance Officer, SUDA

To: 1) Additional District Magistrate, Murshidabad

MEMORANDUM

Sub: Release of fund to District Magistrate, Murshidabad for construction of IHHL with the objective of declaring the ULBs in the District ODF under SBM

Madam/Sir,

In continuation Murshidabad vide Memo No. 42/Con (G) dated 10.04.2017 amounts shown in here under statement are being released in favour of Additional District Magistrate, Murshidabad for construction of IHHL in the ULBs of the Districts. The amounts released represent the central and matching state shares as well as the Additional state shares.

The District Administration is requested to place appropriate funds at the disposal of the ULBs to enable them to continue the pace of construction of IHHL.

Sl. No.	District	Central Share	Matching State Share	Addt. State Share	Total (Rs. In lakh)	Name of Payee	Bank Details
1	Murshidabad	1267.20	422.40	841.63	2531.23	TSC-MZP	IDBI Bank Ltd, Berhampore Branch, A/C No:- 0257104000118507 IFS Code:- IBKL0000257
	Grand Total	1267.20	422.40	841.63	2531.23		

Yours faithfully,

Encl: As stated



Finance Officer, SUDA.

দূরভাষ : ২৩৫৮ ৬৪০৩ / ৫৭৬৭, ফ্যাক্স : ২৩৫৮ ৫৮০০

Tel : 2358 6403/5767, Fax : 2358 5800, E-mail : wbsudadir@gmail.com

Account Section : 2358 6408

In this connection kindly find enclosed herewith the provisional number of IHHL units to be constructed in the Urban Local Bodies of the District ULB wise as per findings of the comprehensive house to house survey for identification of insanitary latrine/no latrine facilities. However the actual number will be as per field executions. The model plan for the latrine unit as prepared by Municipal Engineering Directorate at an estimated cost of Rs. 10,990/- has been decided to be adopted in the program. A copy of plan and estimate of the model design of the latrine is enclosed herewith. The implementation of the program may be undertaken under the overall co-ordination of the District Magistrates and the respective ULBs. The work may be executed preferably through sanitary mart or such other self-help groups (as was done in the case of Nadia) or through the ULBs or otherwise as may be decided by the respective District Administration.

It is further informed that the progress of construction of IHHL starting from applications by the beneficiaries to completion of the units are required to be uploaded in the Govt. of India's portal under SBM. The uploading may be done by CSC e-Governance Services India Ltd. (a special purpose vehicle company constituted by Dept. of Information Technology, Govt. of India and entrusted to look after the CSC scheme across the country) or by the respective ULBs.

The District Administrations will also be required to identify the households where there is no suitable space for construction of IHHL. On receiving a feedback from the Districts proposals for construction of Community Toilets in close proximity of the identified households will be prepared and submitted to the MA Dept. for reference to Finance Department for the required additional State share. Simultaneously the concerned ULBs will be required to identify suitable lands for construction of Community Toilets.

It has further been decided that the following fund sharing pattern will be adopted in implementation of the program:

GOI share	:	Rs. 4000
Matching State share	:	Rs. 1333
ULB contribution	:	Rs. 2000
Beneficiary's contribution	:	Rs. 1000
Additional State share	:	Rs. 2657
Total		Rs. 10,990

Commitments from the ULBs should be obtained by the District Magistrates regarding payment of ULBs share and beneficiary's share.

R. M. 04.18

The release of fund is also subject to the following conditions:

- 1) The fund should be utilized only for the purpose for which it is released and for no other purpose.
- 2) Works for the released amount should be executed strictly as per scheme Guidelines.
- 3) Monthly report of Physical and Financial progress should be sent to SUDA and MED by the 7th of the following month.
- 4) The amount released herein should be kept in the dedicated Bank Account for SBM maintained by the ULBs.
- 5) A subsidiary Cash Book should be maintained for keeping accounts (deposits and withdrawals) of funds.
- 6) Money receipt in Form 42 may be sent immediately after receipt of the online transfer.
- 7) Appropriate amounts should be sub allotted to the concerned ULBs.



Finance Officer, SUDA.

SUDA-37/2015 (pt.3)/177/1 (4)

26.04.2017

Copy Forwarded for kind information of:

1. Secretary, UD & MA Dept, Govt. of West Bengal.
2. Sri B.N.KAR, Addl. Dir. SBM and Addl. Dir. ILGUS.
3. Chief Engineer, M.E. Directorate.
4. Cashier, SUDA.

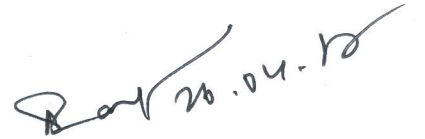

Finance Officer, SUDA.

Abstract of Cost Estimate of Individual Household Latrine with GCI Sheet Wall, Roof & Door and Double leach pit of circular ferro-cement/ concrete rings.

Sl. No.	Description of Item	Quantity	Unit	Rate (Rs.)	Amount (Rs.)
1	1st Class bricks	95.00	Each	8.50	722.50
2	Cement (Reputed brand with ISI mark)	3.00	Bag	379.00	1116.00
3	1 1/2" Stone Chips	5.00	C.ft	43.00	215.00
4	Sand (fine)	15.00	C.ft	32.00	480.00
5	Steel (using B threaded) for 2 pit covers	2.50	kg	55.00	137.50
6	Thana bats (PWD SDR-Wage for Breaking)	3.00	C.ft	40.00	120.00
7	GCI sheet (of thickness 0.16 mm) for door of height 5'-0" (cutting piece from sheet of full height 10'-0" comes in bundle @ Rs. 2,100/-)	1.00	Piece	475.00	475.00
8	GCI sheet (of thickness 0.25 mm) for roof & wall of height 5'-0" & width 2'-0" (cutting piece from sheet of height 10'-0" 7 pieces in bundle @ Rs. 2,350/-)	3.00	Piece	535.00	1605.00
9	PVC pipe (4" dia, 2'-0" long) with 'Y' junction	1.00	Set	200.00	200.00
10	Washer, Nut-bolt, Black annealed wire (for binding GCI wire in ferro cement rings used), Hinges, alkali-P sheet etc.	1.5	LS	LS	100.00
11	Ceramic (or) pan / tray with foot rest	1.00	Set	500.00	500.00
12	Double leach pit using with circular ferro-cement/ concrete rings in each pit	1.00	Set	LS	1000.00
13	Timber batten for door and roof (local heart wood)	1.5	LS	LS	500.00
14	Display Board	1.5	LS	LS	100.00
15	Transportation cost of all Materials	1.5	LS	LS	400.00
16	Skilled labour for masonry work	4.00	MD	326.00	1304.00
17	Supervisor (to be engaged for every 6 HNL's vide Memo No. 301 (20)/Comro-P & RD/P/NRECA/186-01/06 (part I) dated 08.10.2013 of P & RDD, Government of West Bengal.	0.20	MD	300.00	60.00
18	Un-skilled labour for masonry work	8.00	MD	245.00	1960.00
GRAND TOTAL = RS.					10989.00
SAY = RS.					10989.00

(Rupees Ten Thousand Nine Hundred & Eighty Nine Only)

Note: This estimate is prepared on the basis of PWD (WB) schedule of rates for building works (effective from 01st July, 2014) and local justified market rate.

[Handwritten signature]

[Handwritten signature]

[Handwritten mark]

FIG. 1

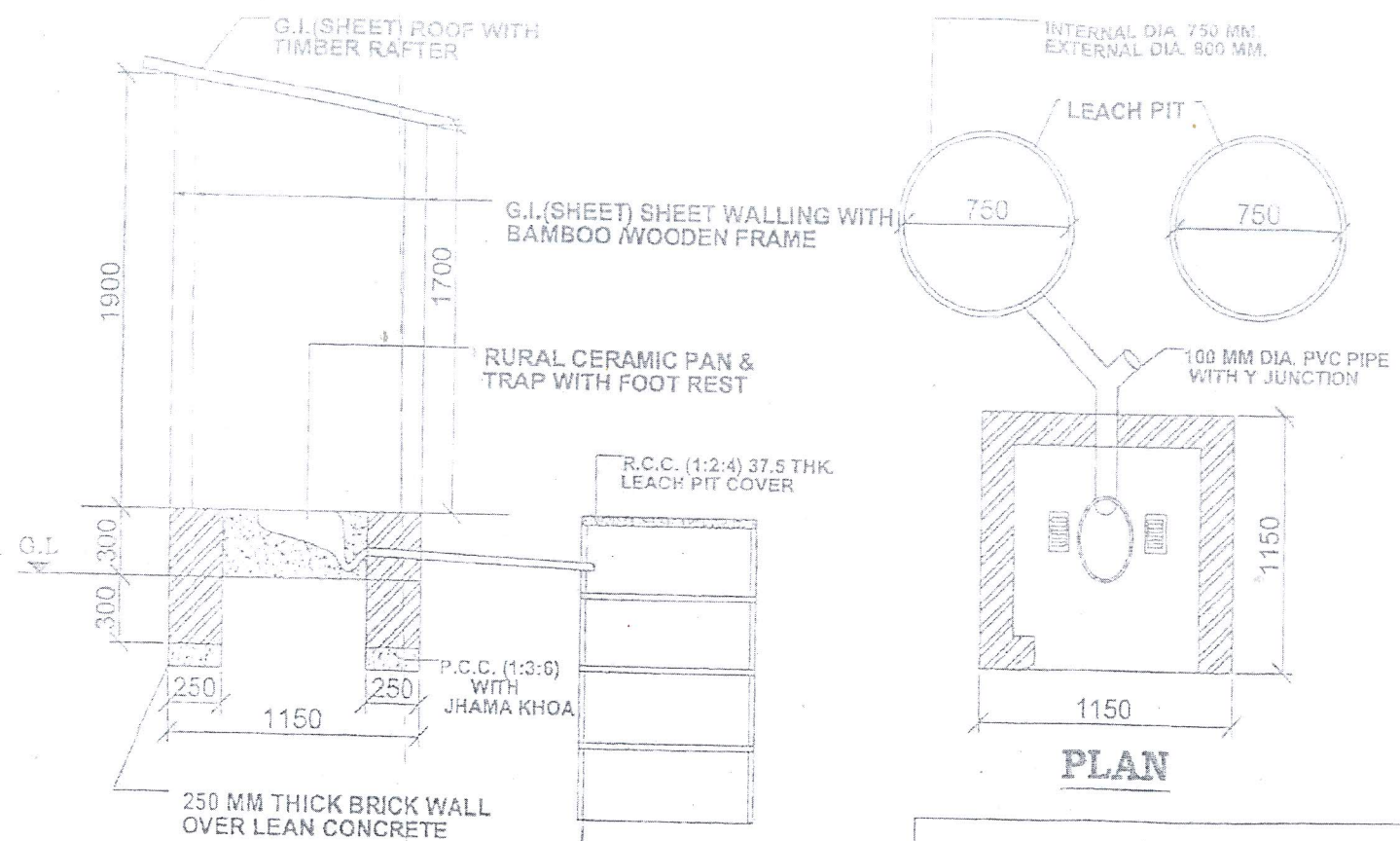

SEC. ELEVATION

PLAN

**OFF- THE PIT TOILET (DOUBLE PIT)
WITH G.I.(SHEET) SHEET WALL & ROOF**

All Dimension are in mm.
DRAWING ARE NOT TO SCALE

রাজ্য নগর উন্নয়ন সংস্থা

STATE URBAN DEVELOPMENT AGENCY

“ইলগাস ভবন”, এইচ-সি ব্লক, সেক্টর-৩, বিধাননগর, কলকাতা-৭০০ ১০৬, পশ্চিমবঙ্গ

“ILGUS BHAVAN”, H-C Block, Sector - III, Bidhannagar, Kolkata - 700 106, West Bengal

SUDA-229/2017/ 148

24.04.2017

ক্রমিক নং

তারিখ

**From: Addl. Director
& Financial Advisor, SUDA**

**To: The District Magistrate,
North 24 Parganas**

MEMORANDUM

Sub: Release of funds to District Magistrate, North 24 Parganas for intensive IEC activities under Swachh Bharat Mission

Madam/Sir,

I am to invite a reference to the above subject and to state that funds as stated herein below are being released to District Magistrate, North 24 Parganas District for undertaking IEC activities under Swachh Bharat Mission.

sl	Name of Payee	Amount in Rs.	Bank Details
01	North 24 Parganas Zilla Parishad	20,00,000.00	UCO Bank, Barasat Branch, A/C No: - 06550100008681, IFS code: - UCBA0000655.

Under public Awareness and IEC, the activities the District Administration can undertake include:

- Town level public Awareness workshop for sensitizing people
- Banners and hoardings at appropriate locations
- Leaflets for distribution on SBM objectives
- Quiz competition in schools and colleges
- Programs involving senior citizens
- Road shows and Tablo
- Advertisement in local cable Tv channel
- Advertisement in local print media
- Innovative mechanism encouraging use of toilets and discouraging open defecation
- Workshops for sanitary marts
- School children awareness events
- Folk group sensitization events
- Technology sensitization session for Municipal Engineers
- Activities under Theme Based Cleanliness drive

দূরভাষ : ২৩৫৮ ৬৪০৩ / ৫৭৬৭, ফ্যাক্স : ২৩৫৮ ৫৮০০

Tel : 2358 6403/5767, Fax : 2358 5800, E-mail : wbsudadir@gmail.com

Account Section : 2358 6408

The release is also subject to the following conditions:

- 1) The fund should be utilized only for the purpose for which it is released and for no other purpose.
- 2) Works for the released amount should be executed strictly as per scheme Guidelines.
- 3) Monthly report of Physical and Financial progress should be sent to SUDA and MED by the 7th of the following month.
- 4) The amount released herein should be kept in the dedicated Bank Account for SBM maintained by the ULB.
- 5) A subsidiary Cash Book should be maintained for keeping accounts (Deposits and Withdrawals) of funds.
- 6) Money receipt Form 42 may be sent immediately after receipt of the online transfer.



Additional Director &
Financial Advisor, SUDA.

Date: 24.04.2017

SUDA-229/2017/ 148/1 (4)

Copy forwarded for information to:

- 1) Secretary, UD & MA Department, Government of West Bengal
- 2) Director, SUDA.
- 3) Chief Engineer, ME Directorate
- 4) Additional M.D, SBM.



Additional Director &
Financial Advisor, SUDA.

ক্রমিক নং SUDA- ৭১/২০১৬(পা-১)/ ৪৩

তারিখ ১৭.০৪.২০১৭

From: Additional Director &
Financial Advisor, SUDA

To: 1) Additional District Magistrate, Bankura

MEMORANDUM

Sub: Release of fund for construction of IHHL with the objective of declaring the ULBs in the District ODF under SBM

Madam/Sir,

In continuation Bankura Zilla Parishad vide Memo No. 845/ZP/2017 dated 30.03.2017 amounts shown in here under statement are being released in favour of the Bankura Zilla Parishad (TSC) for construction of IHHL in the ULBs of the Districts. The amounts released represent the central and matching state shares as well as the Additional state shares.

The District Administration is requested to place appropriate funds at the disposal of the ULBs to enable them to continue the pace of construction of IHHL.

Sl. No.	District	Central Share	Marching State Share	Addt. State Share	Total (Rs. In lakh)	Name of Payee	Bank Details
1	Bankura	691.04	230.35	483.08	1404.47	Bankura Zilla Parishad (TSC)	State Bank Of India, Bankura Branch, A/C No:- 11110258046 IFS Code:- SBIN0000022
	Grand Total	691.04	230.35	483.08	1404.47		

Yours faithfully,

Encl: As stated

Additional Director &
Financial Advisor, SUDA.

দূরভাষ : ২৩৫৮ ৬৪০৩ / ৫৭৬৭, ফ্যাক্স : ২৩৫৮ ৫৮০০

Tel : 2358 6403/5767, Fax : 2358 5800, E-mail : wbsudadir@gmail.com

Account Section : 2358 6408

In this connection kindly find the table prepage the provisional number of IHHL units to be constructed in the Urban Local Bodies of the District ULB wise as per findings of the comprehensive house to house survey for identification of insanitary latrine/no latrine facilities. However the actual number will be as per field executions. The model plan for the latrine unit as prepared by Municipal Engineering Directorate at an estimated cost of Rs. 10,990/- has been decided to be adopted in the program. A copy of plan and estimate of the model design of the latrine is enclosed herewith. The implementation of the program may be undertaken under the overall co-ordination of the District Magistrates and the respective ULBs. The work may be executed preferably through sanitary mart or such other self-help groups (as was done in the case of Nadia) or through the ULBs or otherwise as may be decided by the respective District Administration.

It is further informed that the progress of construction of IHHL starting from applications by the beneficiaries to completion of the units are required to be uploaded in the Govt. of India's portal under SBM. The uploading may be done by CSC e-Governance Services India Ltd. (a special purpose vehicle company constituted by Dept. of Information Technology, Govt. of India and entrusted to look after the CSC scheme across the country) or by the respective ULBs.

The District Administrations will also be required to identify the households where there is no suitable space for construction of IHHL. On receiving a feedback from the Districts proposals for construction of Community Toilets in close proximity of the identified households will be prepared and submitted to the UD & MA Dept. for reference to Finance Department for the required additional State share. Simultaneously the concerned ULBs will be required to identify suitable lands for construction of Community Toilets.

It has further been decided that the following fund sharing pattern will be adopted in implementation of the program.

GOI share	:	Rs. 4000
Matching State share	:	Rs. 1333
ULB contribution	:	Rs. 2000
Beneficiary's contribution	:	Rs. 1000
Additional State share	:	Rs. 2657
Total		Rs. 10,990

Commitments from the ULBs should be obtained by the District Magistrates regarding payment of ULBs share and beneficiary's share.

The release of fund is also subject to the following conditions:

- 1) The fund should be utilized only for the purpose for which it is released and for no other purpose.
- 2) Works for the released amount should be executed strictly as per scheme Guidelines.
- 3) Monthly report of Physical and Financial progress should be sent to SUDA and MED by the 7th of the following month.
- 4) The amount released herein should be kept in the dedicated Bank Account for SBM maintained by the ULBs.
- 5) A subsidiary Cash Book should be maintained for keeping accounts (deposits and withdrawals) of funds.
- 6) Money receipt in Form 42 may be sent immediately after receipt of the online transfer.
- 7) Appropriate amounts should be sub allotted to the concerned ULBs.



**Additional Director
& Financial Advisor, SUDA.**

SUDA-91/2016 (pt.1) / 83/1 (4)

17.04.2017

Copy Forwarded for kind information of:

1. Secretary, UD & MA Dept, Govt. of West Bengal.
2. Sri B.N.KAR, Addl. Dir. SBM and Addl. Dir. ILGUS.
3. Chief Engineer, M.E. Directorate.
4. Cashier, SUDA.



**Additional Director
& Financial Advisor, SUDA.**



Abstract of Cost Estimate of Individual Household Latrine with GCI Sheet Wall, Roof & Door and Double leach pit of circular ferro-cement/ concrete rings.

Sr. No.	Description of Item	Quantity	Unit	Rate (Rs.)	Amount (Rs.)
1	1st Class bricks	65.00	Each	8.50	722.50
2	Cement (Reputed brand with ISI mark)	3.00	Bag	370.00	1110.00
3	1 1/2" stone chips	5.00	C.ft	43.00	215.00
4	Sand (Coarse)	15.00	C.ft	32.00	480.00
5	Steel (using 8 mm rod) for 2 pit covers	2.50	kg	55.00	137.50
6	Jhama bats (PWD COR-Wage for Breaking)	3.00	C.ft	40.00	120.00
7	GCI sheet (of thickness 0.10 mm) for door of height 3'-0" (cutting piece from sheet of full height 10'-0", 3 pieces in bundle @ Rs. 2,100/-)	1.00	Piece	475.00	475.00
8	GCI sheet (of thickness 0.25 mm) for roof & wall of height 5'-0" & width 2'-0" (cutting piece from sheet of height 10'-0", 7 pieces in bundle @Rs. 2,450/-)	3.00	Piece	535.00	1605.00
9	PVC pipe (4" dia, 2'-0" long) with 'Y' junction	1.00	Set	200.00	200.00
10	Washer, Nut-bolt, Black annealed wire (for binding of wire of ferro cement rings used), Hinges, Sikols P sheet etc.	LS	LS	LS	100.00
11	Decorational pan / trap with foot rest	1.00	Set	500.00	500.00
12	Double leach pit lining with circular ferro-cement/ concrete rings in each pit	1.00	Set	LS	1000.00
13	Timber batten for door and roof (local heart wood)	LS	LS	LS	500.00
14	Display Board	LS	LS	LS	100.00
15	Transportation cost of all Materials	LS	LS	LS	400.00
16	Skilled labour for Masonary work	4.00	MD	326.00	1304.00
17	Supervisor (to be engaged for every 5 HHLL's vide Memo No. 301 (20)/Comm-P & RD/P/NREGA/105-01/06 (part-I) dated 08.10.2013 of P & RD, Government of West Bengal.	0.20	MD	300.00	60.00
18	Un skilled labour for masonary work	8.00	MD	245.00	1960.00

GRAND TOTAL = RS. 10989.00

SAY = RS. 10989.00

(Rupees Ten Thousand Nine Hundred & Eighty Nine Only)

Note:- This estimate is prepared on the basis of PWD (WB) Schedule of rates for building works (effective from 01st July, 2014) and fixed justified market rate.

[Handwritten signatures and initials are present at the bottom of the page, including a large signature on the left and another on the right.]

Eng. 2

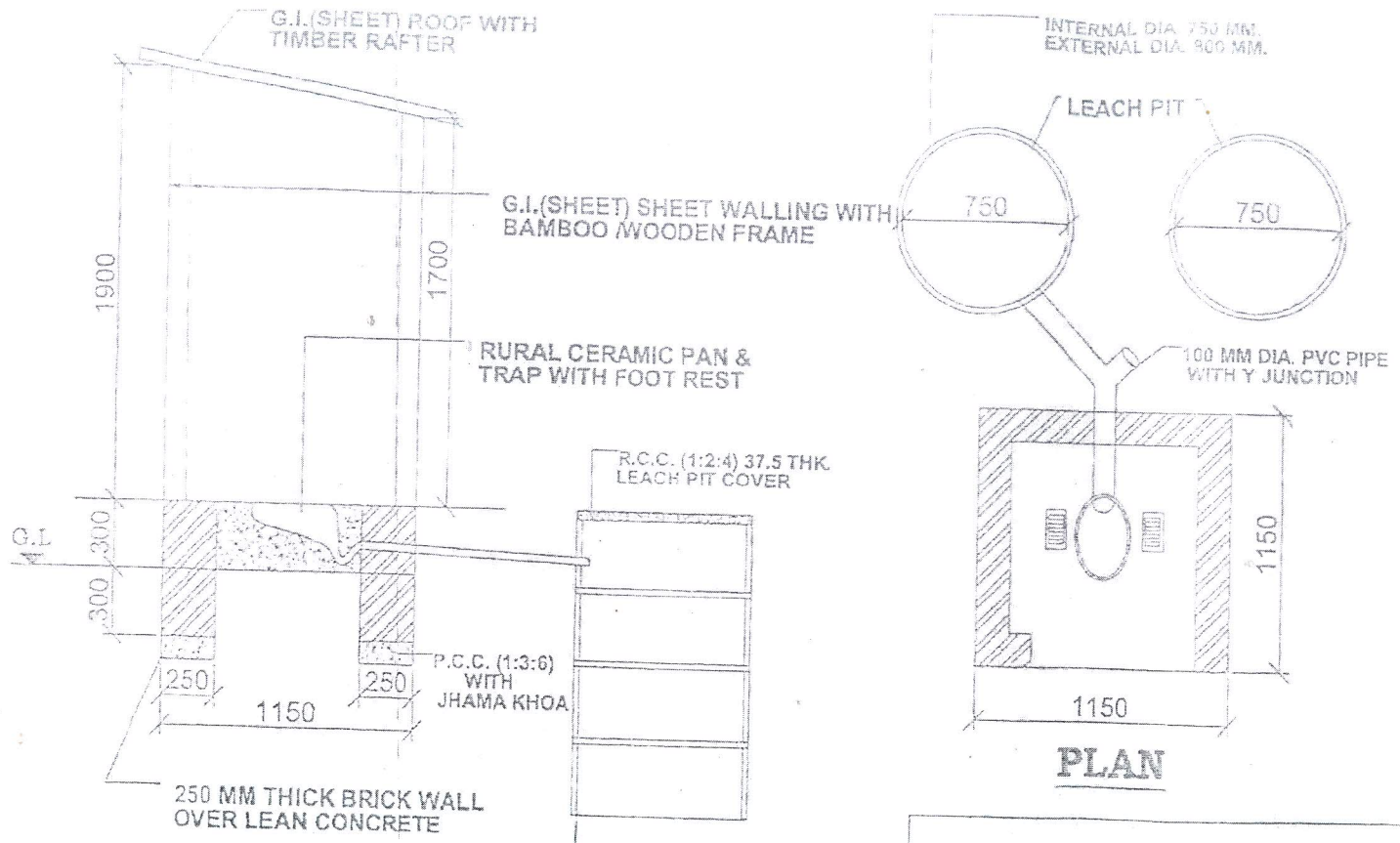

SEC. ELEVATION

PLAN

**OFF- THE PIT TOILET (DOUBLE PIT)
WITH G.I.(SHEET) SHEET WALL & ROOF**

All Dimension are in mm.
DRAWING ARE NOT TO SCALE

Handwritten notes and signatures in the bottom left corner.

Handwritten notes and signatures in the bottom center.